

FITG219CRHA HEIGHT ADJUSTER CONVERSION KIT

HEIGHT ADJUSTER CONVERSION KIT FOR 219 WALL MOUNTED UP FOLD BACKSTOP WITH RECTANGULAR BACKBOARD.

ITEM NO.	PART NUMBER	DESCRIPTION	QTY.
1	HDWE011540E0	Hex Bolt 1/2-13 x 1.25 Zinc Plated GR 5	2
2	HDWE020790E0	3/8" X 4Lg. Carriage Bolt Grade 5	4
3	HDWE030020E0	Hex Nut - 3/8"-16	4
4	HDWE030030E0	Hex Nut 1/2-13	10
5	HDWE040020E0	Lockwasher - 3/8 Heavy	4
6	HDWE040030E0	1/2" Lock Washer	10
7	HDWE050040E0	3/8" Flatwasher	4
8	ANGL00190002	Mounting Angle - 9" Lg.	1
9	PCAP00014002	2 3/8" Pipe Cap- Black	4
10	TUBR23710904600	2 3/8 12 GA Tube 04 FT 6 IN Lg.	2
11	TUBS00190	Span Tube Line H/A	2
12	UBOT00026	2-3/8" DIA U-BOLT 1/2-13 X 5-1/4"	4
13	XHNG201LP102	2 3/8 tube to 1 7/8 Hinge hanger LONG	2
14	XHNG51300002	2 3/8 Tube to 1 7/8 Hinge Parallel Hanger	2

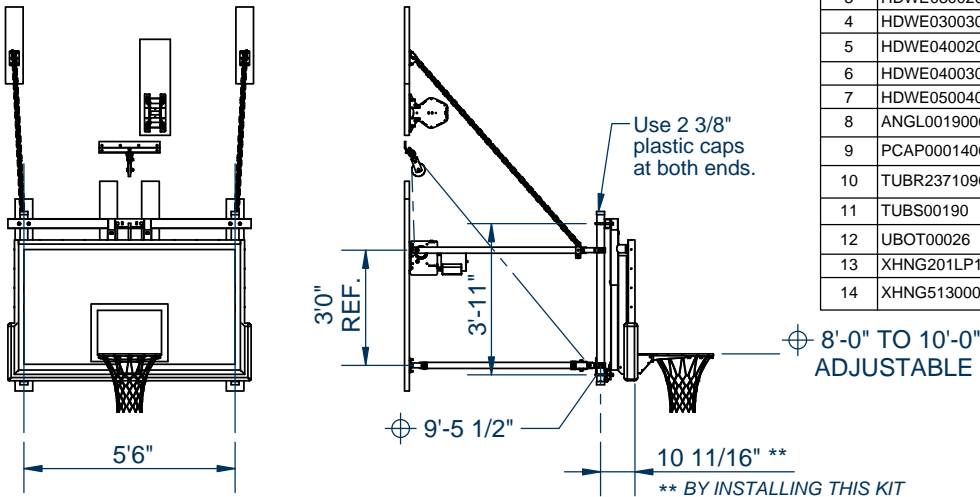

** BY INSTALLING THIS KIT & H/A, THE F.O.B. TO WALL WILL INCREASE BY 9 5/8".

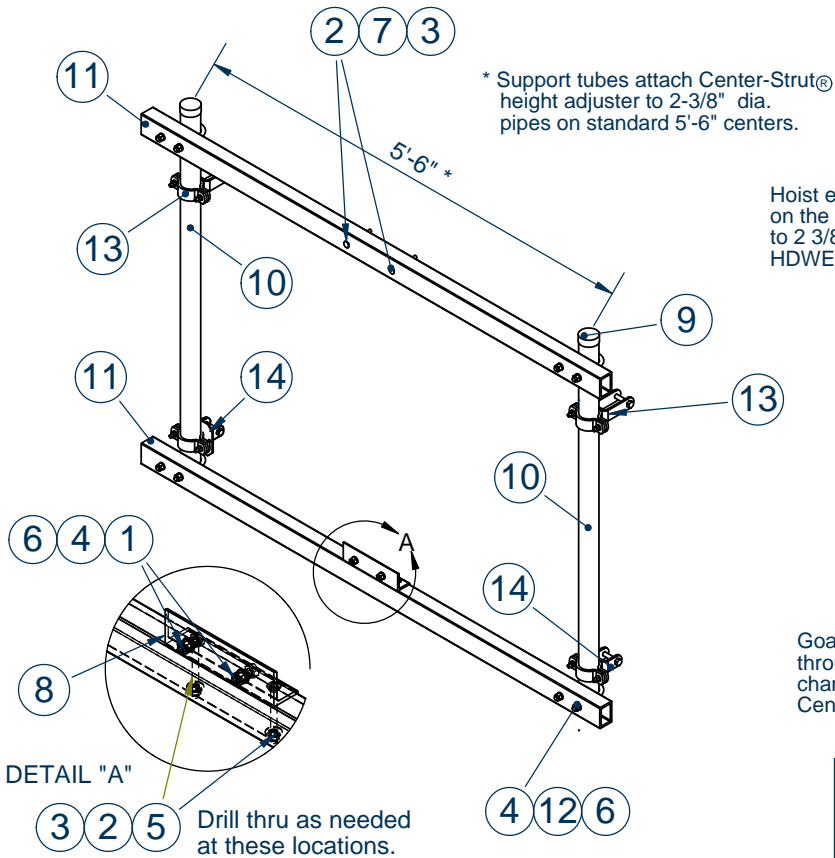

Hoist entire H/A assembly into position on the span tubes (TUBS00190). Secure to 2 3/8" O.D. tubes with the U-bolts and HDWE provided.

Winch, Saf-strap and attachments not included.

Goal Mount HDWE extends through backboard and center channel to provide direct-mount Center-Strut® feature.

POWDER-COATED FINISH

COLOR : CHOOSE ONE

- | | | |
|----------------|----------------|---------------------|
| 16 FLAT BLACK | 13 NAVY BLUE | 11 PURPLE |
| 17 FLAT WHITE | 02 ROYAL BLUE | 09 GRAY |
| 12 GLOSS BLACK | 01 LIGHT BLUE | 07 SILVER |
| 04 GLOSS WHITE | 06 YELLOW GOLD | 10 MAROON |
| 15 DARK GREEN | 08 OLD GOLD | 03 RED |
| 14 KELLY GREEN | 05 ORANGE | 99 CUSTOM (SPECIFY) |

THIS KIT **DOES NOT** INCLUDE HEIGHT ADJUSTMENT SYSTEM. HEIGHT ADJUSTMENT SYSTEM FOR RECTANGULAR BACKBOARD NEEDS TO BE ORDERED SEPARATELY.

FITG219CRHA HEIGHT ADJUSTER CONVERSION KIT

HEIGHT ADJUSTER CONVERSION KIT FOR 219 WALL MOUNTED UP FOLD BACKSTOP
WITH RECTANGULAR BACKBOARDS

FITTING GUIDE

Height Adjuster Conversion Kit (FITG219CRHA) is designed for use with Porter's 00219-000 wall mounted up fold backstop and Porter's Height Adjustment Systems for rectangular backboard style No. 00208-000, 00204-000, 00206-000, 00228-000. This kit might also be used with similar up-fold wall mounted units. Porter cannot guarantee that this conversion kit will work with competitors' backstops or phased-out Porter units. Please refer to W-219-R12 cut-sheet as a reference for dimensions.

Conversion Kit, including height adjuster will add 200 lbs. Adequate blocking or bracing shall be designed and provided by others.

INSTRUCTIONS

Unpack height adjustment conversion kit and check all items against Parts Lists to ensure all parts and hardware are available to complete the installation.

Remove the (4) existing hinge plates and replace them with (4) parallel hangers provided. Use the (2) long hinge hangers at the higher level. Secure hinge hangers to the 2-3/8" O.D. drop pipes.

Secure the span tubes to the 2-3/8" O.D. drop pipes with the U-bolts and hardware provided with the height adjustment conversion kit to the hinge hangers.

Lay the back board face down on the floor (using the carton to protect the face of the backboard) directly below the backstop support system where it is to be installed.

Lay the assembled height adjustment unit* on the backside of the backboard with the attachment holes in alignment with the attachment inserts or slots on the backboard. Secure the upper backboard extension to the backboard with the necessary hardware.

Hoist entire height adjustment assembly* into position on the span tubes. Use the 9" mounting angle at the bottom section. (See Detail "A")

Attach goal to backboard and height adjustment Center-Strut® with hardware provided with the goal. Check goal with level before tightening the four bolts.

With the height adjustment unit raised to its highest position (bottomed out on the upper span tube), check the 10'-0" goal height. Move height adjustment unit up or down on the 2-3/8" O.D. drop tubes as required to acquire the 10'-0" goal height.

Check height adjustment operation – Move unit down to the 8'-0" goal height, then back up to 10'-0"

* THIS KIT **DOES NOT** INCLUDE HEIGHT ADJUSTMENT SYSTEM. HEIGHT ADJUSTMENT SYSTEM FOR RECTANGULAR BACKBOARD NEEDS TO BE ORDERED SEPARATELY.

ISSUED DECEMBER 02, 2014, SUBJECT TO CURRENT MANUFACTURING PROCEDURES AND CHANGES

COPYRIGHT 2014 - PORTER ATHLETIC - ALL RIGHTS RESERVED
PORTER@PORTERATHLETIC.COM