

234A - FAN ALUMINUM BACKBOARD

CAST ALUMINUM FAN BACKBOARD

HEXAGON CAVITY PROVIDED TO
INDEPENDENTLY MOUNT BACKBOARD TO
A CENTER-STRUT SUPPORT STRUCTURE
WHEN GOAL REMOVAL IS DESIRABLE

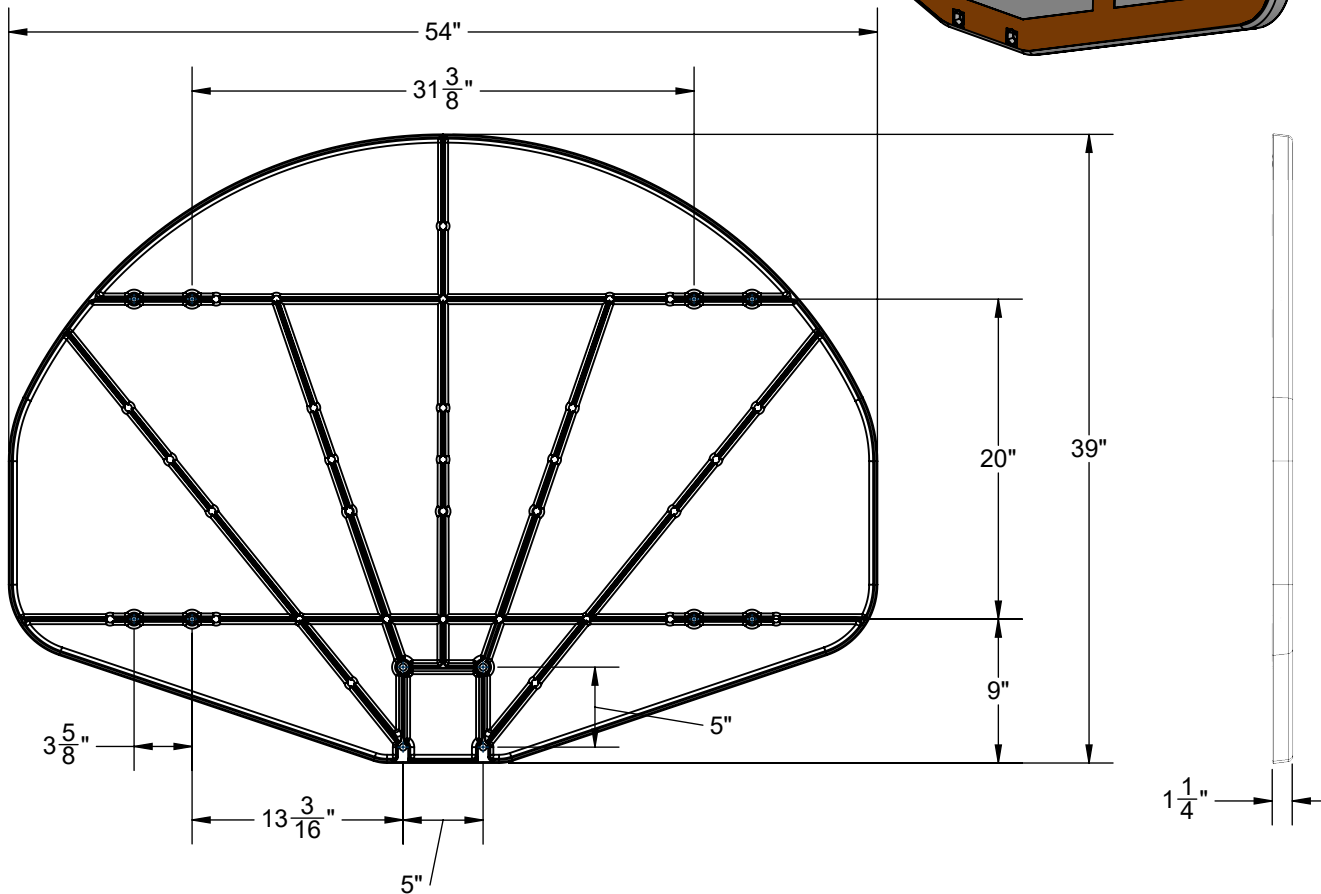
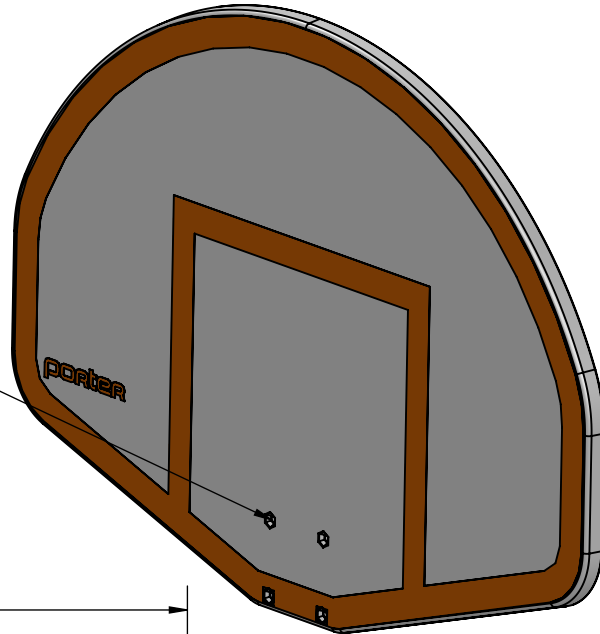

_____ - 234A CAST ALUMINUM BACKBOARD; PAINTED WHITE W/ ORANGE STRIPING

SEE B-200 FOR GOAL AND PADDING OPTIONS

234A - FAN ALUMINUM BACKBOARD

CAST ALUMINUM FAN BACKBOARD

SPECIFICATIONS

Cast aluminum backboard shall be official size (54" x 39") and shape. Backboard shall be cast in a permanent mold process from high tensile #413 aluminum.

Backboard shall be cast with structural reinforcing ribs on backside with a heavy, 1-1/4" deep perimeter flange to provide maximum rigidity. Backside of backboard shall be furnished with eight (8) tapped holes (3/8-16) to fit normal mounting attachments without exposed bolt heads on front face of unit.

Backboard shall be drilled for a front mount type goal (5" x 5" hole pattern) and compatible with direct mount type support structures. Goal mounting holes (4) shall be molded with an integral, hex shaped cavity located on the front side of the backboard to independently mount the backboard to a rear support structure Center-Strut to provide the option of removing the goal for seasonal use or to prevent vandalism or unauthorized usage.

Backboard shall be painted in a white powder coat finish with orange striping.

WARRANTY

- 234A backboards protected by a limited lifetime warranty.