

# 2" SUPERSAFE 3-SIDED TAPERED PAD

Custom Rigid Back Tapered Pad

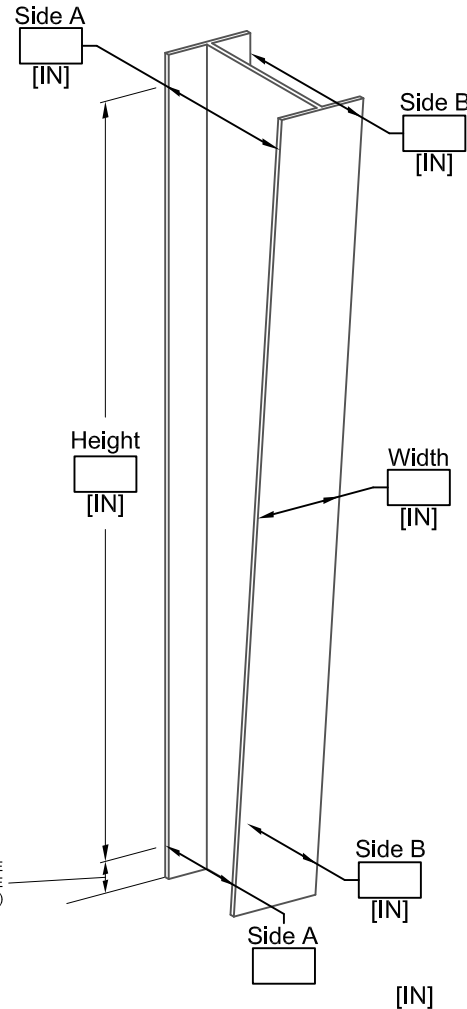
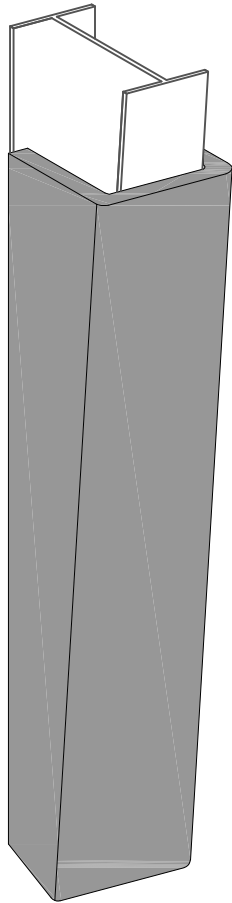

NAILING MARGINS?	
<input type="checkbox"/>	NONE
<input type="checkbox"/>	TOP & BOTTOM
<input type="checkbox"/>	TOP
<input type="checkbox"/>	BOTTOM

4" MAXIMUM ALLOWABLE DIMENSION TO MINIMIZE THE POSSIBILITY OF BODY CONTACT WITH THE WALL (Per ASTM Standard Specification F2440)

TOP UNFOLDED VIEW  
COLUMN PAD - ADD 3 SIDES AND 9.5" ALLOWANCE FOR CORNERS



## WARNING

This pad is provided to reduce the possibility of minor injuries. However, any activity involving motion and severe impacts may result in serious injuries, including but not limited to paralysis or death. No pad can guarantee the prevention of serious head or neck injuries that are due to a violent impact while participating in various sports activities.

## COLOR SELECTION

<input type="checkbox"/> 01 - Light Blue	<input type="checkbox"/> 09 - Gray
<input type="checkbox"/> 02 - Royal Blue	<input type="checkbox"/> 10 - Maroon
<input type="checkbox"/> 03 - Red	<input type="checkbox"/> 11 - Purple
<input type="checkbox"/> 04 - White	<input type="checkbox"/> 12 - Black
<input type="checkbox"/> 05 - Orange	<input type="checkbox"/> 13 - Navy Blue
<input type="checkbox"/> 06 - Yellow Gold	<input type="checkbox"/> 14 - Kelly Green
<input type="checkbox"/> 08 - Tan	<input type="checkbox"/> 15 - Dark Green

SELECT PAD:

\_\_\_ 90407048xx - 48" x 96" OR LESS 3-SIDED TAPERED PAD - RIGID BACK

Pad numbers are calculated by adding the lengths of each side and the corner allowances. Maximum total width is 48". Pads requiring more than this dimension must be split into two or more pads.

## Optional Additional Items to Specify

See Page No. G-343 for specification on Porter No. 343 and 344 Molded Inserts.

See Page No. G-347-3 for specification on Porter No. 347100, 347300 and 347400 Wall Attachment Fittings.

**Porter**<sup>®</sup>

888-277-7778 PORTER@PORTERATHLETIC.COM  
© COPYRIGHT 2017 PORTER ATHLETIC - ALL RIGHTS RESERVED

PROJECT NUMBER \_\_\_\_\_

PROJECT NAME \_\_\_\_\_

**Porter**<sup>®</sup>

WWW.PORTERATHLETIC.COM/FACILITY

WALL PAD SPECIFICATION SHEET

G-90407

7/14/2020

# 2" SUPERSAFE 3-SIDED TAPERED PAD

Custom Rigid Back Tapered Pad

## SPECIFICATIONS

PORTER No. 90407048xx - 2" SUPERSAFE 3-SIDED TAPERED PAD  
48"x96" - RIGID BACK (EACH)

Pads shall be fabricated to specified dimensions, with a "V" cut in filler and backing board as required, to facilitate installation and provide a neat, custom fit on exposed wall corners. Pads are three-sided (column), and tapered

Pads will be constructed of 2" fire retardent foam cemented to 7/16" backing board and covered with flame-retardant, vinyl-coated polyester folded and stapled securely to back of oriented strand board.

Panel shall meet the min. ASTM F2440 Standard Specification. Panels that have not been tested to this minimum standard shall not be considered as equal.

Entire pad assembly has been tested and meets the requirements of NFPA 101 Life Safety Code for Class A rating (flame spread 0-25, smoke development 0-450) when tested in accordance with ASTM E-84 (also published as NFPA-255, ANSI 2.5, UBC 8-1, and UL 723). Entire pad assembly has been tested and meets the criteria set forth in the 2003 IBC section 803.2.1 when tested in accordance with NFPA 286, NFPA does not publish pass/fail criteria.

Entire face of panel, including the 1" nailing margins, shall be upholstered in a heavy (19-oz.) fire-retardant, high tensile, vinyl-coated polyester fabric material. Cover material shall be designated as flame resistant in accordance with NFPA 701, and State of California. The cover material shall be mildew and rot resistant and fortified with an infection combating fungicide. Vinyl covering shall be folded and stapled securely to backside of oriented strand board. Vinyl covering is available in 14 colors - see color chart for options.

The installing contractor shall be responsible for proper inspection and installation of all pads. Attachment methods including but not limited to 1" nailing margins and/or "Z" clips supplied as specified. Installation shall be made in accordance with current factory suggested procedures.

### Certifications:

- ASTM F2440 Standard Specification for Indoor Wall/Feature Padding
- ASTM E-84 Class A Fire Rating
- NFPA 286

PORTER  
WWW.PORTERATHLETIC.COM/FACILITY

WALL PAD SPECIFICATION SHEET

G-90407