

# 9100710X - DUAL OUTPUT WINCH

1 HP ELECTRIC OPERATOR FOR DIVIDER CURTAINS

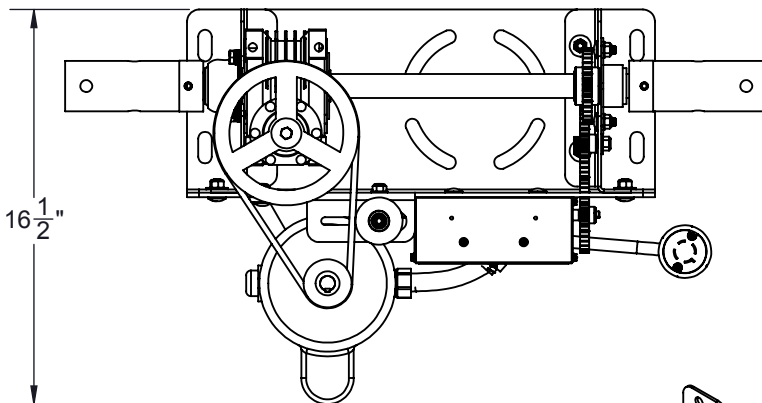
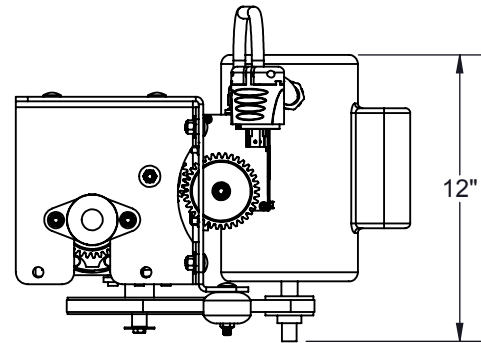
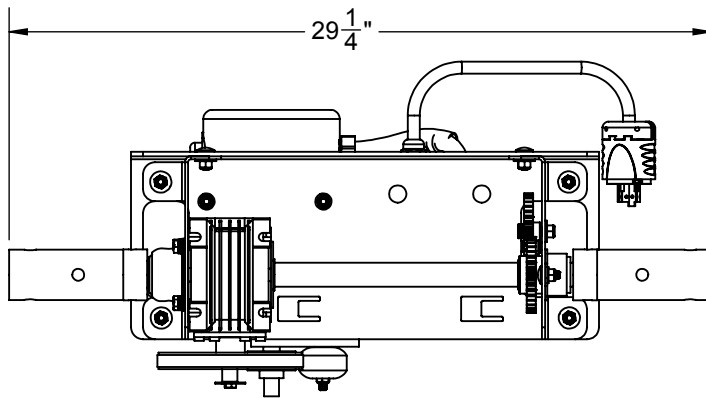

**WARNING**  
USE OF THIS OPERATOR ON PRODUCTS OTHER THAN PORTER GYMNASIUM DIVIDER CURTAINS AND BATTING CAGES IS **EXPRESSLY PROHIBITED**.

2 3/8" O.D. LINESHAFT OVER COUPLER.

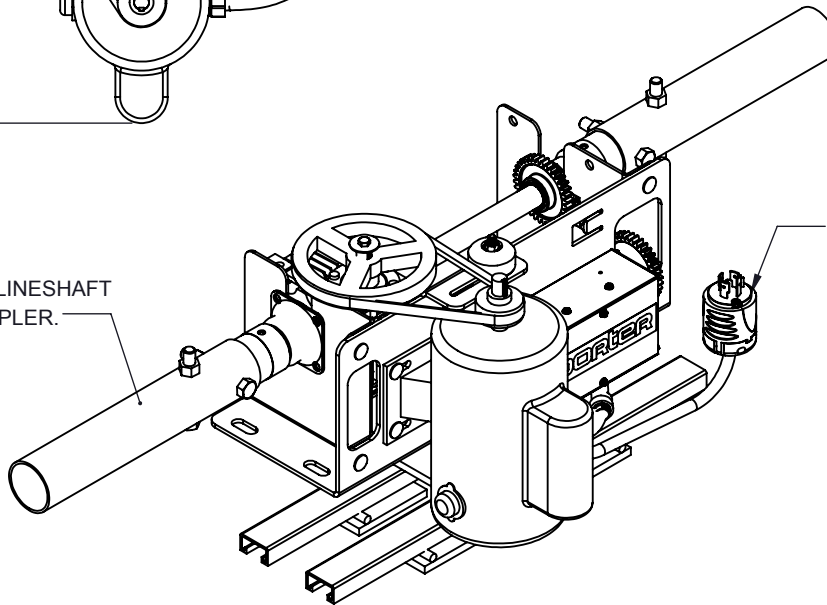

SJO CORD WITH TWIST-LOCK PLUG. PROVIDED WITH 4 POLE TWIST LOCK RECEPTACLE MOUNTED IN A 4" SQUARE JUNCTION BOX COVER. ELECTRICAL CONTRACTOR TO FURNISH A 4" SQUARE JUNCTION BOX WITHIN 3'-0" OF OPERATOR LOCATION.

INDICATE TYPE OF CONTROL FOR WINCH. SEE THE PAGES INDICATED BELOW FOR SPECIFICATIONS AND FIELD WIRING DETAILS FOR EACH CONTROL SYSTEM.

- ☐ See E-791 - KEY SWITCH CONTROL  
KEY SWITCH CONTROL PROVIDED AS STANDARD UNLESS OPTIONAL CONTROL SYSTEM (LISTED BELOW) IS SPECIFIED
- ☐ See E-2002 - SPORTSONIC® II RADIO CONTROL SYSTEM
- ☐ See E-2500 - POWR-TOUCH® 2.5 KEY PAD CONTROL SYSTEM
- ☐ See E-5000 - POWR-TOUCH® 5 REMOTE CONTROL SYSTEM

# 9100710X - DUAL OUTPUT WINCH

1 HP ELECTRIC OPERATOR FOR DIVIDER CURTAINS

## SPECIFICATIONS

### PORTER No. 9100710X - 1HP DUAL-OUTPUT ELECTRIC CURTAIN WINCH

Winch is worm gear type, designed to hold curtain at any position when raising or lowering. Winch frame is heavy gage painted steel.

The heat-dissipating gearbox contains a worm and gear set in a factory-filled oil bath which is completely sealed for maintenance free service. No additional braking is required.

Winch to be operated mechanically by means of a 1 hp (11.4 Amps, loaded) capacitor type 60 cycle, 115 Volt, single phase electric motor with automatic thermal overload protection manufactured to NEMA specifications. The motor is rated for a 15 minute duty cycle. The motor shall drive the winch by means of a connecting V-belt and pulleys. Belts and pulleys may vary based on required load.

Shaft shall be mechanically interconnected to an Up-Down limit switch assembly, which shall be mounted and pre-wired to motor as an integral part of the winch. Limit switch assembly shall be furnished in an extruded aluminum housing. For detailed limit setting instructions, refer to INST00179022. Winch shall be pre-wired with a 6'-0" long covered cable with NEMA L14-20 twist-lock grounded type plug attached.

Electric winches are available with an array of control options. See the reverse page to find more details of each option, and to make your controller selection.

Winch may be mounted in any orientation, provided there is proper alignment with the line shaft.

All conduit, wiring, junction boxes, and components not specified herein shall be furnished and installed by the electrical contractor. Wiring of all electrical components shall be in accordance with local codes, and in accordance with component manufacturer's instructions.

#### Warranty

Winches are provided with a 5 year limited warranty.