

WIRING DETAIL FOR THE 91105-100 (3 PHASE) MAT MOVER

ELECTRIC WINCH FIELD WIRING DETAILS & REQUIREMENTS

ELECTRICAL CONTRACTOR TO MOUNT
4" SQUARE x 2 1/2" DEEP JUNCTION
BOX WITHIN 3'-0" OF WINCH LOCATION

** The minimum wire size is dependent on the motor voltage, motor full-load amperage rating, and the total distance from the circuit breaker panel to the junction box. Consult **VOLTAGE DROP CALCULATION TABLES** to determine the minimum wire size.

** THREE PHASE
60 HERTZ
POWER SOURCE

MOTOR SPECIFICATIONS

1½ H.P.
THREE PHASE
1725 RPM
5.3 AMP @ 208V
5.0 AMP @ 220V
2.5 AMP @ 460V

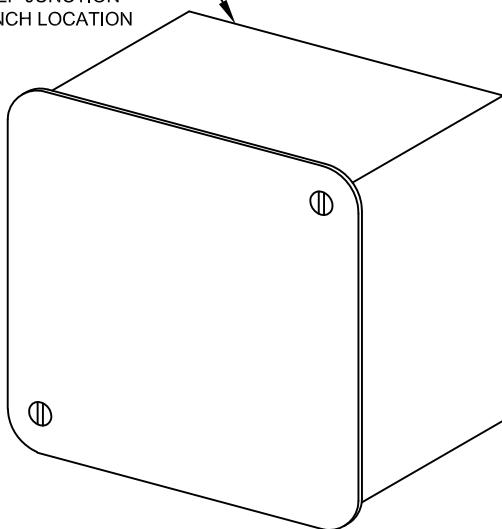

THREE-PHASE
POWER TO
JUNCTION BOX -
(4 WIRES)

L1A (POWER)
L2A (POWER)
L3A (POWER)
GROUND

CONTROL WIRES
TO JUNCTION BOX
- (3 WIRES)

JUNCTION BOX 3'-0" FROM WINCH LOCATION (BY OTHERS)

INDIVIDUAL KEY SWITCH MOUNTED IN A STANDARD 4½" SQUARE FLUSH-MOUNTED STAINLESS STEEL COVER PLATE FOR MOUNTING IN A 4" SQUARE x 3½" DEEP MASONRY BOX (RACO No. 696 OR EQUAL) BY ELECTRICAL CONTRACTOR. *

MOMENTARY KEY SWITCH FURNISHED WITH TWO KEYS (UP AND DOWN) TO PREVENT THE POSSIBILITY OF INSTANTANEOUS REVERSING OF THE WINCH, WHICH COULD RESULT IN OVERRIDING THE LIMIT SWITCHES, OR PLACING UNDUE STRESS ON HOIST SYSTEM. DO NOT SEPARATE KEYS FROM EACH OTHER.

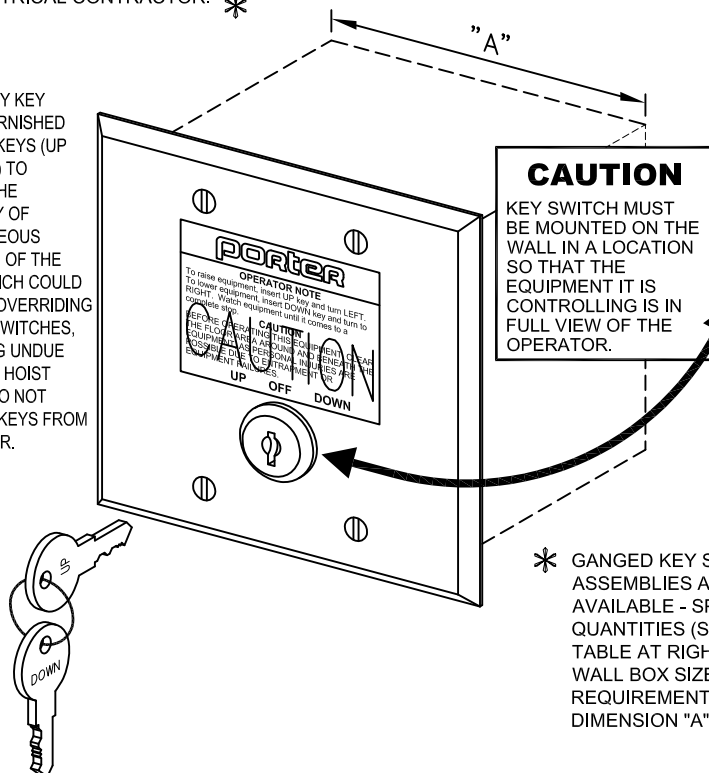

* GANGED KEY SWITCH ASSEMBLIES ARE AVAILABLE - SPECIFY QUANTITIES (SEE TABLE AT RIGHT FOR WALL BOX SIZE REQUIREMENTS - DIMENSION "A").

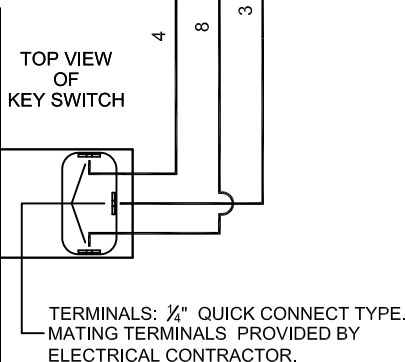

WIRING AT WALL MOUNTED KEY SWITCH

IMPORTANT NOTE - PERFORMANCE OF THIS WINCH IS BASED ON ___ VOLTS AT MOTOR TERMINALS. VOLTAGES LESS THAN ___ VOLTS WILL AFFECT HOISTING CAPACITY AND RESULT IN DAMAGE TO MOTOR, THUS VOIDING WARRANTY. **SUBSTITUTION** OF THIS KEY SWITCH WILL VOID ALL WARRANTIES AND WILL RENDER THE OPERATION OF MAT MOVERS UNSAFE.

KEY SWITCH QTY.	"A" BOX WIDTH	RACO MASONRY BOX No. (Or Equal)	RACO GANGABLE BOX No. (Or Equal)	
1	3¾"	696	592	Qty. 2
2	7⅞"	698	592	Qty. 4
3	11"	965	592	Qty. 6
4	14⅝"	N/A	592	Qty. 8
5	18¼"	N/A	592	Qty. 10
6	21⅞"	N/A	592	Qty. 12

Porter®

888-277-7778 PORTER@PORTERATHLETIC.COM
© COPYRIGHT 2014 PORTER ATHLETIC - ALL RIGHTS RESERVED

PROJECT NUMBER

PROJECT NAME