

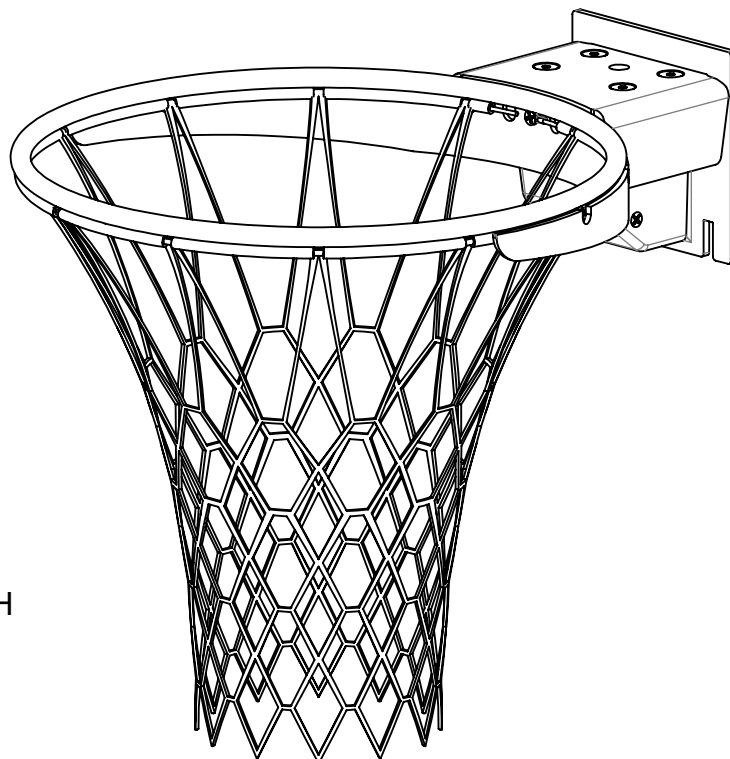

www.porterathletic.com
888-277-7778

260180

PORTER TORQ FLEX ELITE 180° FLEX GOAL GOAL INSTALLATION AND ADJUSTMENT INSTRUCTIONS



TOOLS NEEDED:

- 5/16" HEX KEY
- SOCKET WRENCH
- 1" SOCKET
- #2 PHILLIPS SCREWDRIVER
- ONE OF THE FOLLOWING:
 - 9/16" SOCKET
 - 9/16" CRESCENT WRENCH
 - ADJUSTABLE CRESCENT WRENCH

THIS GOAL UTILIZES A FULL 180° FLEX FEATURE TO DELIVER TOP PERFORMANCE FOR EVERY LEVEL OF BASKETBALL. FOLLOW THE INSTRUCTIONS PROVIDED IN THIS MANUAL TO ADJUST THE RIGIDITY OF THE RIM (AS CAN BE TESTED WITH PORTER'S FAIR-COURT SYSTEM® AND IS REQUIRED FOR NCAA DIVISION 1 LEVEL OF PLAY).

INSTALLATION

MOUNTING HARDWARE IS PROVIDED WITH THE GOAL. DUE TO THE GOAL'S UNIQUELY DESIGNED MOUNTING PLATE, MOUNTING HARDWARE CAN BE LOOSELY INSTALLED PRIOR TO MOUNTING OF THE GOAL TO SPEED UP THE INSTALLATION PROCESS. ONCE THE GOAL IS MOUNTED, ENSURE ALL HARDWARE IS SECURELY TIGHTENED DOWN BEFORE THE GOAL IS USED. FOLLOW THE MOUNTING DIAGRAM SHOWN ON THE NEXT PAGE.

PORTER TORQ FLEX ELITE 180° FLEX GOAL GOAL INSTALLATION AND ADJUSTMENT INSTRUCTIONS

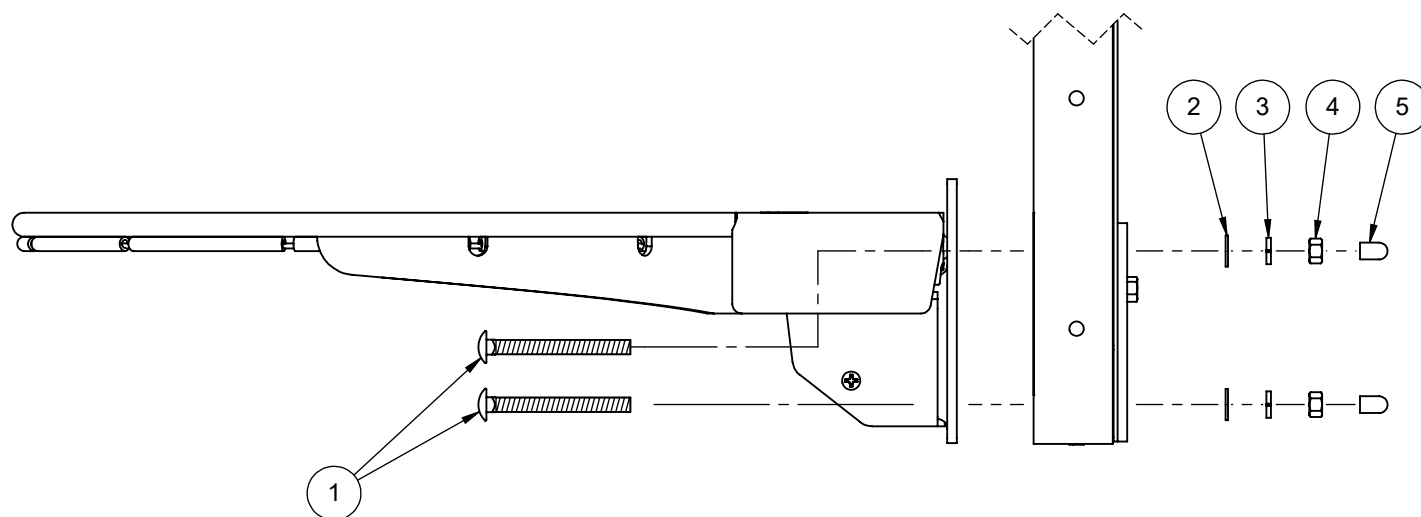

ITEM NO.	PART NUMBER	DESCRIPTION	QTY.
1	HDWE020790E0	CARRIAGE BOLT; 3/8"-16 X 3-3/4"; ZINC; GRADE 5	4
2	HDWE050040E0	FLAT WASHER; 3/8"; ZINC; USS	4
3	HDWE040020E0	LOCK WASHER; 3/8"; ZINC	4
4	HDWE030020E0	HEX NUT; 3/8"-16; ZINC	4
5	PCAP00040002	THREAD CAP; 3/8" X 1/2" LG	4

NOTE: IT IS RECOMMENDED THAT YOU DO NOT REMOVE THE (4) RIM ATTACHMENT BOLTS WHICH CONNECT THE RIM TO THE GOAL MECHANISM. IF REMOVAL AND REPLACEMENT IS NECESSARY, APPLY 242 BLUE LOCTITE TO THE BOLTS BEFORE REINSTALLING THEM.

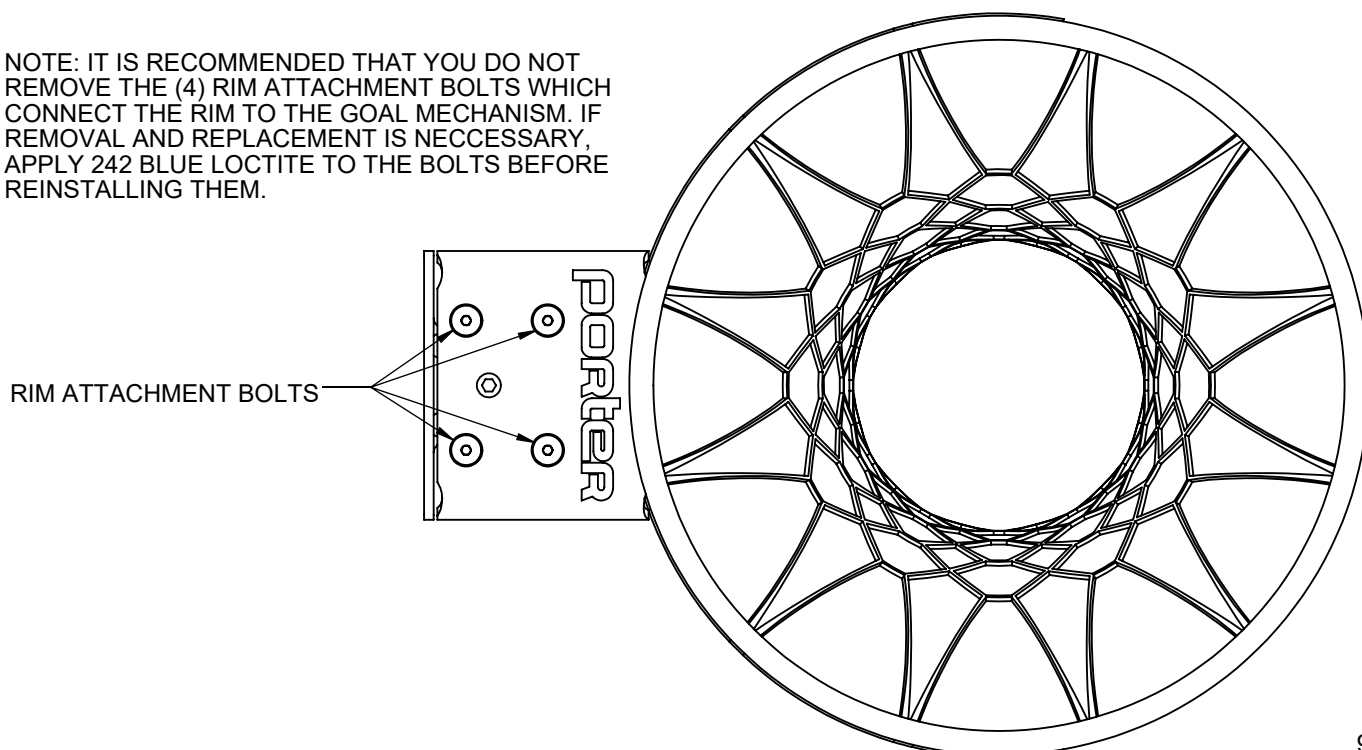



www.porterathletic.com
888-277-7778

260180

PORTER TORQ FLEX ELITE 180° FLEX GOAL GOAL INSTALLATION AND ADJUSTMENT INSTRUCTIONS

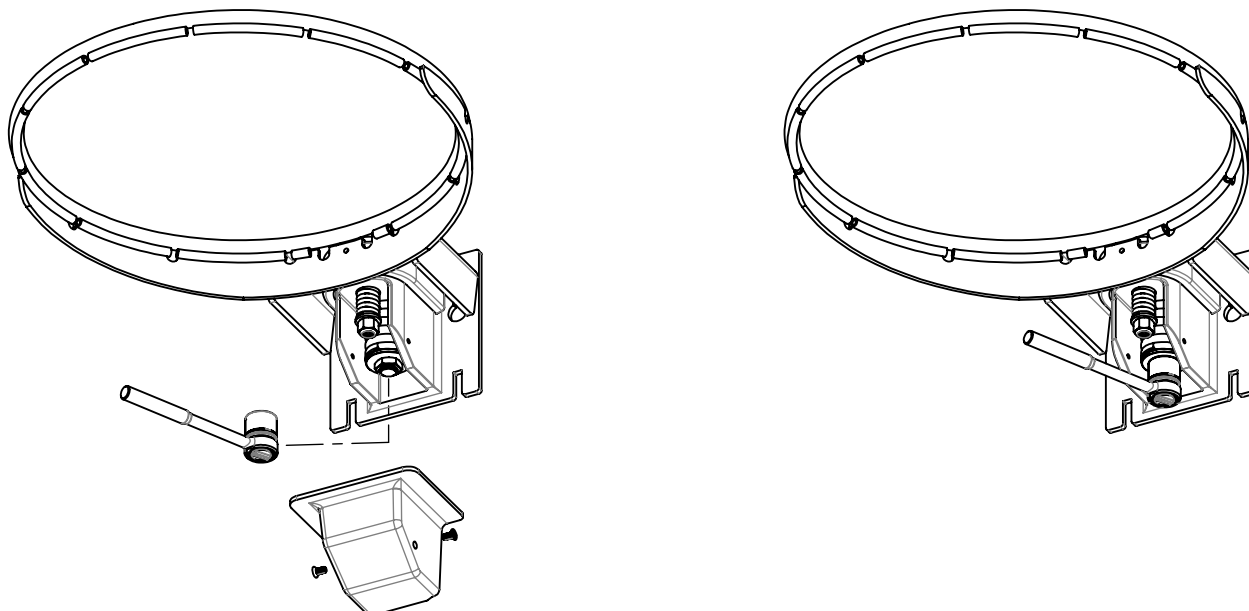

RIGIDITY ADJUSTMENT

TO ADJUST THE GOAL RIGIDITY, FIRST USE A #2 PHILLIPS HEAD SCREWDRIVER TO REMOVE THE RUBBER COVER ON THE BOTTOM OF THE GOAL TO EXPOSE THE GOAL'S SPRING MECHANISMS. PLACE A SOCKET WRENCH WITH A 1" SOCKET ONTO THE REAR, THIN NUT UNDERNEATH THE RED SPRING. FROM ABOVE THE GOAL, PLACE A 5/16" ALLEN WRENCH THROUGH THE OPEN HOLE ON TOP OF THE GOAL PLATE UNTIL IT FITS INTO THE SOCKET HEAD BOLT. TIGHTEN OR LOOSEN THE NUT (COMPRESSING OR RELAXING THE RED SPRING) TO ADJUST THE RIGIDITY READING OF THE GOAL. ONCE COMPLETE, REPLACE THE RUBBER COVER AND THE COVER BOLTS.

WARNINGS: THE THIN NUT MUST MAINTAIN ALL THREADS FULLY ENGAGED ON THE LARGE BOLT; FAILURE TO DO SO COULD RESULT IN FAILURE OF THE GOAL AND SEVERE INJURIES COULD OCCUR. ALSO, DO NOT MAKE ADJUSTMENTS TO THE NUT UNDER THE GOLD SPRING.

