

1. Slide the net tie-off sleeve onto outside upright assembly from bottom, with net cable hook facing downward as shown. Locate top of net tie-off sleeve in line with pulley sheave.
2. Tighten two set screws securely.
3. Use the 1/4" hole in the net tie-off sleeve as a guide and drill a 3/16" hole through the upright.
4. Insert #12 Phillips head screw and drill it in place.

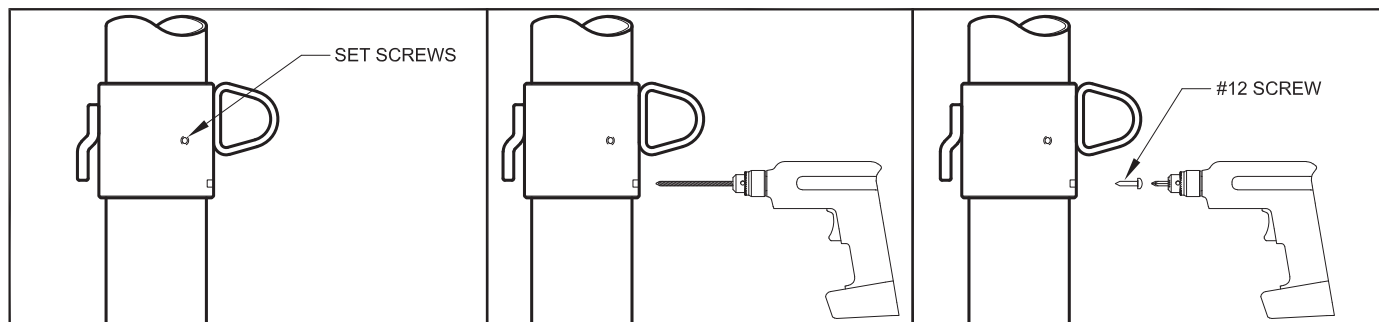

VOLLEYBALL NET TIE-OFF Details for Installation

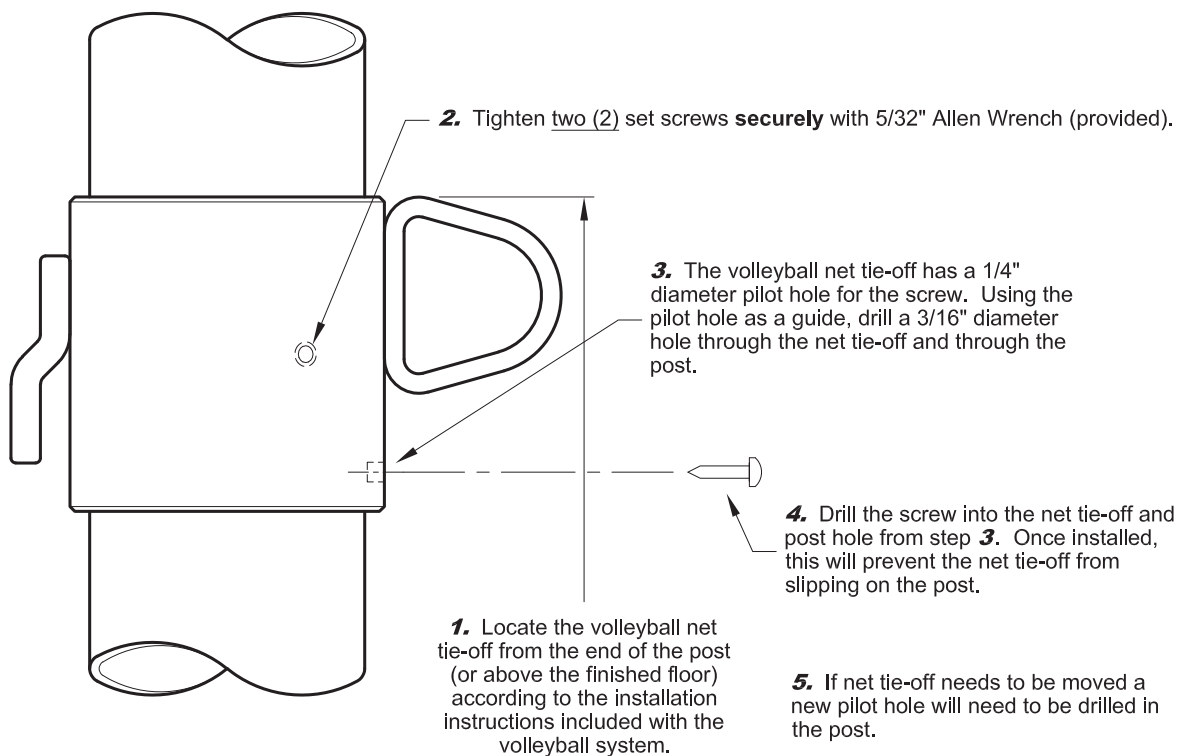

WARNING: This product can expose you to Vinyl Chloride, which is known to the State of California to cause cancer. For more information go to www.p65warnings.ca.gov.