

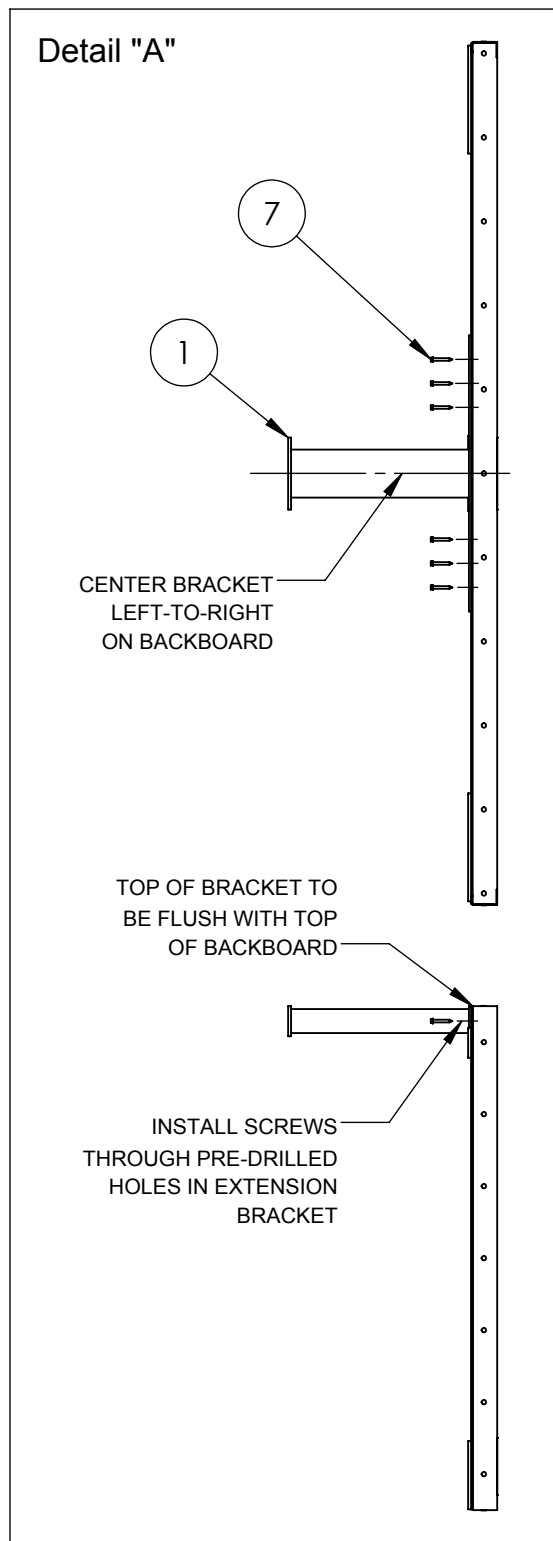

www.porterathletic.com
888-277-7778

183850 - PLATE MOUNT SHOT CLOCK SUPPORT INSTALLATION INSTRUCTIONS



PARTS LIST			
Item No.	Part No.	Qty. Each	Description
1	BRKT00060	1	Extension Bracket
2	FRME18385000	1	Shot Clock Support Upright
3	TUBS13500	1	Support Brace Tube
4	BRKT13200C16	1	Shot Clock Support Mounting Bracket
5	BRKT13500C16	1	Brace Tube Glide Bracket
6	FLAT00365400	1	Glide Plate
7	HDWE061210E0	6	#12 x 7/8" Lg. Self-Drilling, Self-Tapping Screw
8	HDWE012620E0	4	1/4" x 1" Lg. Hex Head Cap Screw (Grade 5)
9	HDWE050030E0	8	1/4" Flat Washer
10	M1290	4	1/4" Nyloc Hex Nut
11	PLTE00800	1	Clamping Plate
12	FLAT00365500	1	Threaded Lock Plate
13	HAND00118	1	Hand Knob; 6in Thread
14	HDWE012230E0	4	3/8" x 5" Lg. Hex Head Cap Screw (Grade 5)
15	HDWE050040E0	9	3/8" Flat Washer
16	HDWE040020E0	4	3/8" Lock Washer
17	HDWE030020E0	4	3/8" Hex Nut
18	HDWE09070	2	3/8" x 3-1/2" Lg. Shoulder Bolt
19	HDWE09071	2	3/8" x 2" Lg. Shoulder Bolt
20	HDWE050020E0	8	5/16" Flat Washer
21	HDWE040010E0	4	5/16" Lock Washer
22	HDWE030010E0	4	5/16" Hex Nut
23	M2752	1	Hand Knob; 1in Thread
24	PCAP00167	2	3" x 3" Tube Cap

1. Check all items against Parts List above to ensure all have been included.
2. Secure the extension bracket (#1) to the top of the backboard. Use six #12 x 7/8" lg. self-drilling, self-tapping screws (#7) through the pre-drilled holes in the extension bracket. Align the top edge of the bracket with the top edge of the backboard, and center the bracket left-to-right on the backboard. See Detail "A".

SAVE THESE INSTRUCTIONS FOR FUTURE USE

3. Attach the threaded lock plate (#12) to the extension bracket (#1) using the 1/4" hex head bolts (#8), 1/4" flatwashers (#9) and 1/4" nyloc hex nuts (#10) provided. Refer to Detail "B" for proper orientation of the threaded lock plate.
4. Insert the long hand knob (#13) through a 3/8" flatwasher (#15) and the clamping plate (#11), then thread the knob into the threaded lock plate (#12). Tighten until the threaded rod is approximately 1" into the lock plate. Refer to Detail "C" for proper orientation of the clamping plate.
5. Attach the shot clock support mounting bracket (#4) to the boom using the 3/8" hex head bolts (#14), 3/8" flatwashers (#15), 3/8" lock washers (#16) and 3/8" hex nuts (#17) provided. Hex bolts insert through pre-drilled holes in boom tube. Refer to Detail "D" for proper orientation of the mounting bracket.

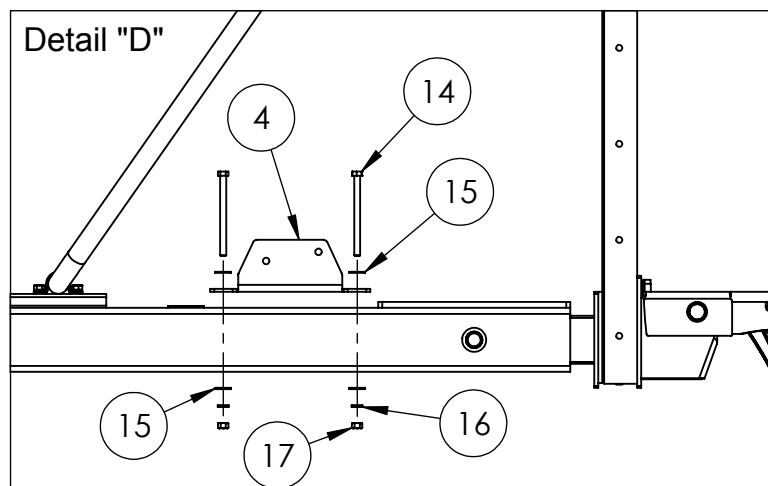
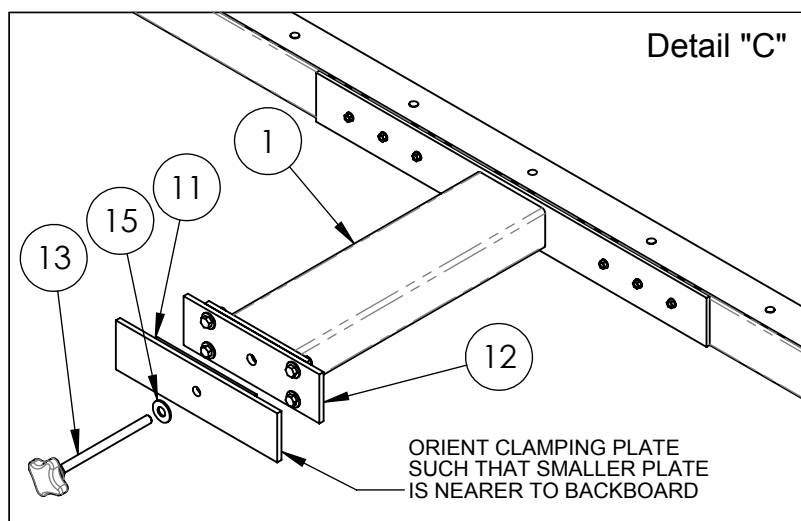
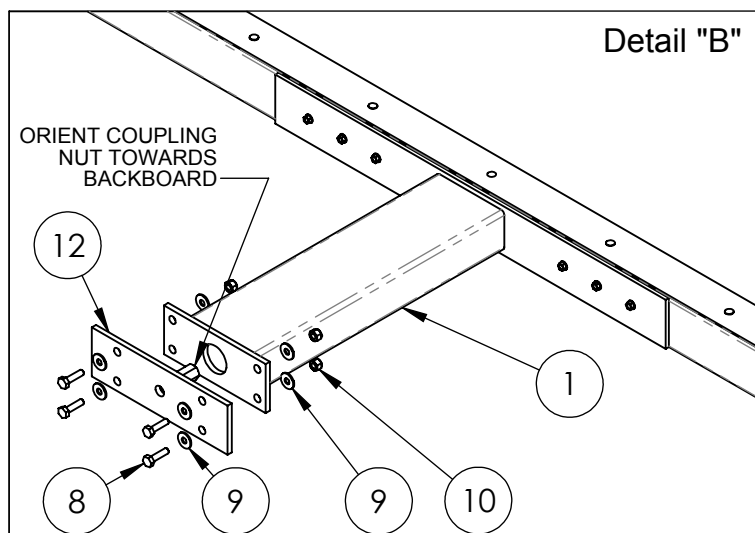

183850 - PLATE MOUNT SHOT CLOCK SUPPORT INSTALLATION INSTRUCTIONS

6. Before attaching the shot clock support upright (#2) to the mounting bracket, the top plate of the shot clock support should be drilled to match the bolt pattern in the bottom of the shot clock being used with this support frame. Refer to Detail "E" for the dimensions of the top plate; the top plate is made of 1/4" thick aluminum plate.
7. Attach the shot clock support upright (#2) to the mounting bracket (#4) using the 3-1/2" long shoulder bolts (#18), 5/16" flatwashers (#20), 5/16" lock washers (#21) and 5/16" hex nuts (#22). Refer to Detail "f" for proper orientation of the shot clock support upright.
8. Attach the brace tube glide bracket (#5) to the glide plate (#6) by threading the 1" hand knob (#23) through the glide bracket and into the glide plate. Thread the hand knob into the glide plate approximately 1/2" and then slide all three components into the channel welded to the top of the boom.

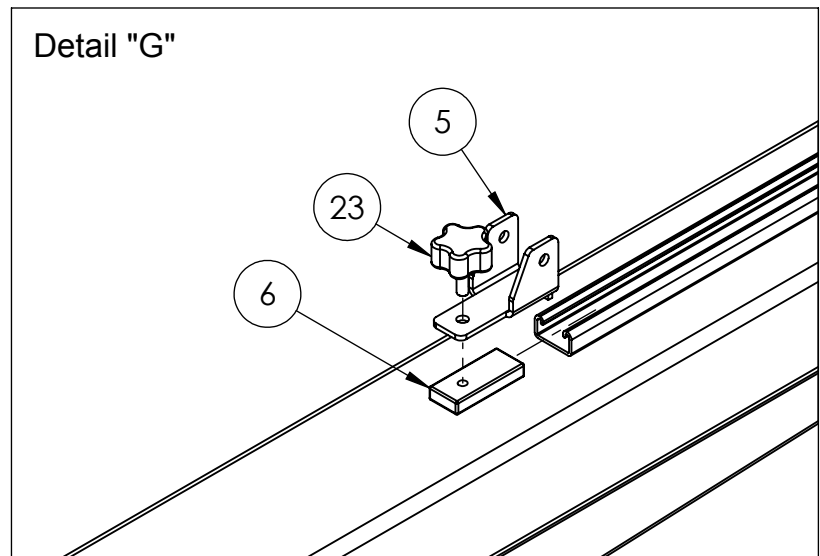
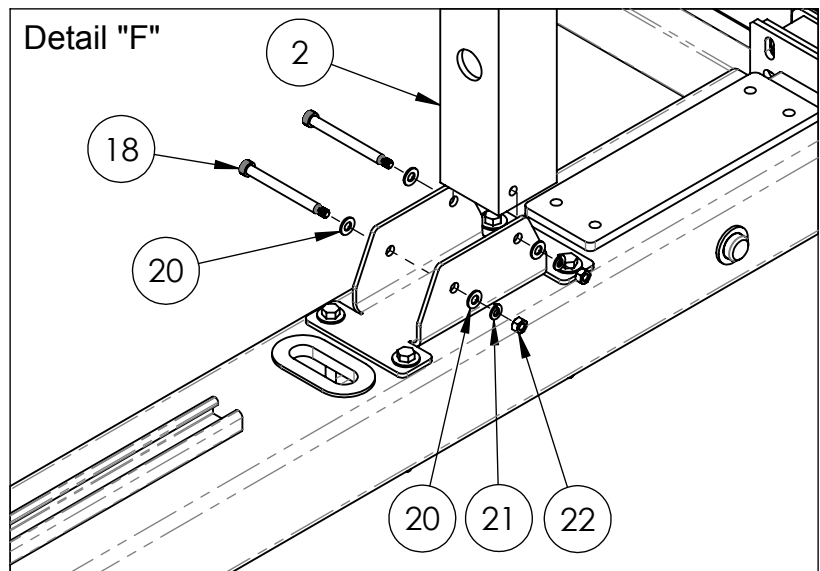
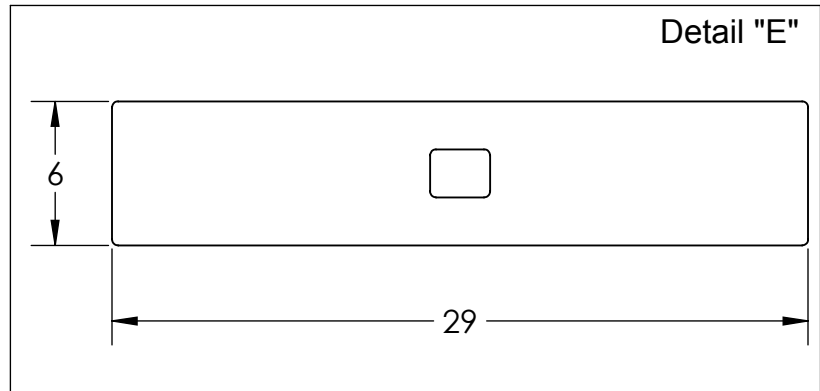

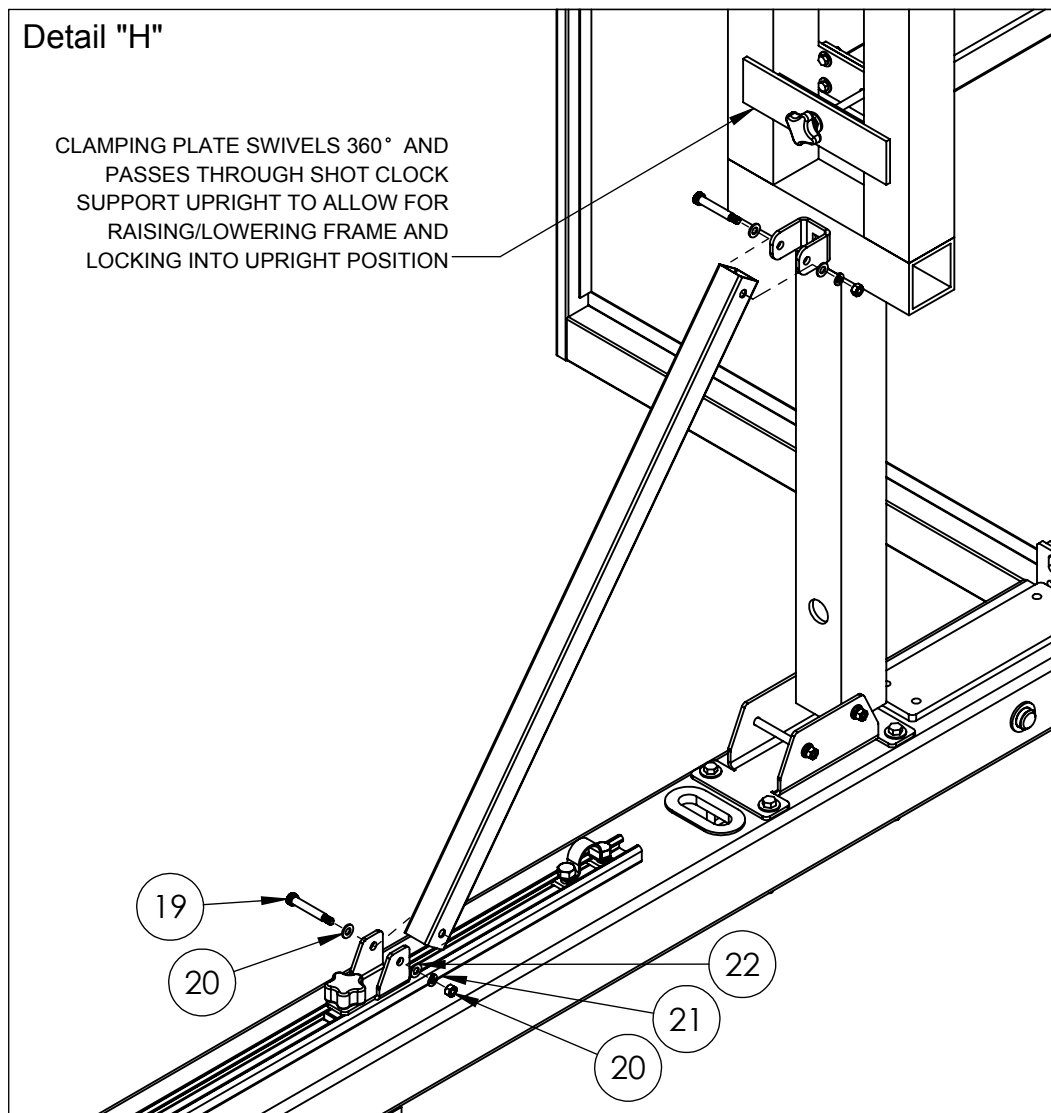

9. Assemble brace tube (#3) to brace tube glide bracket (#5) and shot clock support upright (#2) using 2" long shoulder bolts (#19), 5/16" flatwashers (#20), 5/16" lock washers (#21) and 5/16" hex nuts (#22). Shot clock support can then be raised/lowered following the procedure found on page 6.

10. Route shot clock wiring as shown by the dotted line. Holes in the shot clock support, top of the boom near the backboard, and rear of the boom allow for cabling to be hidden. Once completed, install tube caps (#24) into shot clock support upright as shown in diagram on the right.

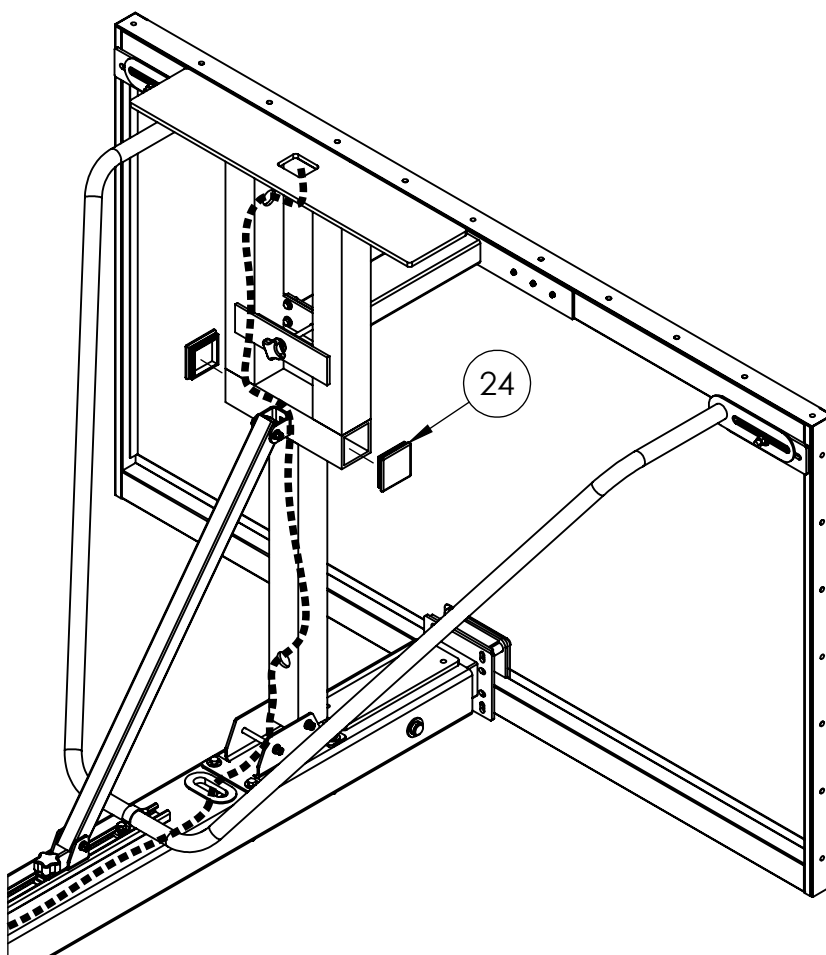

REAR OF BOOM

FRONT OF BOOM

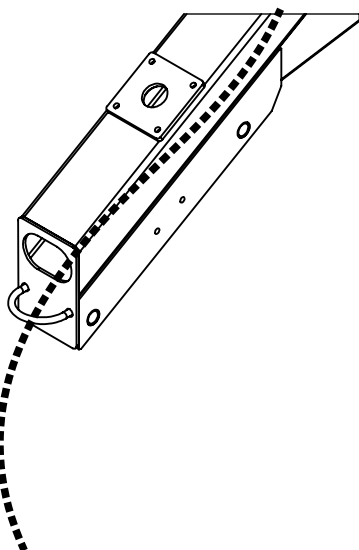

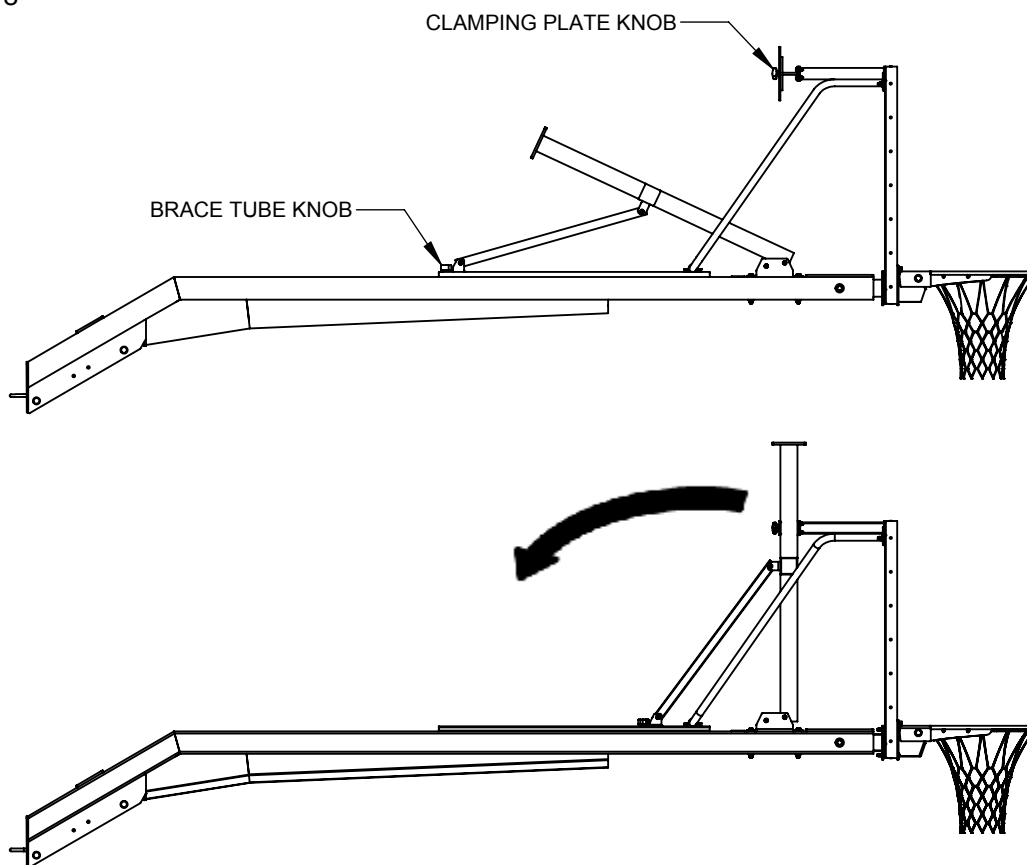

OPERATING PROCEDURE

Raising:

1. Loosen brace tube knob
2. Raise the unit; ensure the clamping plate is turned 90° to pass through upright frame
3. Once frame is in upright position, turn clamping plate parallel to court and tighten clamping plate knob followed by brace tube knob

Lowering:

1. Loosen brace tube knob followed by clamping plate knob; ensure upright is supported as knobs are loosened
2. Turn clamping plate 90° and slowly lower upright frame
3. Once lowered, tighten brace tube knob

THIS WARNING IS GIVEN IN COMPLIANCE
WITH CALIFORNIA'S PROPOSITION 65:

WARNING

This product contains chemicals known to the
State of California to cause cancer, birth defects
or other reproductive harm.

SAVE THESE INSTRUCTIONS FOR FUTURE USE