

00312-016 - WALL-MOUNTED BACKSTOP

CENTER-STRUT® WALL-MOUNTED BACKSTOP FOR RECTANGULAR BACKBOARD - 1'-6" EXTENSION

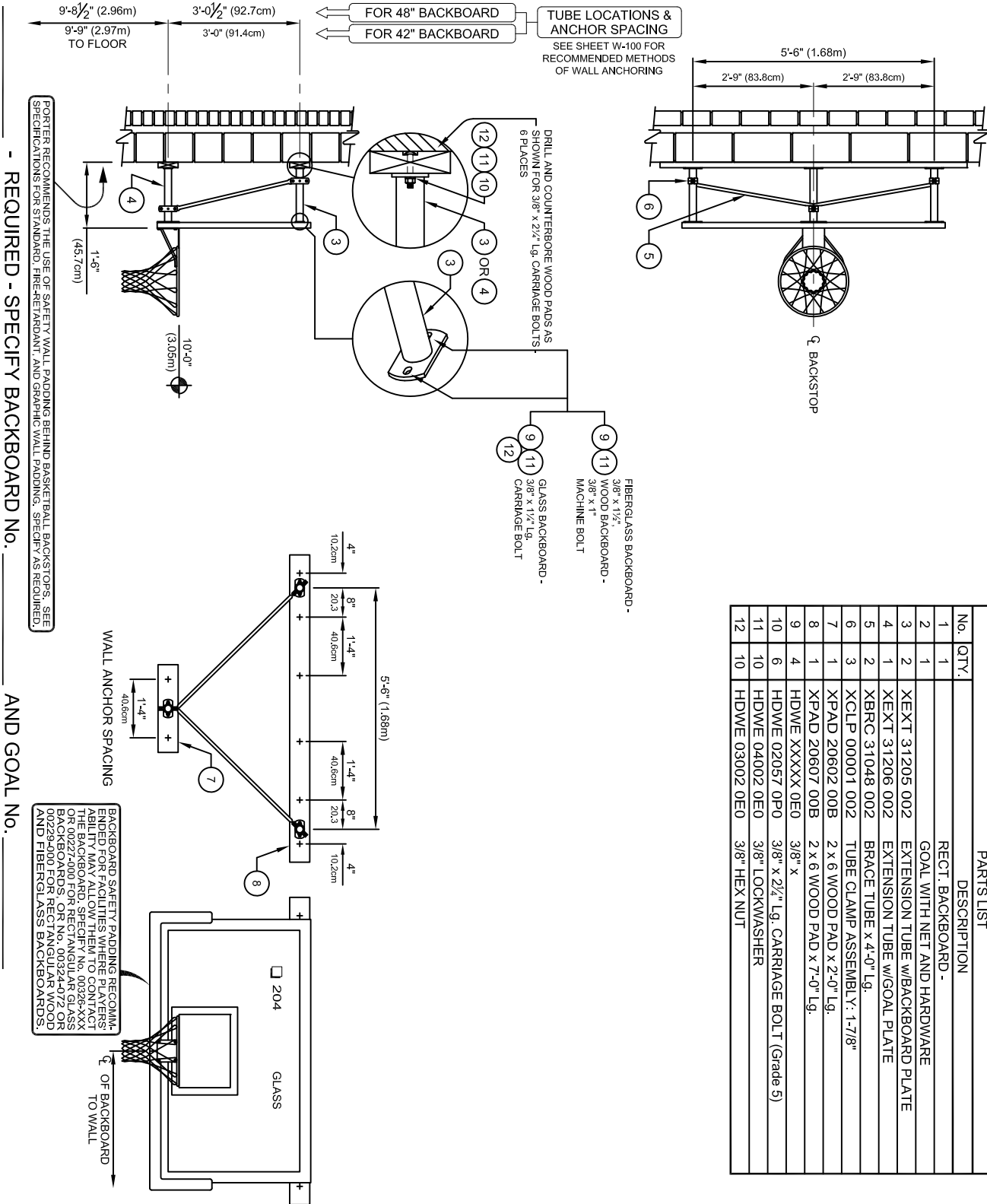

www.porterathletic.com/facility

WALL MOUNT SPECIFICATION SHEET

W-312-R1

PORTER®

888-277-7778 PORTER@PORTERATHLETIC.COM
© COPYRIGHT 2015 PORTER ATHLETIC - ALL RIGHTS RESERVED

PROJECT NUMBER

PROJECT NAME

10/1/2015

00312-016 - WALL-MOUNTED BACKSTOP

CENTER-STRUT® WALL-MOUNTED BACKSTOP
FOR RECTANGULAR BACKBOARD - 1'-6" EXTENSION

SPECIFICATIONS

PORTER No. 00312-016 CENTER-STRUT®
WALL BRACED BACKSTOP FOR RECTANGULAR BACKBOARD

Backstop shall be wall-braced type with face of backboard extended 1'-6" from supporting wall.

Extension frames shall be fabricated of three (3) 1-7/8" O.D. tubes. Both ends of extension frame assemblies shall terminate in heavy steel flanges for attachment to backside of backboard and wall pad attachments. Goal shall mount directly through the backboard and into a heavy steel flange Center-Strut® at the lower extension frame to eliminate any strain on the backboard, should a player hang on the front mounted goal. Backstop shall be braced internally with 7/8" O.D. steel tension braces attached at both ends with precision die-formed clamps for rigidity and support of the Center-Strut® goal mount plate.

Southern yellow pine wall pads shall be provided at all wall attachment points. All edges shall be chamfered and pads shall be finished with two finish coats of natural gloss lacquer.

All metal parts shall be painted one (1) coat of flat black enamel. (If special painting of colors is required, specify final painting by painting contractor.)

Specify backboard and goal as required.