

90920400 - BOTTOM TUBE BATTING/GOLF CAGE

CEILING SUSPENDED UNIT
13' x 12' x 70' STANDARD (CUSTOM SIZES AVAILABLE)

SUPERSTRUCTURE
ENGINEERED PER BUILDING
REQUIREMENTS
MULTIPLE ATTACHMENT
METHODS AVAILABLE

WARNING: CAGE MUST BE POSITIONED
A MINIMUM OF 2'-6" OFF THE NEAREST
WALL - MUST NOT BE LOCATED AT
A WALKWAY OR DOORWAY

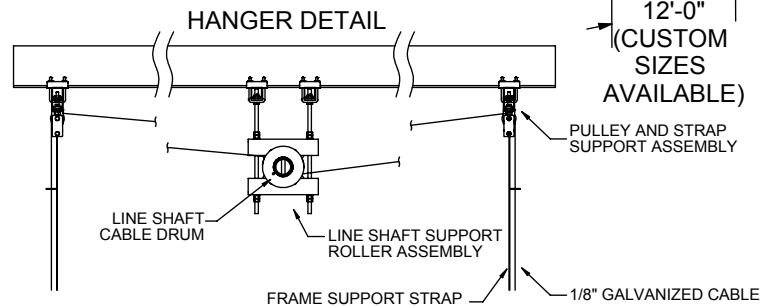
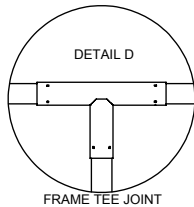
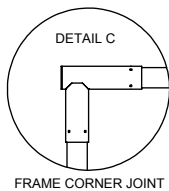
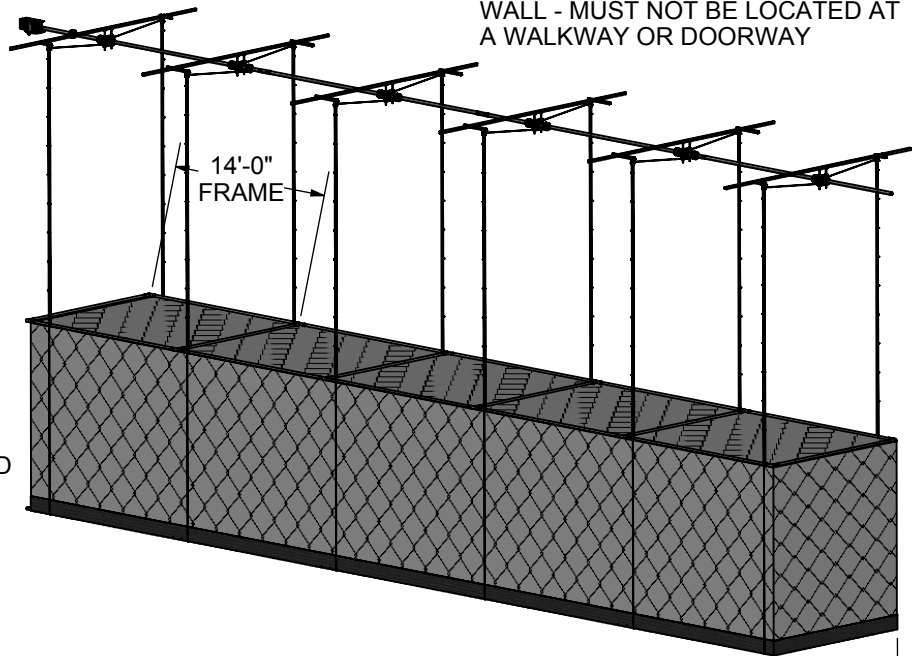
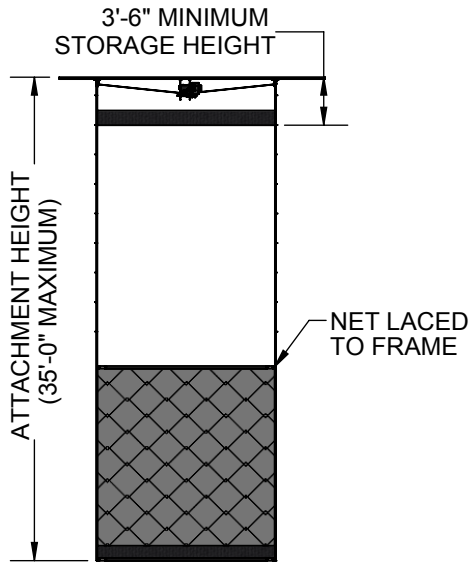

3/4" SQUARE
KNOTLESS NYLON
MESH, ON 4 SIDES
AND TOP

13'-0" (CUSTOM SIZES AVAILABLE)

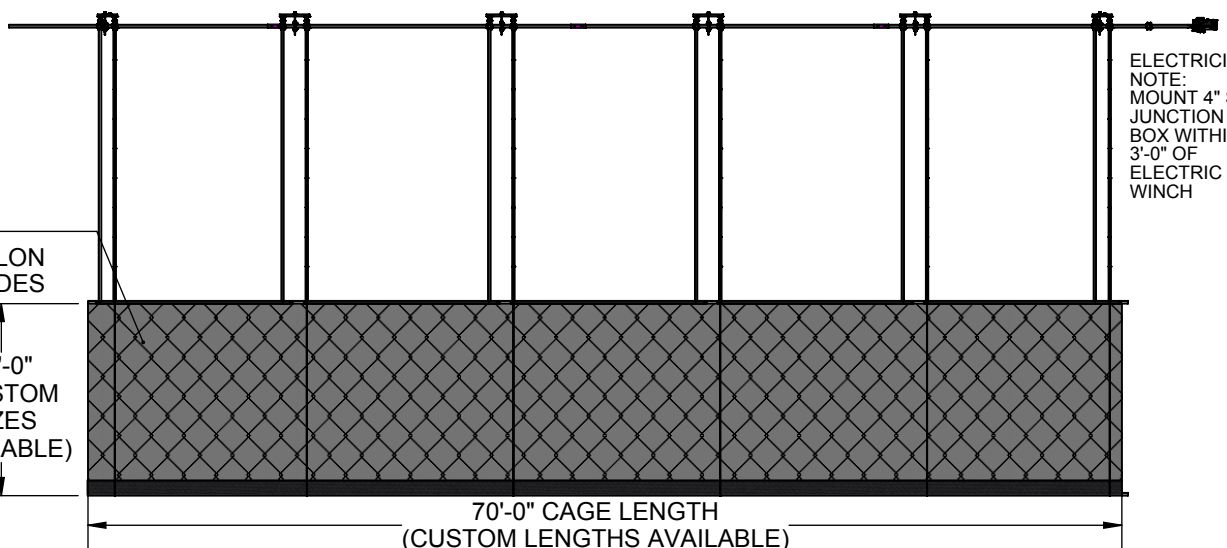

- 90920400 - BOTTOM TUBE BATTING/GOLF CAGE CEILING SUSPENDED UNIT
- SIZE OF CAGE (CUSTOM ORDERS ONLY)

90920400 - BOTTOM TUBE BATTING/GOLF CAGE

CEILING SUSPENDED UNIT
12' x 12' x 70' STANDARD (CUSTOM SIZES AVAILABLE)

SPECIFICATIONS

Size of cage to be 13'-0" high x 12'-0" wide x 70'-0" in length. The four sides and top of cage shall be 3/4" square, knotless nylon mesh netting (#420 twine). Color of netting to be black. A webbing style binding shall be sewn into the perimeter of each section of netting. A vinyl pocket shall be sewn into the bottom of each net side section. Two zippered entrances shall be provided on opposite corners of the cage.

Supporting frames (12' x 70') of cage to be constructed of 1-7/8" O.D. heavy-wall electro-plated tubing with cross spreaders located at 14'-0" centers. Tee fittings shall be provided at each tubing junction. Cable pulley/webbing support assemblies (12) shall be located above cage frame longitudinal sections at 14'-0" centers. Adjustable frame stop collar assemblies shall be provided for securing 2" polyester webbing D-ring straps (12) to supporting frame, allowing for proper support and leveling of frame assembly. Hoist cables (14) routed through D-rings sewn into the webbing assemblies and through rings attached to the outside of the net shall be of 1/8" diameter, vandal-proof galvanized cable (2,100 lb. breaking strength each cable).

For compact storage, the cage net and frame shall be automatically raised in close proximity to the support structure level eliminating the requirement of manually placing the four sides of netting on top of the frame.

Upper ends of hoist cables shall terminate into individual hoist drums (14) positioned on continuous 2-3/8" O.D. tube line shaft arrangement. Line shaft shall turn in special support assemblies (6); each equipped with two 3" diameter phenolic wheel rollers. Support assemblies shall be secured to structural roof framing supports by means of threaded rods, to provide structural integrity and accommodate all slopes or building camber.

Tee fittings and hoist drums shall be finished in a durable gray powder-coated finish.

See winch specifications for more information on included Porter winch system and control options. (see C-701)

Porter No. 12005100 Audible Motion Alarm shall be included as standard (with 115 volt operators only), to provide an intermittent warning tone whenever the cage is being raised or lowered. (see E-2005 for details)

WARRANTY

- Batting / Golf cages come with a 1 year limited warranty.
- Other components may be covered by their own extended warranty.

OPTIONAL ITEMS (SEE SPECIFICATION SHEETS FOR DETAIL)

- Line Shaft Safety Lock (C-10796, No. 10796000).
- Audible Motion Alarm: to provide an intermittent warning tone whenever the cage is being raised or lowered. (E-2005, No. 12005100)

LEED® SUBMITTAL INFORMATION

Credit	Measure
MRc4-Recycled Content	Post Consumer Average 15% Post Industrial 0%
MRc5-Regional Materials	Raw materials originate from multiple sources so origin point cannot be determined. Final Manufacturing/Assembly in Champaign, IL 61822