

00902211 - CENTER-STRUT HEIGHT ADJUSTER

POWR-STICK OPERATION FOR FAN BACKBOARD
NO.216, NO. 267A FIBERGLASS, NO. 234 OR 234A ALUMINUM

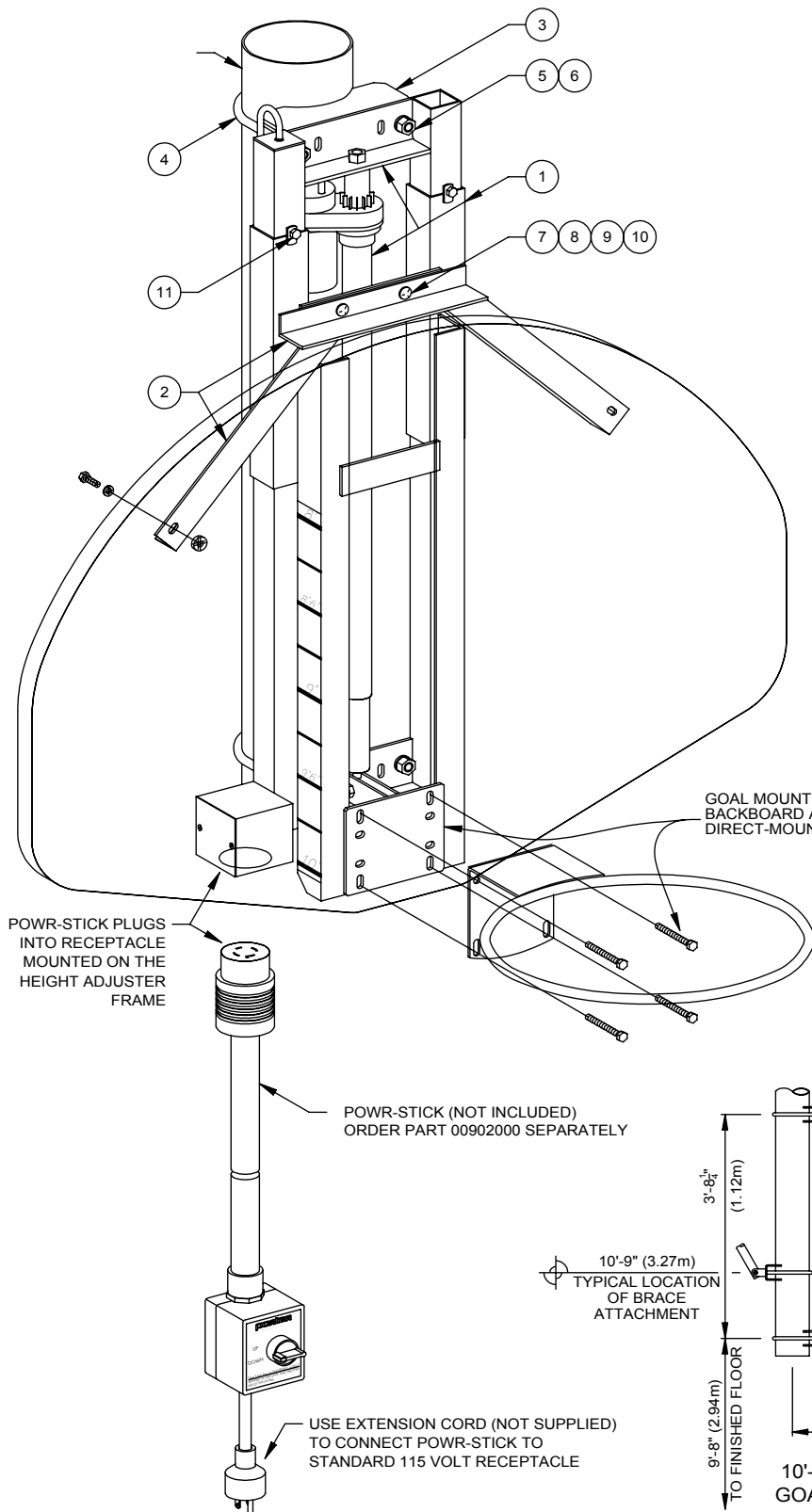

PARTS LIST			
NO.	QTY.	PART NO.	DESCRIPTION
1	1	FRME00206002	HEIGHT ADJUSTER ASSEMBLY
2	1	FRME0020202	FAN BACKBOARD SUPPORT
3	2	CLMP0056002	MAST CLAMP
4	2	UBOT000060E2	5/8" U-BOLT
5	4	HDWE04006000	5/8" LOCKWASHER
6	4	HDWE03012000	5/8" HEX NUT
7	2	HDWE020130E0	3/8" x 1 1/4" LG. CARRIAGE BOLT (GRADE 5)
8	2	HDWE050040E0	3/8" FLATWASHER
9	2	HDWE040020E0	3/8" LOCKWASHER
10	2	HDWE030020E0	3/8" HEX NUT
11	4	HDWE01134000	3/8" x 1/2" LG. NYLON BOLT

GOAL MOUNTING HARDWARE EXTENDS THROUGH BACKBOARD AND CENTER CHANNEL TO PROVIDE DIRECT-MOUNT CENTER-STRUT® FEATURE

HEIGHT SETTINGS LABEL APPLIED TO SIDE OF HEIGHT ADJUSTER

10'-9" (3.27m)
TYPICAL LOCATION OF BRACE ATTACHMENT

3'-8 1/2" (1.12m)
9'-8" (2.94m)
TO FINISHED FLOOR

10'-0" (3.05m)
GOAL HEIGHT

8'-0" (2.44m)
GOAL HEIGHT

_____ - 00902211 POWR-STICK OPERATION FOR FAN BACKBOARD
_____ - NUMBER OF POWR-STICKS REQUIRED

00902211 - CENTER-STRUT HEIGHT ADJUSTER

POWR-STICK OPERATION FOR FAN BACKBOARD
NO.216, NO. 267A FIBERGLASS, NO. 234 OR 234A ALUMINUM

SPECIFICATIONS

Height adjustment unit shall be designed for use with No. 900 Center-Strut® series ceiling suspended basketball backstop support systems to provide an adjustable, direct-mount (Center-Strut®) goal attachment system to eliminate any strain on the backboard should a player hang on the front mounted goal (conforms to the latest NCAA recommendation). Height adjustment units without the prescribed direct-mount goal feature will not be approved as equal. Height adjustment feature will allow goal height settings from 8'-0" to the official 10'-0" for use by all age groups. Unit shall be designed for use only with Porter No. 216 rectangular fiberglass, Porter No. 267A fan fiberglass or No. 234 or 234A fan aluminum backboards.

Center unitized support frame shall be fabricated by dual, 2-3/16" square heavy-wall zinc plated guide tubes located on 11-3/16" centers. Ends of guide tubes shall be welded to heavy, formed mounting brackets. Heavy formed, die cut steel clamp assemblies (2) shall be provided for securing height adjustment assembly directly to a 6-5/8" O.D. center support structure (No. 900 Center-Strut® series basketball backstops). Outer dual slide tubes shall support heavy structural steel angle sections which extend downward to accept a direct-mount (Center-Strut®) goal mounting system. Slide tube assembly shall be provided with a heavy steel section to attach a special upper backboard support assembly to secure the unit to the upper two corners of the fan shaped backboard on standard (2'-11") mounting centers.

Height adjustment unit shall incorporate a compact 115-volt, gear motor type linear actuator with 600 pound thrust capacity to raise and lower the goal height electrically. Motor shall draw 1.4 amps under full load. Integral limit switches shall provide automatic shut off at 8' and 10' goal heights. The motor shall be controlled by a Powr-Stick portable electric control. The Powr-Stick includes a rotary control switch with UP and DOWN positions and a center off position. The Powr-Stick easily plugs into a special receptacle mounted on the height adjuster frame from the floor. With an extension cord (not provided), the Powr-Stick connects to a standard 115-volt wall receptacle, eliminating the necessity for field wiring.

A height setting scale shall be located on the side of the unit to visually determine height settings from 8'-0" to 10'-0" in 3" increments.

Height adjustment frame shall be finished with one coat of flat black enamel. Hardware shall be furnished for mounting unit to a 6-5/8" O.D. vertical support tube.

WARRANTY

- Height Adjusters furnished with a 1-year limited warranty.