

# 00501-211 - HEIGHT ADJUSTMENT SYSTEM

## CENTER-STRUT® HEIGHT ADJUSTMENT SYSTEM FOR FAN BACKBOARD - ELECTRIC OPERATION WITH KEY SWITCH

PORTER

WWW.PORTERATHLETIC.COM/FACILITY

HEIGHT ADJUSTMENT SYSTEM SPECIFICATION SHEET

B-501-211

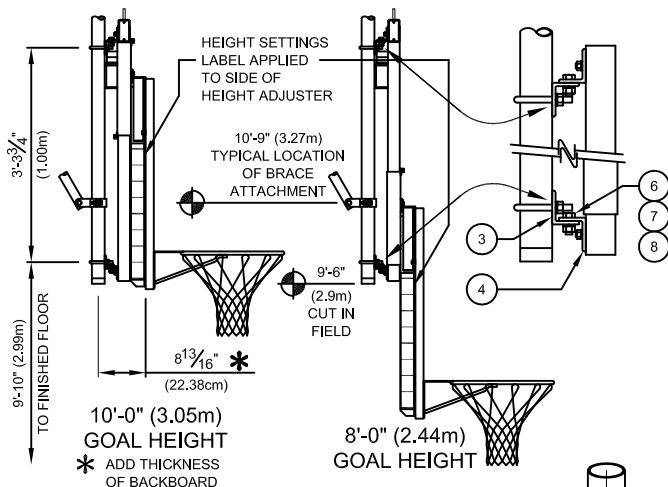

PARTS LIST		
No.	QTY.	DESCRIPTION
1	1	FRME 00213 002 HEIGHT ADJUSTER ASSEMBLY
2	1	FRME 00202 002 FAN BACKBOARD SUPPORT
3	2	ANGL 00191 002 SPAN ANGLE - 3'-4\" Lg.
4	2	ANGL 00190 002 MOUNTING ANGLE - 9\" Lg.
5	4	UBOT 00007 000 U-BOLT
6	4	HDWE 01154 0P0 1/2\" x 1 1/2\" Lg. HEX HEAD CAP SCREW (Grade 5)
7	12	HDWE 04003 0E0 1/2\" LOCKWASHER
8	12	HDWE 03003 0E0 1/2\" HEX NUT
9	6	HDWE 02073 0P0 3/8\" x 1 1/2\" Lg. CARRIAGE BOLT (Grade 5)
10	6	HDWE 05004 0E0 3/8\" FLATWASHER
11	6	HDWE 04002 0E0 3/8\" LOCKWASHER
12	6	HDWE 03002 0E0 3/8\" HEX NUT
13	4	HDWE 01134 000 3/8\" x 1 1/2\" Lg. NYLON BOLT
14	1	ELEC 00086 000 KEY SWITCH ASSEMBLY

### NOTE

FOR USE ONLY WITH PORTER No. 00267-698 FAN FIBERGLASS, AND PORTER No. 00234-000 Or 00234-300 FAN ALUMINUM, BACKBOARDS.

### KEY SWITCH OPERATION

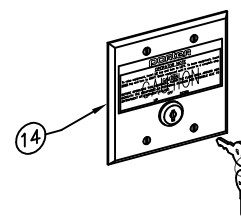

FLUSH MOUNTED-TYPE SWITCH FURNISHED WITH DUAL (UP-DOWN) KEY OPERATION MOUNTED IN A STAINLESS STEEL COVER PLATE. WIRING DIAGRAM PROVIDED WITH EACH UNIT. KEY SWITCHES MAY BE GANGED IN PAIRS IN ONE COVER PLATE - ONE FOR THE BACKSTOP, ONE FOR THE HEIGHT ADJUSTER.

### WARNING

SUBSTITUTION OF THIS KEY SWITCH WILL VOID ALL WARRANTIES AND WILL RENDER THE OPERATION OF THE HEIGHT ADJUSTER UNSAFE.

### CAUTION

KEY SWITCH MUST BE MOUNTED ON THE WALL IN A LOCATION SO THAT THE EQUIPMENT IT IS CONTROLLING IS IN FULL VIEW OF THE OPERATOR.

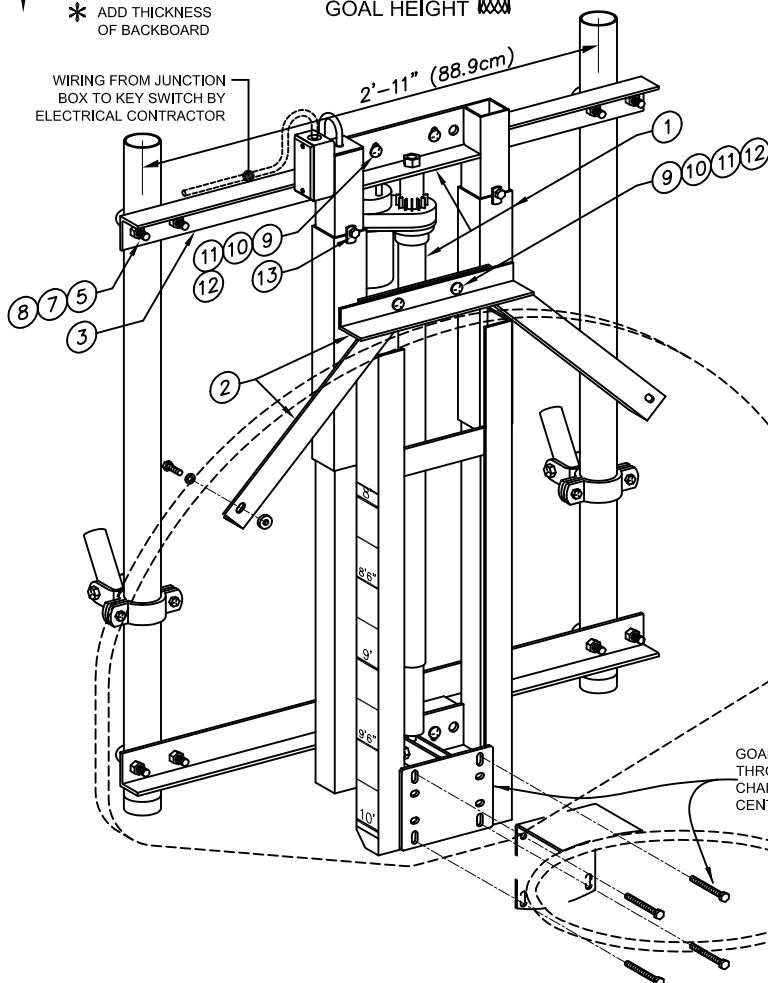

GOAL MOUNTING HARDWARE EXTENDS THROUGH BACKBOARD AND CENTER CHANNEL TO PROVIDE DIRECT-MOUNT CENTER-STRUT® FEATURE

SEE PAGE No. B-901-K FOR FIELD WIRING DETAILS AND REQUIREMENTS

— 00501-211 HEIGHT ADJUSTMENT SYSTEM FOR No. 500 SERIES BACKSTOP WITH FAN BACKBOARD - ELECTRIC OPERATION WITH KEY SWITCH

PORTER®

888-277-7778 PORTER@PORTERATHLETIC.COM  
© COPYRIGHT 2014 PORTER ATHLETIC - ALL RIGHTS RESERVED

PROJECT NUMBER

PROJECT NAME

4/16/2014

# 00501-211 - HEIGHT ADJUSTMENT SYSTEM

## CENTER-STRUT® HEIGHT ADJUSTMENT SYSTEM FOR FAN BACKBOARD - ELECTRIC OPERATION WITH KEY SWITCH

### SPECIFICATIONS

#### PORTER No. 00501-211 CENTER-STRUT® HEIGHT ADJUSTMENT SYSTEM WITH ELECTRIC KEY SWITCH OPERATION FOR USE ON No. 500 SERIES BASKETBALL BACKSTOPS WITH FAN SHAPED BACKBOARDS

Height adjustment unit shall be designed for use with No. 500 series ceiling suspended basketball backstop support systems to provide an adjustable, direct-mount (Center-Strut®) goal attachment system to eliminate any strain on the backboard should a player hang on the front mounted goal (conforms to the latest NCAA recommendation). Height adjustment units without the prescribed direct-mount goal feature will not be approved as equal. Height adjustment feature will allow goal height settings from 8'-0" to the official 10'-0" for use by all age groups. Unit shall be designed for use only with Porter No. 00267-698 fan fiberglass or No. 00234-000 or 00234-300 fan aluminum backboards.

Center unitized support frame shall be fabricated by dual, 2-3/16" square heavy-wall zinc plated guide tubes located on 11-3/16" centers. Ends of guide tubes shall be welded to heavy, formed mounting brackets. Height adjustment assembly mechanism shall be supported to No. 500 line drop frame assembly on 2'-11" centers by heavy structural support angles. Outer dual slide tubes shall support heavy structural steel angle sections which extend downward to accept a direct-mount (Center-Strut®) goal mounting system. Slide tube assembly shall be provided with a heavy steel section to attach a special upper backboard support assembly to secure the unit to the upper two corners of the fan shaped backboard.

Height adjustment unit shall incorporate a compact 115-volt, gear motor type linear actuator with 600 pound thrust capacity to raise and lower the goal height electrically. Motor shall draw 1.4 amps under full load. Integral limit switches shall provide automatic shut off at 8' and 10' goal heights. The motor shall be controlled by a special dual keyed, flush wall-mounted momentary key switch. Switch assembly shall be furnished with a 4-1/2" square stainless steel cover plate for mounting in a masonry wall box by the electrical contractor. (Key switches may be ganged in pairs in one cover plate to control the actuator and the backstop winch - specify requirements). Wiring from junction box on height adjuster frame to key switch shall be provided by the electrical contractor to meet all local code requirements.

Wiring of all electrical components shall be in accordance with local area codes, and in accordance with manufacturer's instructions. All conduit, wiring, junction boxes and components not specified herein shall be furnished and installed by the electrical contractor.

A height setting scale shall be located on the side of the unit to visually determine height settings from 8'-0" to 10'-0" in 3" increments.

Height adjustment frame shall be finished with one coat of flat black enamel. Hardware shall be furnished for mounting unit to a 2-3/8" O.D. vertical support structure on 2'-11" centers.

#### LIFETIME WARRANTY (ADD TO SPECIFICATIONS AS REQUIRED)

Limited Lifetime warranty on Porter fan shaped fiberglass (00267-698) or aluminum (00234-000 or 00234-300) backboards when used in conjunction with No. 00501-211 Center-Strut® height adjustment unit installed on a Porter No. 500 series support structure.