

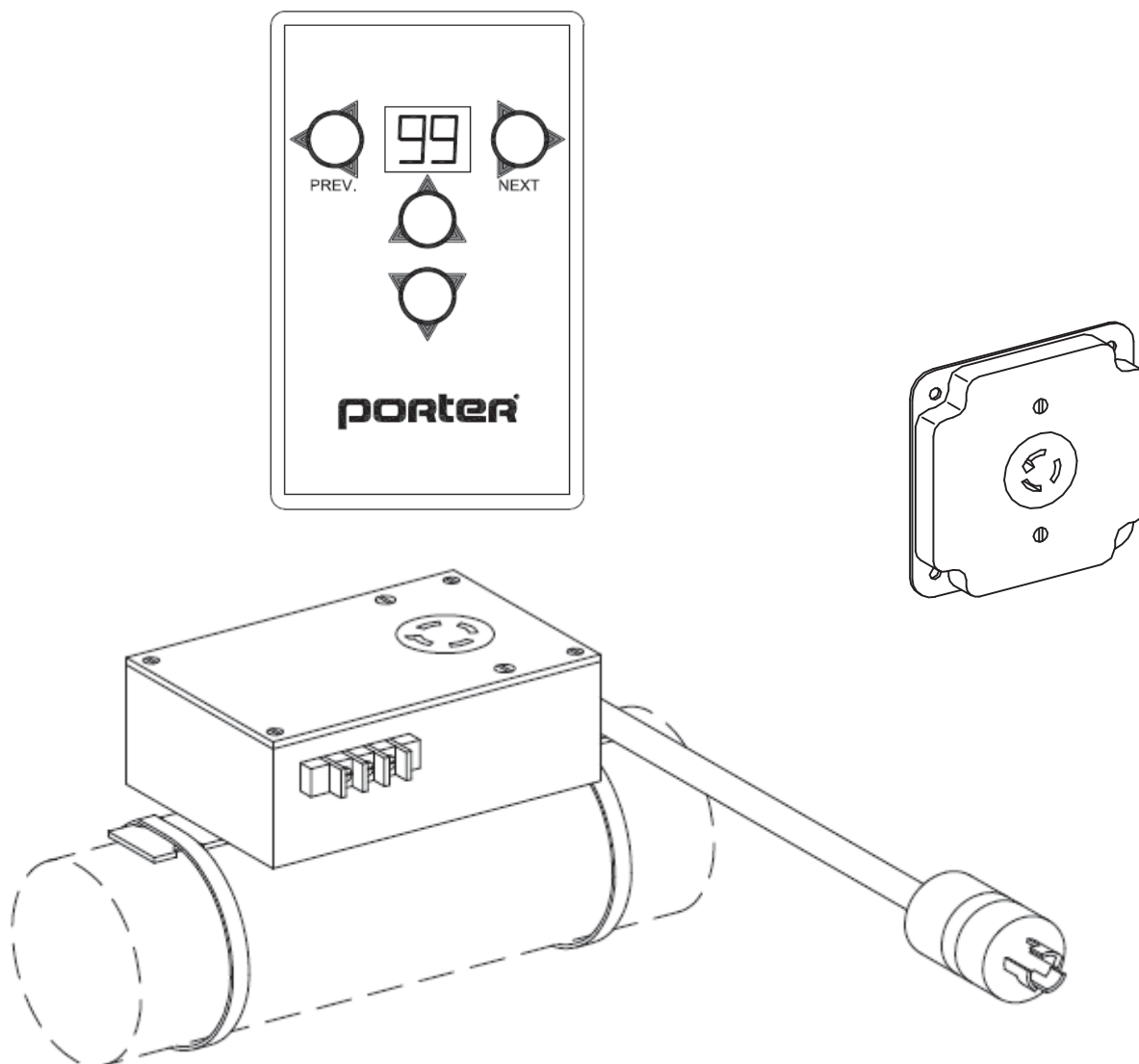

INSTALLATION & OPERATION MANUAL

REMOTE CONTROL SYSTEM FOR BASKETBALL BACKSTOPS, GYMNASIUM DIVIDERS, ETC. No. 12002 Sportsonic® II



SAVE THESE INSTRUCTIONS FOR FUTURE REFERENCE,
AND TO ORDER REPLACEMENT PARTS

PARTS LIST — No. 12002-200	
No.	QTY.
1	1
2	1
3	1
4	2
5	1

DESCRIPTION	
1	XELC 12002-210 SPORTSONIC® II RECEIVER
2	ELEC 00064-000 3-POLE TWIST-LOCK RECEPTACLE
3	ELEC 00126-000 1/2" DEEP COVER PLATE
4	ELEC 00221-002 CABLE TIE 14" LG. — BLACK
5	12002-100 SPORTSONIC® II TRANSMITTER — 99 POSITIONS

* SPECIFY QUANTITY OF SPORTSONIC® II TRANSMITTERS REQUIRED



12002-100 99 POSITION TRANSMITTER



12002-200 SPORTSONIC® II RECEIVER

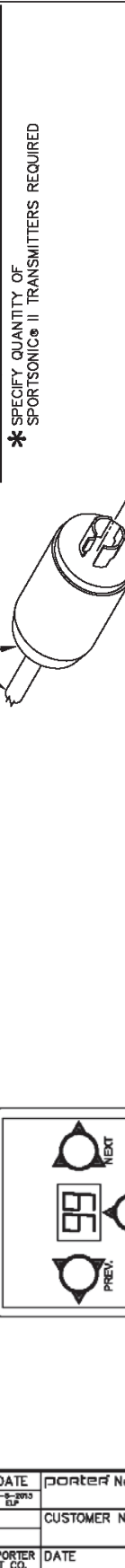

6'-0" LG. SJO CORD WITH NEMA L14-20 TWIST-LOCK TYPE PLUG FROM WINCH



6'-0" LG. SJO CORD WITH NEMA L14-20 TWIST-LOCK TYPE PLUG FROM WINCH

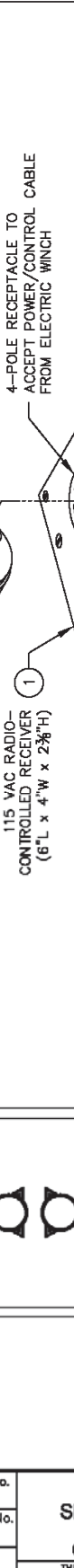

6'-0" LG. SJO CORD WITH NEMA L14-20 TWIST-LOCK TYPE PLUG FROM WINCH



6'-0" LG. SJO CORD WITH NEMA L14-20 TWIST-LOCK TYPE PLUG FROM WINCH



6'-0" LG. SJO CORD WITH NEMA L14-20 TWIST-LOCK TYPE PLUG FROM WINCH

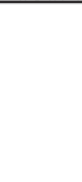

6'-0" LG. SJO CORD WITH NEMA L14-20 TWIST-LOCK TYPE PLUG FROM WINCH



6'-0" LG. SJO CORD WITH NEMA L14-20 TWIST-LOCK TYPE PLUG FROM WINCH



6'-0" LG. SJO CORD WITH NEMA L14-20 TWIST-LOCK TYPE PLUG FROM WINCH



6'-0" LG. SJO CORD WITH NEMA L14-20 TWIST-LOCK TYPE PLUG FROM WINCH



6'-0" LG. SJO CORD WITH NEMA L14-20 TWIST-LOCK TYPE PLUG FROM WINCH



6'-0" LG. SJO CORD WITH NEMA L14-20 TWIST-LOCK TYPE PLUG FROM WINCH



6'-0" LG. SJO CORD WITH NEMA L14-20 TWIST-LOCK TYPE PLUG FROM WINCH

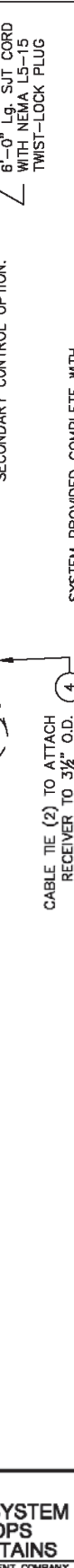

6'-0" LG. SJO CORD WITH NEMA L14-20 TWIST-LOCK TYPE PLUG FROM WINCH



6'-0" LG. SJO CORD WITH NEMA L14-20 TWIST-LOCK TYPE PLUG FROM WINCH



6'-0" LG. SJO CORD WITH NEMA L14-20 TWIST-LOCK TYPE PLUG FROM WINCH



6'-0" LG. SJO CORD WITH NEMA L14-20 TWIST-LOCK TYPE PLUG FROM WINCH



6'-0" LG. SJO CORD WITH NEMA L14-20 TWIST-LOCK TYPE PLUG FROM WINCH



6'-0" LG. SJO CORD WITH NEMA L14-20 TWIST-LOCK TYPE PLUG FROM WINCH



6'-0" LG. SJO CORD WITH NEMA L14-20 TWIST-LOCK TYPE PLUG FROM WINCH



6'-0" LG. SJO CORD WITH NEMA L14-20 TWIST-LOCK TYPE PLUG FROM WINCH



6'-0" LG. SJO CORD WITH NEMA L14-20 TWIST-LOCK TYPE PLUG FROM WINCH



6'-0" LG. SJO CORD WITH NEMA L14-20 TWIST-LOCK TYPE PLUG FROM WINCH



6'-0" LG. SJO CORD WITH NEMA L14-20 TWIST-LOCK TYPE PLUG FROM WINCH



6'-0" LG. SJO CORD WITH NEMA L14-20 TWIST-LOCK TYPE PLUG FROM WINCH



6'-0" LG. SJO CORD WITH NEMA L14-20 TWIST-LOCK TYPE PLUG FROM WINCH



6'-0" LG. SJO CORD WITH NEMA L14-20 TWIST-LOCK TYPE PLUG FROM WINCH



6'-0" LG. SJO CORD WITH NEMA L14-20 TWIST-LOCK TYPE PLUG FROM WINCH



6'-0" LG. SJO CORD WITH NEMA L14-20 TWIST-LOCK TYPE PLUG FROM WINCH



6'-0" LG. SJO CORD WITH NEMA L14-20 TWIST-LOCK TYPE PLUG FROM WINCH



6'-0" LG. SJO CORD WITH NEMA L14-20 TWIST-LOCK TYPE PLUG FROM WINCH



6'-0" LG. SJO CORD WITH NEMA L14-20 TWIST-LOCK TYPE PLUG FROM WINCH



6'-0" LG. SJO CORD WITH NEMA L14-20 TWIST-LOCK TYPE PLUG FROM WINCH

WARNING
CORDLESS CONTROLLER MUST ALWAYS BE IN THE POSSESSION OF A RESPONSIBLE, TRAINED ADULT AWARE OF THE POSSIBLE STRUCTURAL DAMAGE OR INJURIES THAT MAY OCCUR AS THE RESULT OF IMPROPER OPERATION OR MALFUNCTION.

— 12002-200 SPORTSONIC® II RECEIVER
(QTY. REQUIRED)
ONE REQUIRED AT EACH BACKSTOP OR DIVIDER CURTAIN WINCH LOCATION

— 12002-100 SPORTSONIC® II TRANSMITTER
(QTY. REQUIRED)
OPERATES UP TO 99 INDIVIDUAL UNITS

REVISION	DATE	portier No.
1	11-11-2013	ES
CUSTOMER No.	DATE	
	3-1-2002	

SPORTSONIC® II
SPORTS COMPLEX CONTROL SYSTEM
FOR BASKETBALL BACKSTOPS
OR GYMNASIUM DIVIDER CURTAINS
THIS PRINT IS THE PROPERTY OF PORTER ATHLETIC EQUIPMENT COMPANY
AND MAY NOT BE REPRODUCED WITHOUT WRITTEN PERMISSION

portier
WORLD LEADER
IN QUALITY SPORTS EQUIPMENT
801 Mercury Drive
Champaign, Illinois 61822
www.porterathletic.com

DRAWING BY	TJK
CHECKED BY	ES
PAGE No.	B-2002-200

SPECIFICATIONS

PORTER No. 12002-200 SPORTSONIC® II SPORTS COMPLEX CONTROL SYSTEM (FOR OPERATION OF No. 00706-000 or 00707-000 ELECTRIC WINCHES OR No. 665, 670, 675 or 2080 DIVIDER CURTAIN OPERATORS)

Winch shall be controlled by a radio control system (Sportsonic® II) to eliminate complicated control wiring, wall boxes and individual key switches as on conventional remote control key switch systems. Sportsonic® II portable hand-held transmitter (5-1/2" x 3-3/8" x 1") shall be specified. The No. 12002-100 transmitter will operate up to ninety-nine individual winches. Numeric LED clearly displays selected channel. Power supply for transmitter shall be a standard 9-volt battery. Transmitter shall operate on a digitally encoded carrier frequency of 315 MHz.

Each electric winch shall be equipped with a commercial type 115 VAC receiver with a coding switch for individual operation by the portable transmitter. Receiver shall be factory wired and installed in a standard non-metallic enclosure (6" x 4" x 2-3/8") with a 6'-0" long SJ cord with a NEMA L5-15 molded twist-lock grounded plug attached. Matching flange type receptacle shall be mounted in a standard 4" square cover plate (box by others) for power supply. Enclosure shall be furnished with a 4-pole twist-lock grounded type NEMA L14-20 receptacle to accept the power/control cable from the electric winch.

Receiver shall allow for dual control of equipment (Sportsonic® II or key switch). Each radio-controlled receiver shall include an external 3-screw terminal strip for optional low voltage, key switch type control. The terminal strip shall allow for connection of low voltage, dry circuit type (5 volt maximum) key switch wires (up, down and common). Circuit board programmed EEPROM shall provide logic for an interlocking feature to eliminate conflict between radio and key switch control input. Key switch option shall be specified when a secondary or back-up method of winch operation is desired. Radio control systems without optional low voltage, key switch type control shall not be considered equal.

All units to be factory tested for a 100' (nominal) operating range. Coding switch shall be configured in field for independent operation.

Wiring of all electrical components shall be in accordance with local codes, and in accordance with manufacturer's instructions.

All conduit, wiring, junction boxes and components not specified herein shall be furnished and installed by the electrical contractor.

PARTS LIST — No. 12002-250	
No.	QTY.
1	1
2	1
3	1
4	2
5	1
6	1

DESCRIPTION	
1	XELC 12002 210 SPORTSONIC® II RECEIVER
2	ELEC 00084 000 3-POLE TWIST-LOCK RECEPTACLE
3	ELEC 00126 000 1/2" DEEP COVER PLATE
4	ELEC 00221 002 CABLE TIE 14" LG. — BLACK
5	ELEC 00086 000 KEY SWITCH ASSEMBLY — 1 SWITCH
6	12002 100 SPORTSONIC® II TRANSMITTER — 99 POSITIONS

SPECIFY QUANTITY OF SPORTSONIC® II TRANSMITTERS REQUIRED	
1	1
2	1
3	1
4	2
5	1
6	1

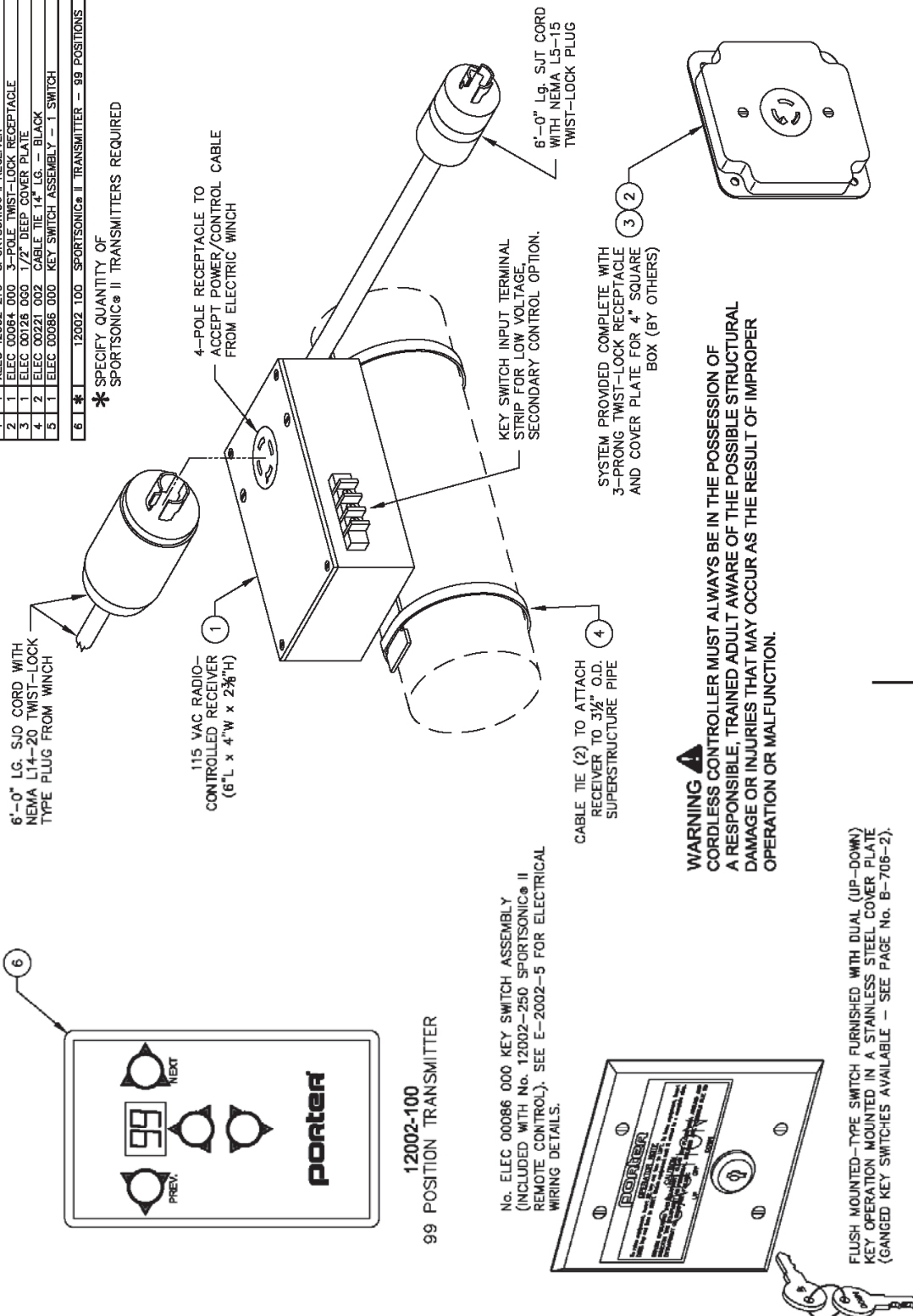

WARNING
CORDLESS CONTROLLER MUST ALWAYS BE IN THE POSSESSION OF A RESPONSIBLE, TRAINED ADULT AWARE OF THE POSSIBLE STRUCTURAL DAMAGE OR INJURIES THAT MAY OCCUR AS THE RESULT OF IMPROPER OPERATION OR MALFUNCTION.

SPORTSONIC® II RECEIVER
(WITH AUXILIARY KEY SWITCH CONTROL)
ONE REQUIRED AT EACH BACKSTOP
OR DIVIDER CURTAIN WINCH LOCATION

— **12002-250**
(QTY. REQUIRED)

SPORTSONIC® II TRANSMITTER
OPERATES UP TO 99 INDIVIDUAL UNITS

— **12002-100**
(QTY. REQUIRED)

REVISION	DATE	Porter No.
1	11-11-2013	ESJ
2		
3		
4		
5		
6		

© COPYRIGHT 2002 PORTER ATHLETIC EQUIPMENT CO. ALL RIGHTS RESERVED

DATE
3-1-2002

SPORTSONIC® II SPORTS COMPLEX CONTROL SYSTEM FOR BASKETBALL BACKSTOPS OR GYMNASIUM DIVIDER CURTAINS

THIS PRINT IS THE PROPERTY OF PORTER ATHLETIC EQUIPMENT COMPANY AND MAY NOT BE REPRODUCED WITHOUT WRITTEN PERMISSION

porter
WORLD LEADER
IN QUALITY SPORTS EQUIPMENT
601 Mercury Drive
Champaign, Illinois 61822
www.porterathletic.com

DRAWING BY TJK
CHECKED BY ES
PAGE No. B-2002-250

SPECIFICATIONS

PORTER No. 12002-250 SPORTSONIC® II SPORTS COMPLEX CONTROL SYSTEM (FOR OPERATION OF No. 00706-000 or 00707-000 ELECTRIC WINCHES OR No. 665, 670, 675 or 2080 DIVIDER CURTAIN OPERATORS) With DUAL CONTROL OPTION (SPORTSONIC® II or KEY SWITCH)

Winch shall be controlled by a radio control system (Sportsonic® II) to eliminate complicated control wiring, wall boxes and individual key switches as on conventional key switch systems. Sportsonic® II portable hand-held transmitter (5-1/2" x 3-3/8" x 1") shall be specified. The No. 12002-100 transmitter will operate up to ninety-nine individual winches. Numeric LED clearly displays selected channel. Power supply for transmitter shall be a standard 9-volt battery. Transmitter shall operate on a digitally encoded carrier frequency of 315 MHz.

Each electric winch shall be equipped with a commercial type 115 VAC receiver with a coding switch for individual operation by the portable transmitter. Receiver shall be factory wired and installed in a standard non-metallic enclosure (6" x 4" x 2-3/8") with a 6'-0" long SJT cord with a NEMA L5-15 molded twist-lock grounded plug attached. Matching flange type receptacle shall be mounted in a standard 4" square cover plate (box by others) for power supply. Enclosure shall be furnished with a 4-pole twist-lock grounded type NEMA L14-20 receptacle to accept the power/control cable from the electric winch.

Receiver shall allow for dual control of equipment (Sportsonic® II or key switch). Each radio-controlled receiver shall include an external 3-screw terminal strip for optional low voltage, key switch type control. The terminal strip shall allow for connection of low voltage, dry circuit type (5 volt maximum) key switch wires (up, down and common). Circuit board programmed EEPROM shall provide logic for an interlocking feature to eliminate conflict between radio and key switch control input. Key switch option shall be specified when a secondary or back-up method of winch operation is desired. Radio control systems without optional low voltage, key switch type control shall not be considered equal.

All units to be factory tested for a 100' (nominal) operating range. Coding switch shall be configured in field for independent operation.

Wiring of all electrical components shall be in accordance with local codes, and in accordance with manufacturer's instructions.

All conduit, wiring, junction boxes and components not specified herein shall be furnished and installed by the electrical contractor.

SPORTSONIC® II

INSTALLATION AND OPERATING INSTRUCTIONS

PARTS LIST

Item No.	Part No.	12002-200 Quantity	12002-250 Quantity	Description
1	XELC 12002 200	1	1	Sportsonic® II Receiver **
2	ELEC 00064 000	1	1	3-Prong Twist-Lock Receptacle
3	ELEC 00126 0G0	1	1	1/2" deep Cover Plate
4	ELEC 00221 002	1	1	Cable Tie 14" Lg. - Black
5	12002-100	*	*	Sportsonic® Transmitter – 99 Positions
6	ELEC 00086 000		1	Key Switch Assembly

* Quantity of Sportsonic® II Transmitters to be specified

** One Sportsonic® II Receiver required per device to be controlled.

1. Establish backstop or divider curtain operating code numbers (1 thru 99). Use numbers on floor plan drawing if available – Main court #1 and 2, Cross Courts #3, 4, 5, 6, etc. Suggest marking backstops with operating numbers to avoid confusion.
2. At the cord connector end of Sportsonic® II receiver enclosure, rotate small cover up, to expose DIP switch window. Locate receiver DIP switch module inside enclosure window (small black plastic module with white slide tabs numbered 1 thru 7). Set the receiving code module on each receiver per the following chart. As each box is set and DIP switch cover closed, write the operating identification number (1 thru 99) on the outside of the box.

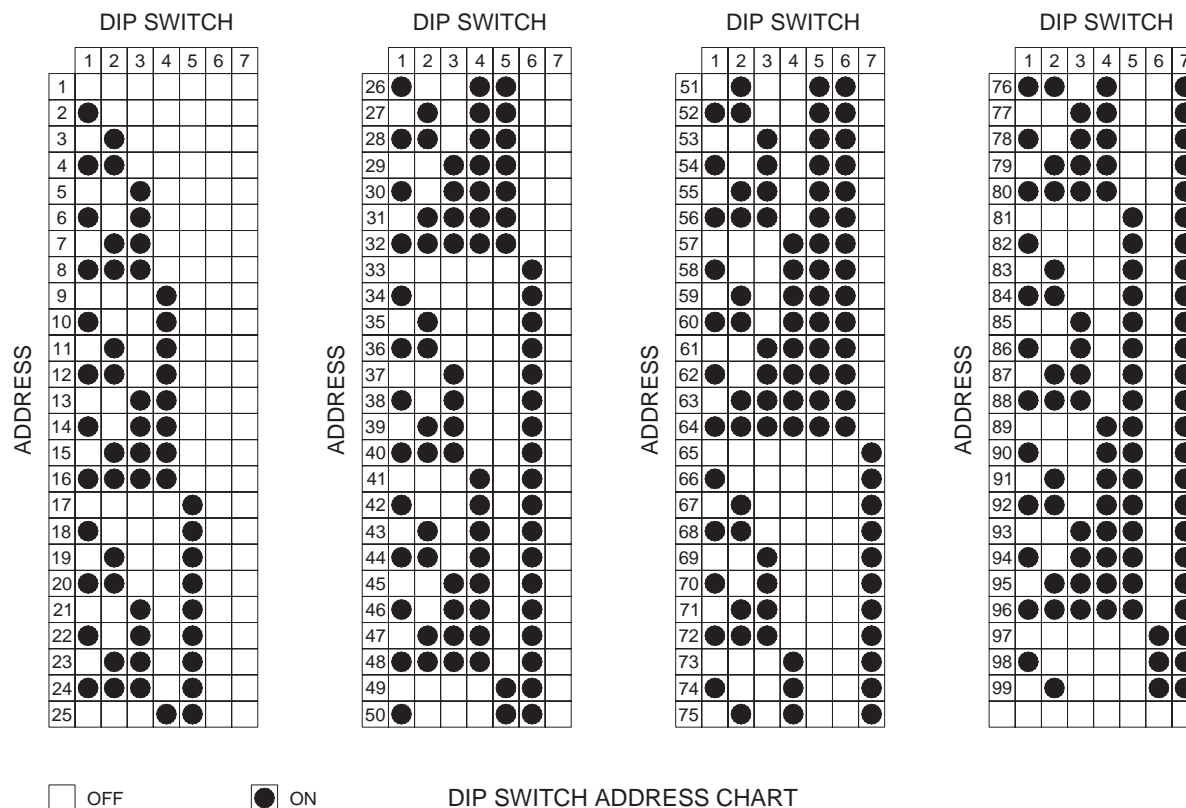

ADDRESS No. 1



ADDRESS No. 2



ADDRESS No. 3

DIP SWITCH SETTING EXAMPLES

3. Install each control receiver (1) on the corresponding numbered backstop or gymnasium divider support structure as shown on installation print, within 3'-0" of the electric winch that it is to control. Use the cable ties (4) provided to attach enclosure mounting strap to 3-1/2" O.D. superstructure pipe as shown below. Two (2) #10 screws (not provided) may be used to attach to wood or other type framing structures if necessary.

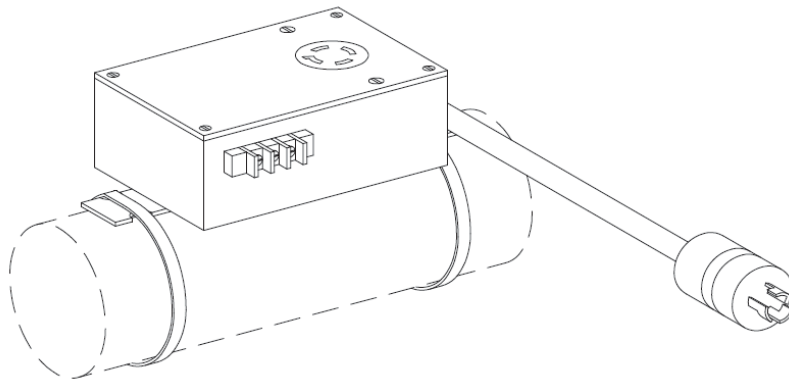

TYPICAL 3½" O.D.
SUPERSTRUCTURE ATTACHMENT

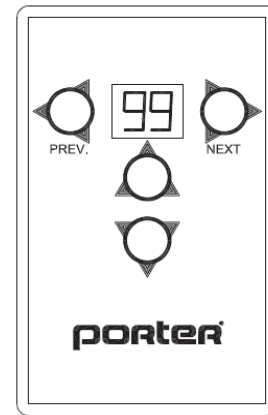

12002-100
TRANSMITTER

After receiver is mounted, double-check to ensure that the control box number corresponds to the number marked on the equipment (1 to 1, 2 to 2, etc.).

4. Plug 4-prong twist-lock plug from electric winch into control receiver box (1). Plug 3-prong twist-lock power cord from the control receiver box into the power source (115 volt, single phase, 60 cycle), using the 3-prong twist-lock receptacle (2) and 1/2" deep cover plate (3) provided.
5. With the basketball backstop or gymnasium divider curtain in the down position, test the operation of the unit with the No. 12002-100 portable transmitter control unit.

CAUTION! – Always keep hands away from the V-belts and pulleys when operating unit.

- A. Set selector display (1 thru 99) to position 1 by pressing the next button. The numeric LED will illuminate displaying the address "01" (see illustration above).
- B. Press "RAISE" button - backstop or gym divider curtain marked No. 1 should begin up cycle.
- C. Set rotary counting limit switches per winch installation instructions.
- D. Repeat steps A thru C for all units.
6. All units must be tested through a complete up/down cycle before leaving the jobsite, to ensure proper operation with the portable transmitter control unit AND limit switch settings.
7. If the transmitter does not activate one or more of the winch units, double-check the coding switch settings.
8. If the receiver is in the proximity of a metal beam or other obstruction, it may be necessary to relocate the receiver to increase the operating range.
9. Should intermittent operation develop:
 - A. Stand closer to the basketball backstop or gym divider curtain receiver unit.
 - B. Replace the battery in the portable transmitter control unit (standard 9-volt alkaline battery).
10. Place the portable transmitter control unit(s) **and this INSTALLATION & OPERATION MANUAL** in the possession of an authorized staff member from the electrical contractor, general contractor, or the school, and demonstrate the operation of the system.

KEY SWITCH WIRING HOOK-UP (12002-250 Receiver Only)

The 12002-250 receiver allows for dual control of equipment (Sportsonic® II or key switch). An external 3-screw terminal strip for optional low voltage, key switch type control is provided on the radio receiver. The terminal strip allows for connection of low voltage, dry circuit type (5 volt maximum) key switch wires (up, down and common). Refer to the diagram below for wiring details.

Note: Do not connect high voltage key switch wires to the receiver terminals. Introduction of powered key switch wires at the terminal strip will permanently damage the receiver.

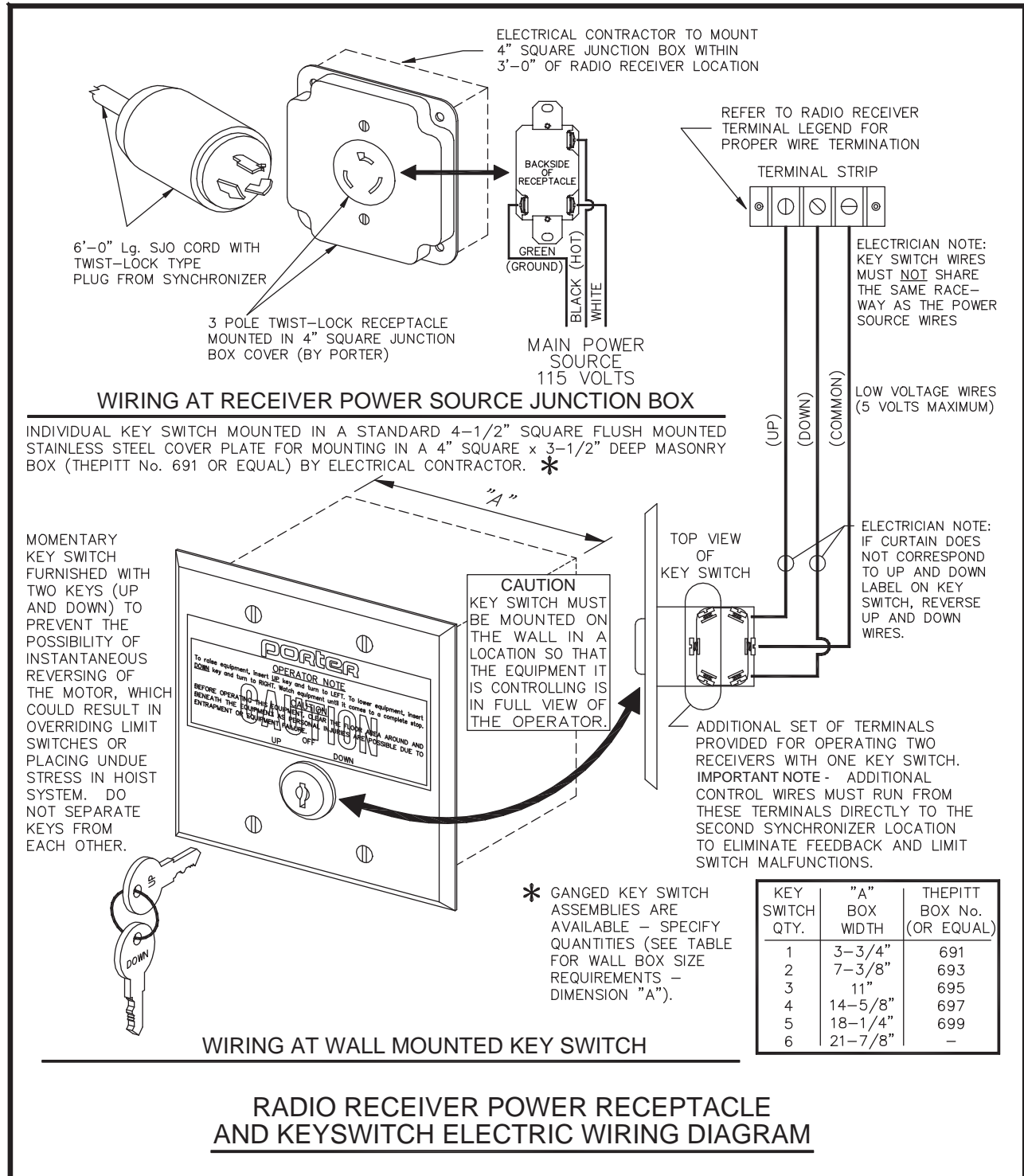

SPORTSONIC® II

OWNER'S OPERATING INSTRUCTIONS

Your gymnasium is equipped with SPORTSONIC® II remote control device for the operation of the electrically powered basketball backstops and/or gymnasium divider curtains. This device eliminates conventional key switch boxes on the wall of the gymnasium.

CORDLESS CONTROLLER DESCRIPTION

The cordless controller is a battery-operated, radio-controlled transmitter that is coded to the basketball backstops or gymnasium divider curtains in your facility. You may wish to place numbers on the equipment to facilitate identifying which number on the controller corresponds to which piece of equipment. A wall plaque showing the gym floor plan, displaying the equipment numbers may also be helpful.

TO OPERATE UNIT

Set selector display (1 thru 99) to position 1 by pressing the next button. The numeric LED will illuminate displaying the address "01" (see illustration below). To control higher numbered equipment, press the next or previous button until the desired address is reached. **Note:** The transmitter will automatically shut down after 30 seconds of inactivity and revert back to address "01" on next use.

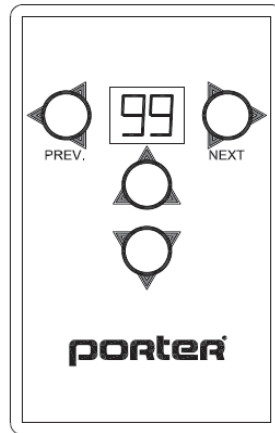

12002-100
TRANSMITTER

Stand within 50 feet of unit number 1.

To raise the unit, press the "RAISE" button and hold during the up cycle until the limit switch stops the unit.

To lower the unit, press the "LOWER" button and hold during the down cycle until the limit switch stops the unit.

To stop the operation of the unit, release the button.

To reverse the operation of the unit, allow the unit to come to a complete stop.

Repeat above steps to operate the other units.

CAUTION! - This equipment is equipped with up and down limit controls. However, the staff member operating the system must remain in full view of the equipment being operated ready to RELEASE the button should any mechanical or electrical malfunctions occur. It is imperative that all individuals be cleared from the area beneath the equipment to avoid injury should such malfunctions occur.

The battery in the cordless controller is replaced by removing the battery cover plate located on the back of the unit. Use a standard 9-volt alkaline battery for replacement.

Spare batteries or even a spare cordless controller is recommended to ensure that a back-up system is available at all times. A spare cordless controller may be ordered as follows:

No. 12001-100 SPORTSONIC® II TRANSMITTER - 99 POSITIONS

Contact your nearest distributor or Porter Athletic Equipment Company when ordering.

TROUBLE SHOOTING

- Check the 9-volt battery in cordless controller.
- Check to ensure that power is available at all winches. A fuse or circuit breaker may have opened the circuit without your knowledge.
- Check that all plugs are seated firmly in their respective receptacles.
- Verify that the selected equipment to operate corresponds with LED address setting on the Sportsonic® II transmitter.

WARNING

NEVER operate unit with individuals standing on the floor, in bleachers, etc. in the area of the unit being operated.

Operator must stand within full view (within 50 feet) of the unit being operated.

Should any unusual noise or sudden movement of the unit develop during the up or down cycles, halt operation immediately until unit is checked by a trained technician, and the problem has been corrected.

Cordless controller must always be in the possession of a responsible, trained adult aware of the possible structural damage or injuries that may occur as the result of improper operation or malfunction.

LIMITED 1-YEAR WARRANTY ON SPORTSONIC® II PRODUCTS

Porter Athletic warrants Sportsonic® II products to be free from defective material and workmanship for a period of one (1) year from original date of purchase at retail. Porter Athletic agrees to repair or replace, at its sole discretion, a defective Sportsonic® II product if returned to Porter Athletic within the warranty period and accompanied by proof of purchase.

If service is required under this warranty:

1. Call or write to Porter Athletic, Inc. for a Return Merchandise Authorization number to be affixed to returned packaging. (This RMA number will also be your reference number).
2. Return defective unit, postage or freight prepaid, to:
Porter Athletic, Inc.
601 Mercury Drive
Champaign, Illinois 61822
3. Enclose dated proof of purchase.
4. Enclose check or money order for \$2.00 to cover handling and return postage.
5. Make sure all return authorization number labels are affixed to all packages being returned.
6. Porter Athletic, Inc. is not responsible for shipping damage. Units to be returned should be packed carefully.

This warranty does not extend to any Sportsonic® II products which have been subject to misuse, neglect, accident, incorrect wiring, or to use in violation of operating instructions furnished by us, nor other than an authorized service agency or Porter Athletic factory. This warranty does not cover any incidental or consequential damages and is in lieu of all other warranties expressed or implied, and no representative or person is authorized to assume for us any other liability in connection with the sale of our products.

Some states do not allow limitations on how long an implied warranty lasts, and/or the exclusion or limitation of incidental or consequential damages, so the above limitations or exclusions may not apply to you. This warranty gives you specific rights, and you may also have other rights, which vary from state to state.

If you have any questions, please call our Customer Service Department at (800) 637-3090.

THE OWNER OF THIS EQUIPMENT MUST SAVE THESE
INSTRUCTIONS FOR FUTURE REFERENCE,
AND TO ORDER REPLACEMENT PARTS

 **WARNING:** Cancer and Reproductive Harm –
For more information go to www.p65warnings.ca.gov

porter[®]

Porter Athletic Equipment Company
601 Mercury Drive, Champaign, IL U.S.A., 61822
www.porterathletic.com
(888) 277-7778