

12002-200 - SPORTSONIC II RECEIVER

RADIO CONTROL SYSTEM FOR ELECTRIC WINCHES

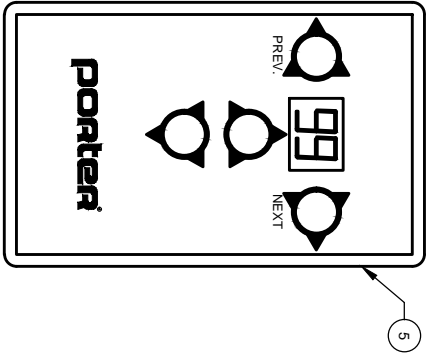

12002-100
99 POSITION TRANSMITTER

WARNING
CORDLESS CONTROLLER MUST ALWAYS BE IN THE POSSESSION OF A RESPONSIBLE, TRAINED ADULT AWARE OF THE POSSIBLE STRUCTURAL DAMAGE OR INJURIES THAT MAY OCCUR AS THE RESULT OF IMPROPER OPERATION OR MALFUNCTION.

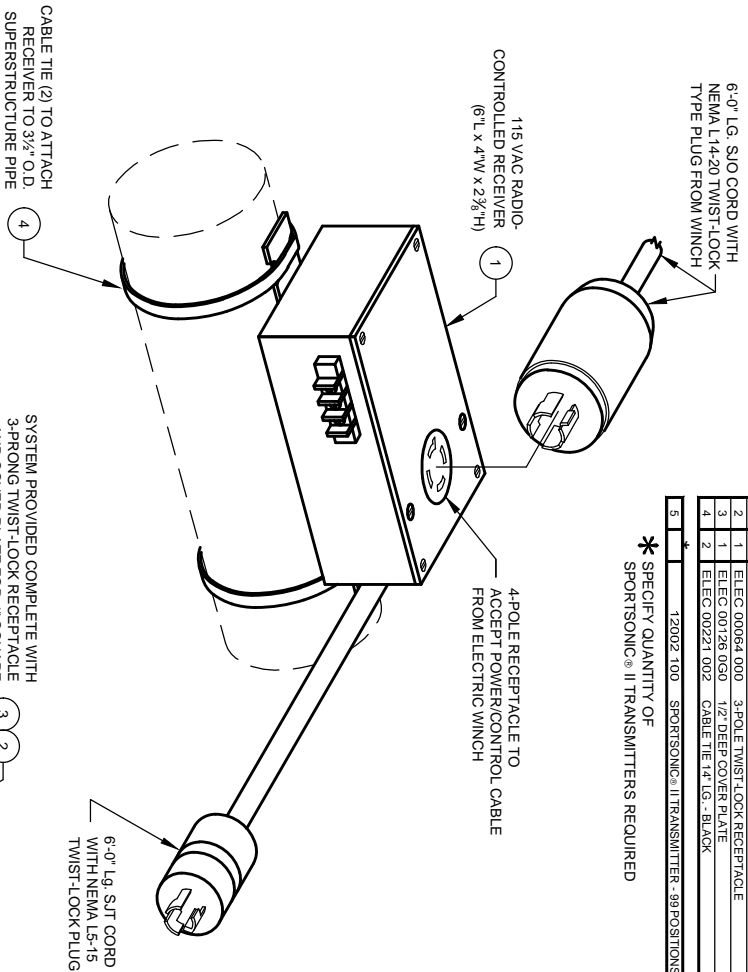

6'-0" LG. SJO CORD WITH
NEMA L14-20 TWIST-LOCK
TYPE PLUG FROM WINCH

115 VAC RADIO-
CONTROLLED RECEIVER
(6" L x 4" W x 2 3/4" H)

4-POLE RECEPTACLE TO
ACCEPT POWER/CONTROL CABLE
FROM ELECTRIC WINCH

CABLE TIE (2) TO ATTACH
RECEIVER TO 3/4" O.D.
SUPERSTRUCTURE PIPE

SYSTEM PROVIDED COMPLETE WITH
3-PRONG TWIST-LOCK RECEPTACLE
AND COVER PLATE FOR 4" SQUARE
BOX (BY OTHERS)

6'-0" LG. SJO CORD
WITH NEMA LS-15
TWIST-LOCK PLUG

* SPECIFY QUANTITY OF
SPORTSONIC® II TRANSMITTERS REQUIRED

PARTS LIST - No. 12002-200		
No.	QTY.	DESCRIPTION
1	1	XELC 12002 200 SPORTSONIC® II RECEIVER
2	1	ELEC 00064 000 3-POLE TWIST-LOCK RECEPTACLE
3	1	ELEC 00126 050 1/2" DEEP COVER PLATE
4	2	ELEC 00221 002 CABLE TIE 14" LG. - BLACK
5	*	12002-100 SPORTSONIC® II TRANSMITTER - 99 POSITIONS

____ 12002-100 SPORTSONIC® II TRANSMITTER
(QTY. REQUIRED) OPERATES UP TO 99 INDIVIDUAL UNITS

____ 12002-200 SPORTSONIC® II RECEIVER
(QTY. REQUIRED) ONE REQUIRED AT EACH BACKSTOP OR DIVIDER CURTAIN WINCH LOCATION

12002-200 - SPORTSONIC II RECEIVER

RADIO CONTROL SYSTEM FOR ELECTRIC WINCHES

SPECIFICATIONS

PORTER No. 2002 SPORTSONIC® II SPORTS COMPLEX CONTROL SYSTEM (FOR OPERATION OF No. 00706-000 or 00707-000 ELECTRIC WINCHES OR No. 665, 670, 675 or 2080 DIVIDER CURTAIN OPERATORS)

(Delete wall-mounted key switch on winch specifications and add following)

Winch shall be controlled by a radio control system (Sportsonic® II) to eliminate complicated control wiring, wall boxes and individual key switches as on conventional key switch systems. Sportsonic® II portable hand-held transmitter (5-1/2" x 3-3/8" x 1") shall be specified. The No. 12002-100 transmitter will operate up to ninety-nine individual winches. Numeric LED clearly displays selected channel. Power supply for transmitter shall be a standard 9-volt battery. Transmitter shall operate on a digitally encoded carrier frequency of 315 MHz.

Each electric winch shall be equipped with a commercial type 115 VAC receiver with a coding switch for individual operation by the portable transmitter. Receiver shall be factory wired and installed in a standard non-metallic enclosure (6" x 4" x 2-3/8") with a 6'-0" long SJT cord with a NEMA L5-15 molded twist-lock grounded plug attached. Matching flange type receptacle shall be mounted in a standard 4" square cover plate (box by others) for power supply. Enclosure shall be furnished with a 4-pole twist-lock grounded type NEMA L14-20 receptacle to accept the power/control cable from the electric winch.

All units to be factory tested for a 100' (nominal) operating range. Coding switch shall be configured in field for independent operation.

Wiring of all electrical components shall be in accordance with local codes, and in accordance with manufacturer's instructions.

All conduit, wiring, junction boxes and components not specified herein shall be furnished and installed by the electrical contractor.