

00791-1X2 - KEY SWITCH ASSEMBLY

KEY SWITCH CONTROL For ELECTRIC WINCHES

No. XELE 00791 112 SHOWN
SINGLE KEY SWITCH WITH ELECTRICAL HOOK-UP
(INCLUDED WITH WINCH UNLESS SPECIFIED WITH
SPORTSONIC® II REMOTE CONTROL, OR
POWR-TOUCH® KEY PAD SYSTEM)

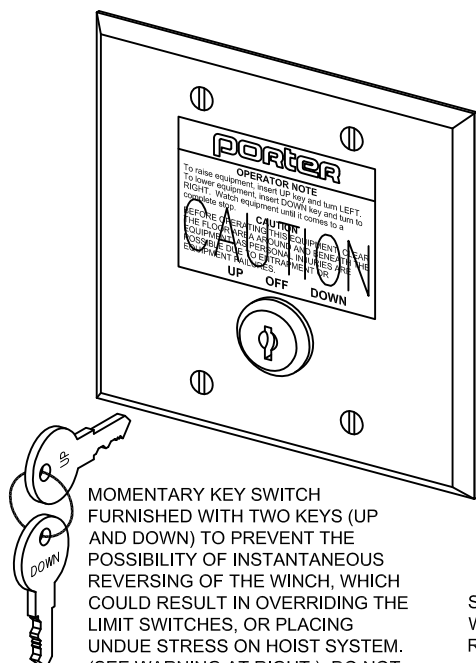

MOMENTARY KEY SWITCH
FURNISHED WITH TWO KEYS (UP
AND DOWN) TO PREVENT THE
POSSIBILITY OF INSTANTANEOUS
REVERSING OF THE WINCH, WHICH
COULD RESULT IN OVERRIDING THE
LIMIT SWITCHES, OR PLACING
UNDUE STRESS ON HOIST SYSTEM.
(SEE WARNING AT RIGHT.) DO NOT
SEPARATE KEYS FROM EACH
OTHER.

SHOWN ON THIS PAGE IS AN INDIVIDUAL KEY SWITCH MOUNTED IN A
STANDARD 4½" SQUARE FLUSH-MOUNTED STAINLESS STEEL COVER PLATE,
FOR MOUNTING IN A 4" SQUARE x 3½" DEEP MASONRY BOX (RACO No. 696 Or
Equal) BY ELECTRICAL CONTRACTOR.

GANGED KEY SWITCH ASSEMBLIES ARE AVAILABLE. SEE PAGE No. E-791-3
TO INDICATE CONFIGURATION. SEE TABLE ON PAGE No. E-791-2 FOR WALL
BOX SIZE REQUIREMENTS.

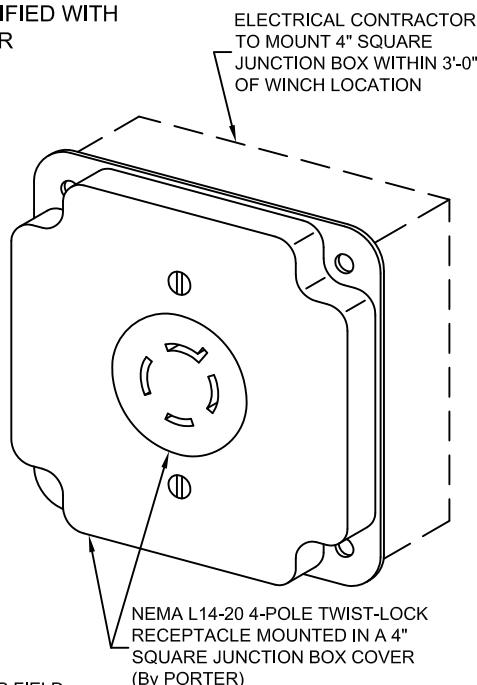

SEE PAGE No. E-791-2 FOR FIELD
WIRING DETAILS AND
REQUIREMENTS.

WARNING

SUBSTITUTION OF THIS KEY SWITCH
WILL **VOID** ALL WARRANTIES AND
MAY INHIBIT UP / DOWN LIMIT
SWITCH OPERATION, RENDERING
THE OPERATION OF BACKSTOPS,
CURTAINS, ETC. UNSAFE.

CAUTION

KEY SWITCH MUST BE MOUNTED ON
THE WALL IN A LOCATION SO THAT
THE EQUIPMENT IT IS CONTROLLING
IS IN FULL VIEW OF THE OPERATOR.

- XELE 00791 112 KEY SWITCH ASSEMBLY: 1 SWITCH ON A 2-GANG PLATE
With RECEPTACLE (1) AND COVER PLATE (1)
- XELE 00791 122 KEY SWITCH ASSEMBLY: 2 SWITCHES ON A 4-GANG PLATE
With RECEPTACLE (2) AND COVER PLATE (2)
- XELE 00791 132 KEY SWITCH ASSEMBLY: 3 SWITCHES ON A 6-GANG PLATE
With RECEPTACLE (3) AND COVER PLATE (3)
- XELE 00791 142 KEY SWITCH ASSEMBLY: 4 SWITCHES ON A 8-GANG PLATE
With RECEPTACLE (4) AND COVER PLATE (4)
- XELE 00791 152 KEY SWITCH ASSEMBLY: 5 SWITCHES ON A 10-GANG PLATE
With RECEPTACLE (5) AND COVER PLATE (5)
- XELE 00791 162 KEY SWITCH ASSEMBLY: 6 SWITCHES ON A 12-GANG PLATE
With RECEPTACLE (6) AND COVER PLATE (6)

Porter®

888-277-7778 PORTER@PORTERATHLETIC.COM
© COPYRIGHT 2014 PORTER ATHLETIC - ALL RIGHTS RESERVED

PROJECT NUMBER

PROJECT NAME

Porter

WWW.PORTERATHLETIC.COM/FACILITY

KEY SWITCH SPECIFICATION SHEET

E-791

6/24/2014

00791-1X2 - KEY SWITCH ASSEMBLY

KEY SWITCH CONTROL For ELECTRIC WINCHES

SPECIFICATIONS

PORTER No. 791 KEY SWITCH CONTROL For ELECTRIC WINCHES

The winch motor shall be controlled by a special dual keyed, flush wall-mounted momentary key switch which cannot be instantly reversed, providing a safety provision so as not to damage motor or winch. Switch assembly shall be furnished with a 4-1/2" square stainless steel cover plate for mounting in a masonry wall box by the electrical contractor. (Optional ganged key switch assemblies are available – refer to field wiring details – specify requirements).

Wiring of all electrical components shall be in accordance with local area codes, and in accordance with manufacturer's instructions.

All conduit, wiring, junction boxes and components not specified herein shall be furnished and installed by the electrical contractor.

Porter
WWW.PORTERATHLETIC.COM/FACILITY

KEY SWITCH SPECIFICATION SHEET

E-791

00791-1X2 - WIRING DETAIL

ELECTRIC WINCHES With KEY SWITCH CONTROL

PORTER

WWW.PORTERATHLETIC.COM/FACILITY

WIRING DETAIL & REQUIREMENTS SHEET

E-791-2

6/24/2014

ELECTRIC WINCH FIELD WIRING DETAILS & REQUIREMENTS

ELECTRICAL CONTRACTOR TO MOUNT
4" SQUARE JUNCTION BOX WITHIN
3'-0" OF WINCH LOCATION

** The minimum wire size is dependent on the motor voltage, motor full-load amperage rating, and the **TOTAL** distance from the circuit breaker panel to the winch receptacle. Consult **VOLTAGE DROP CALCULATION TABLES** to determine the minimum wire size.

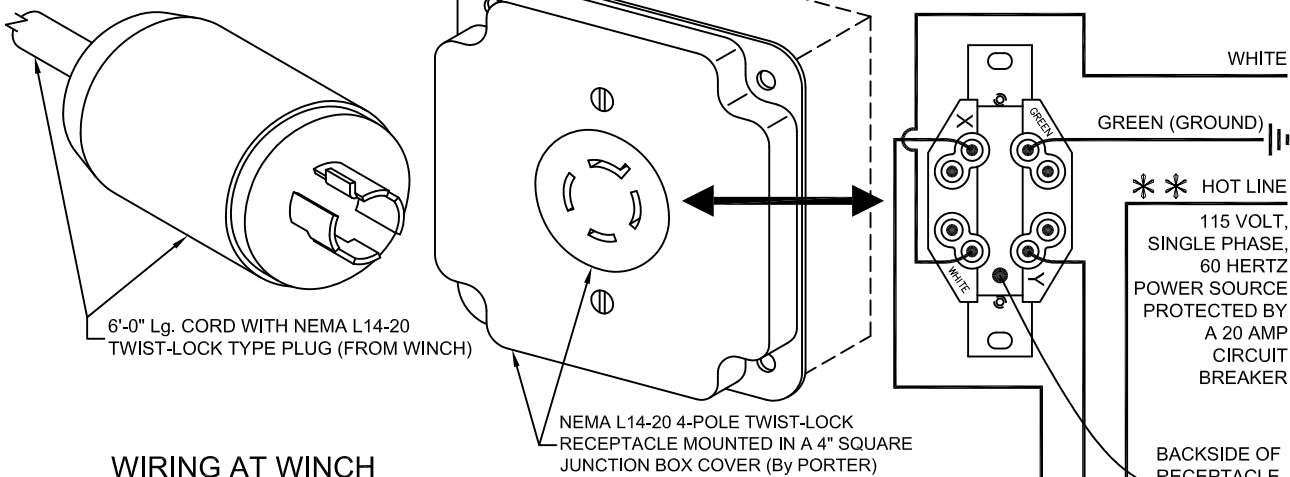

WIRING AT WINCH

INDIVIDUAL KEY SWITCH MOUNTED IN A STANDARD 4½" SQUARE FLUSH-MOUNTED STAINLESS STEEL COVER PLATE FOR MOUNTING IN A 4" SQUARE x 3½" DEEP MASONRY BOX (RACO No. 696 OR EQUAL) BY ELECTRICAL CONTRACTOR. *

MOMENTARY KEY SWITCH FURNISHED WITH TWO KEYS (UP AND DOWN) TO PREVENT THE POSSIBILITY OF INSTANTANEOUS REVERSING OF THE WINCH, WHICH COULD RESULT IN OVERRIDING THE LIMIT SWITCHES, OR PLACING UNDUE STRESS ON HOIST SYSTEM. DO NOT SEPARATE KEYS FROM EACH OTHER.

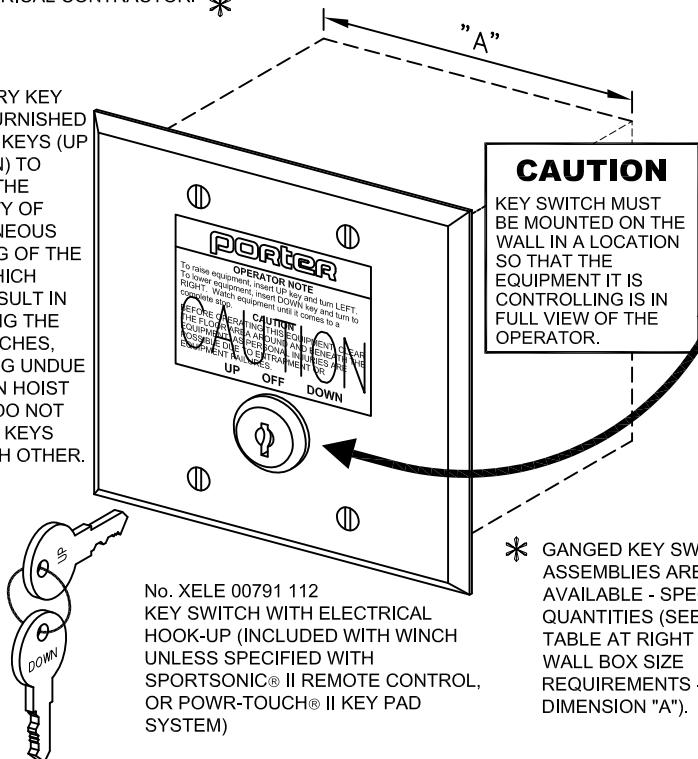

WIRING AT WALL MOUNTED KEY SWITCH

IMPORTANT NOTE - PERFORMANCE OF WINCH IS BASED ON 115 VOLTS AT MOTOR TERMINALS. VOLTAGES LESS THAN 115 VOLTS WILL AFFECT HOISTING CAPACITY AND RESULT IN DAMAGE TO MOTOR, THUS VOIDING WARRANTY. **SUBSTITUTION** OF THIS KEY SWITCH WILL VOID ALL WARRANTIES AND WILL RENDER THE OPERATION OF BACKSTOPS / CURTAINS UNSAFE.

KEY SWITCH QTY.	"A" BOX WIDTH	RACO MASONRY BOX No. (Or Equal)	RACO GANGABLE BOX No. (Or Equal)
1	3¾"	696	592 Qty. 2
2	7⅞"	698	592 Qty. 4
3	11"	965	592 Qty. 6
4	14⅝"	N/A	592 Qty. 8
5	18¼"	N/A	592 Qty. 10
6	21⅞"	N/A	592 Qty. 12

PORTER®

888-277-7778 PORTER@PORTERATHLETIC.COM
© COPYRIGHT 2014 PORTER ATHLETIC - ALL RIGHTS RESERVED

PROJECT NUMBER

PROJECT NAME

AVAILABLE GANGED KEY SWITCHES – SPECIFY
 FIELD NOTE - IF GANGED PLATE REQUIREMENT IS NOT SPECIFIED, THE
 INDIVIDUAL KEY SWITCH ASSEMBLY WILL BE PROVIDED WITH EACH ELECTRIC WINCH.

INDIVIDUAL KEY SWITCH ASSEMBLY
 SUPPLIED AS STANDARD
 1 KEY SWITCH, 2-GANG BOX
 (MAXIMUM = 1 BACKSTOP)

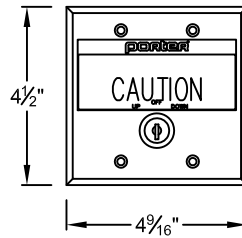

ASSEMBLY PART No.
 XELE 00791 112

2 KEY SWITCH, 4-GANG BOX
 (MAXIMUM = 2 BACKSTOPS)

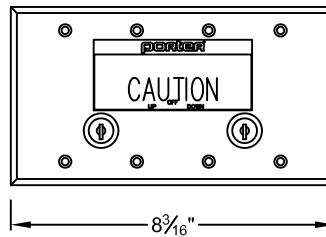

ASSEMBLY PART No.
 XELE 00791 122

3 KEY SWITCH, 6-GANG BOX
 (MAXIMUM = 3 BACKSTOPS)

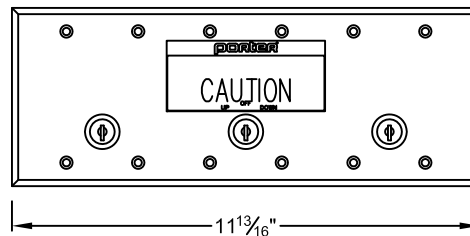

ASSEMBLY PART No.
 XELE 00791 132

4 KEY SWITCH, 8-GANG BOX
 (MAXIMUM = 4 BACKSTOPS)

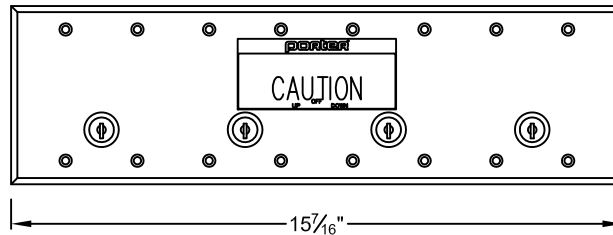

ASSEMBLY PART No.
 XELE 00791 142

5 KEY SWITCH, 10-GANG BOX
 (MAXIMUM = 5 BACKSTOPS)

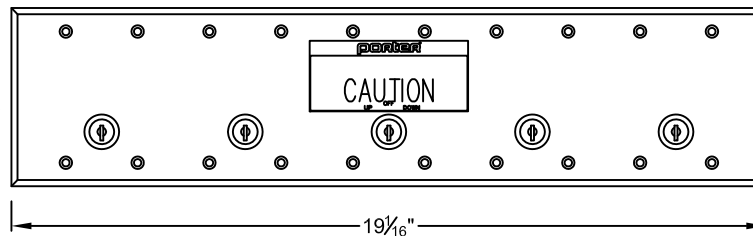

ASSEMBLY PART No.
 XELE 00791 152

6 KEY SWITCH,
 12-GANG BOX
 (MAXIMUM =
 6 BACKSTOPS)

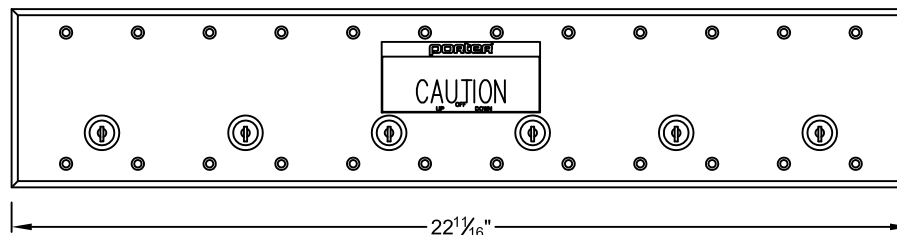

ASSEMBLY PART No.
 XELE 00791 162

PORTER RECOMMENDS THE USE OF "DOUBLE" GANG SPACING (AS ILLUSTRATED) PER SINGLE SWITCH, TO PROVIDE ADEQUATE CLEARANCE FOR WIRING WITHIN THE ELECTRICAL BOX.