

91920100 - POWR-NET VOLLEYBALL SYSTEM

ELECTRIC HEIGHT ADJUSTERS, OPTIONAL EQUIPMENT:

- _____ - FRME1920208, ELECTRIC NET HEIGHT ADJUSTER WITH WINCH
- _____ - FRME1920308, ELECTRIC NET HEIGHT ADJUSTER WITH TIE-OFF
- _____ - FITG1920101, HT. ADJ. ATTACHMENT HARDWARE TO MAST
- _____ - FITG1920102, HT. ADJ. ATTACHMENT HARDWARE TO JUDGE'S STAND
- _____ x _____ - 1922XX, PAD SET FOR HT. ADJ. WITH WINCH, MAST ATTACHMENT
- _____ x _____ - 1923XX, PAD SET FOR HT. ADJ. WITH TIE-OFF, MAST ATTACHMENT
- _____ x _____ - 1924XX, PAD SET FOR HT. ADJ. WITH TIE-OFF, JUDGE'S ATTACHMENT
- _____ x _____ - 1925XX, PAD SET JUDGE'S STAND

*XX indicates color choice, please see color chart for current color choices. Enter quantity in left-hand space and part number (with color) in the right-hand space.

FRME1920208 SHOWN WITH FITG1920101

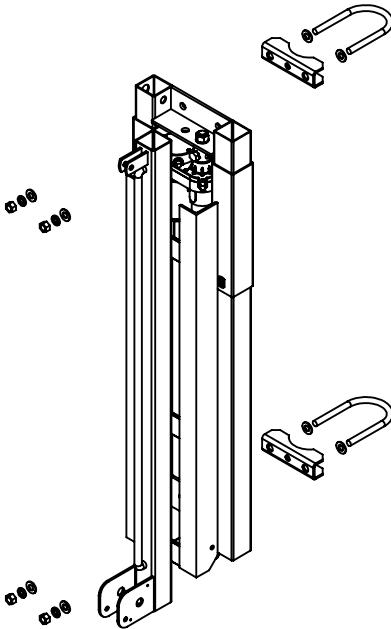

FRME1920308 SHOWN WITH FITG1920102

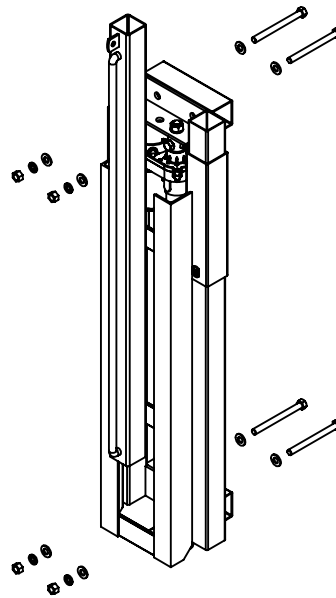

91920100 - POWR-NET VOLLEYBALL SYSTEM

OVERHEAD VOLLEYBALL ELECTRIC HEIGHT ADJUSTERS

SPECIFICATIONS

Height adjustment unit be designed for use with No. 91910100, 91910200, and 91920100 overhead volleyball systems to allow for electronic adjustment of the height of the net assembly. Each height adjuster frame shall be fitted with a net-tensioning winch (Powr-Winch), incorporating a heavy-duty, selflocking ratchet mechanism with a compression, disc-brake type release mechanism to eliminate sudden release of the cable tension when removing the net. Frames shall also be furnished with a linear actuator to easily adjust the net to 7' 11-5/8" (2.43m), 7' 4-1/8" (2.24m), 7'-0" (2.13m), and 6'-1" (1.85m) official net heights for competition without loosening the net tension. Height setting indicators shall be visible from the side of each frame.

Center unitized support frame shall be fabricated by dual, 2-3/16" square heavy wall zinc plated guide tubes located on 11-3/16" centers. Outer dual slide tubes shall support heavy structural steel angle sections which extend downward. These angles are welded to a 2-1/4" square 12 gage wall tube to which net attachment pieces are welded for easy net attachment.

Height adjustment unit shall incorporate a compact 115VAC, gear motor type linear actuator with 600 pounds thrust capacity to raise and lower the net height electrically. Motor shall draw 1.4 amps under full load. Integral limit switches shall provide automatic shut off at 8' and 6' heights.

Each actuator shall be wired to the same power source such that the frames move simultaneously. Wiring of all electrical components shall be in accordance with local area codes, and in accordance with manufacturer's instructions. All conduit, wiring, junction boxes, and components not specified herein shall be furnished and installed by the electrical contractor.

Height adjustment frame shall be finished with one coat of flat black enamel. (If painting of special colors is required, specify final painting by painting contractor.)

PADDING COLOR OPTIONS
See SMPL00048020