

# 1134 - 1135 BOOM PAD

## PORTABLE BACKSTOP BOOM PAD

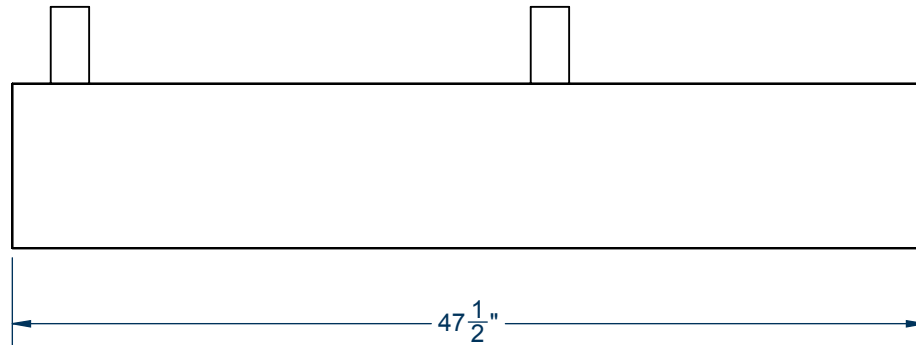
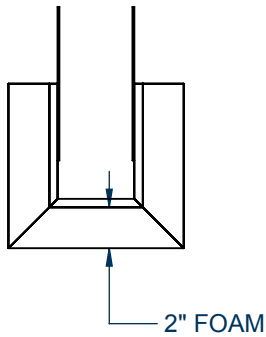
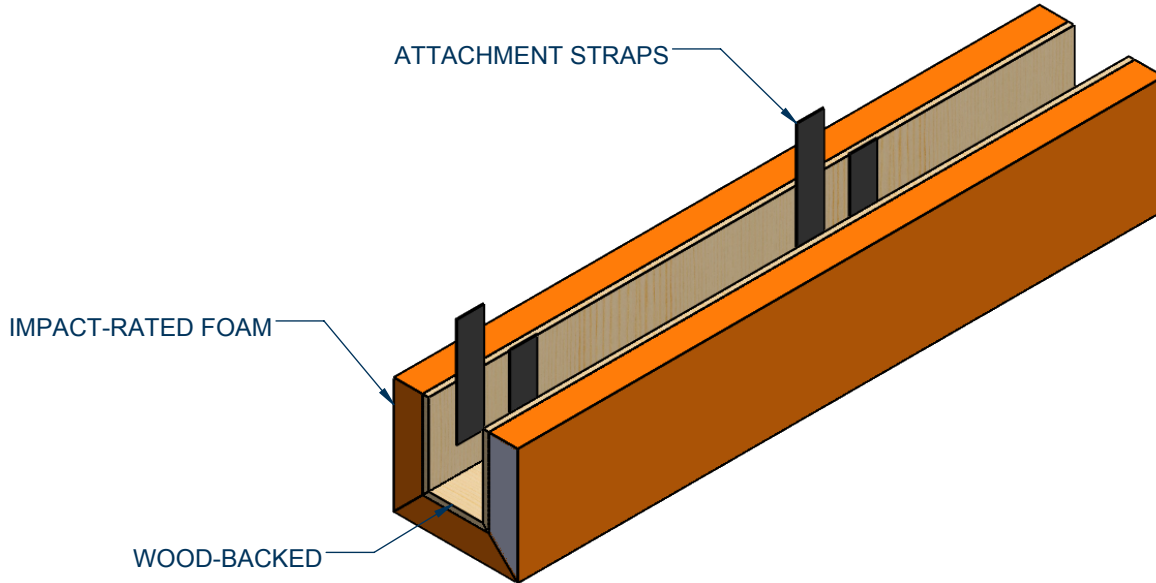

Color Selection	
01 - Light Blue	09 - Gray
02 - Royal Blue	10 - Maroon
03 - Red	11 - Purple
04 - White	12 - Black
05 - Orange	13 - Navy Blue
06 - Yellow Gold	14 - Kelly Green
08 - Tan	15 - Dark Green

\_\_\_\_\_ - 1134C \_\_\_\_\_ - 1135 BOOM PAD

PROJECT NUMBER \_\_\_\_\_

PROJECT NAME \_\_\_\_\_

# 1134 - 1135 BOOM PAD

## PORTABLE BACKSTOP BOOM PAD

### SPECIFICATIONS

#### PORTER No. 1134CXX BOOM PAD FOR 1135 PORTABLE BASKETBALL BACKSTOPS

Pad shall fit boom extension arm of 1135 basketball backstops. Pad shall consist of three pieces of 2" thick Polyurethane Foam (1.5lb density). Foam shall be bonded to three pieces of 7/16" oriented strand wood board to provide rigidity and reduce sagging or wrinkles.

Pad shall be wrapped in a heavy (19oz) fire retardent, high tensile, vinyl-coated polyester fabric material. The cover material shall have a tear strength of 100psi and shall be mildew and rot resistant and fortified with an infection combating fungicide. Vinyl covering shall be folded and stapled securely to backside of oriented strand board. Vinyl covering is available in 14 colors - see color chart for options.

Boom pad designed to meet all competition requirements of the NBA, NCAA, NFHS, and international requirements of FIBA.

 **WARNING:** This product can expose you to Wood Dust, which is known to the State of California to cause cancer. For more information go to [www.p65warnings.ca.gov](http://www.p65warnings.ca.gov).

C