



## INSTALLATION, OPERATION & MAINTENANCE MANUAL

### *HEAVY-DUTY BASKETBALL BACKSTOPS*

*No. 00195-580 – Single Extension*

*No. 00195-582 – Double Extension*

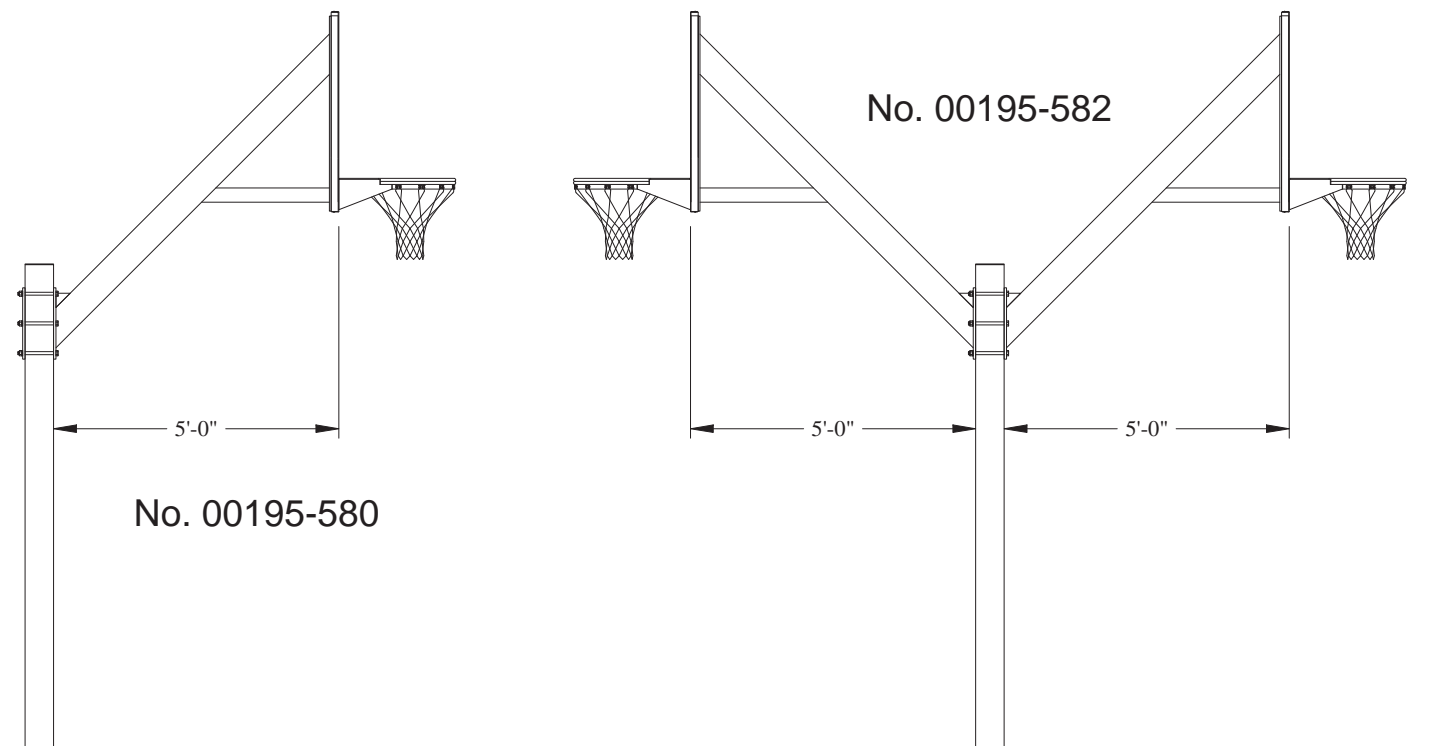

THE OWNER OF THIS EQUIPMENT MUST SAVE THESE  
INSTRUCTIONS FOR FUTURE REFERENCE,  
AND TO ORDER REPLACEMENT PARTS



## WARNING

READ ALL WARNINGS THOROUGHLY BEFORE USING THIS EQUIPMENT.

FAILURE TO COMPLY WITH THE FOLLOWING INSTRUCTIONS AND WARNINGS MAY RESULT IN SERIOUS INJURIES AND/OR PROPERTY DAMAGE.

- DO NOT HANG on the rim or any part of this system, including backboard, support arm or net.
- During play, especially when performing dunk-type activities, keep player's face away from the backboard, rim and net. Serious injuries could occur if teeth/face come in contact with backboard, rim or net. All players must wear a mouth guard when performing dunk-type activities.
- Do not slide, climb or play on pole.
- During play, do not wear jewelry (rings, watches, necklaces, etc.). These objects may entangle in net.
- Keep organic material away from base of pole. Grass, litter, etc. could cause corrosion and/or deterioration.
- Check pole system for signs of corrosion (rust, pitting, chipping, etc.) and repaint with exterior enamel paint. If rust has penetrated through the steel anywhere, replace pole system immediately.
- Check system before each use for loose hardware, excessive wear, and signs of corrosion, and repair before use.
- Check system before each use for instability.
- Never allow play on damaged equipment.

THE OWNER OF THIS EQUIPMENT IS RESPONSIBLE TO ENSURE THAT ALL INDIVIDUALS FOLLOW THESE SAFETY AND OPERATING INSTRUCTIONS TO AVOID INJURIES OR PROPERTY DAMAGE. PROPER USE AND SUPERVISION OF THIS EQUIPMENT IS ESSENTIAL TO HELP REDUCE THE POSSIBILITY OF ACCIDENTS OR INJURIES.



## WARNING

READ ALL INSTRUCTIONS THOROUGHLY BEFORE ATTEMPTING TO INSTALL THIS EQUIPMENT. INSTALLATION / ASSEMBLY OF THIS EQUIPMENT MUST BE DONE **ONLY BY ADULTS**, WHO ARE PHYSICALLY CAPABLE OF DOING SO.

### PARTS LIST

Item No.	Part No.	00195-580 Quantity	00195-582 Quantity	Description
1	207	1	2	Perforated Steel Backboard
2	00251H00	1	2	Heavy-Duty Goal
3	FRME 00375	1	2	Extension Arm Weldment
4	FRME 00349 002	1	1	Upright
5	PLTE 00250 002	1	0	Back-Up Plate
6	HDWE 02013 0E0	4	8	3/8" x 1-1/4" Lg. Carriage Bolt (Grade 5)
7	HDWE 04002 0E0	6	12	3/8" Lockwasher
8	HDWE 03002 0E0	6	12	3/8" Hex Nut
9	HDWE 01199 0P0	6	6	5/8" x 8" Lg. Hex Head Cap Screw (Grade 5)
10	HDWE 04006 0E0	6	6	5/8" Lockwasher
11	HDWE 03069 0E0	6	6	5/8" Nylock Hex Nut
13	HDWE 58140 0E0	2	4	3/8" x 1-1/16" Lg. Drive Rivet
14	FLAT 00084	1	2	Extension Arm Weldment Adapter Plate
15	HDWE 01207 0E0	2	4	3/8" x 2-1/4" Lg. Hex Head Cap Screw (Grade 5)
16	HDWE 05004 0E0	6	12	3/8" Flatwasher

1. Check all items against Parts List on Page 2 to ensure that all parts and hardware are available to complete the installation.

## INSTALL UPRIGHT

2. Locate center position of upright. **CAUTION** – Contact your local utility companies to locate buried electrical, gas, water lines, etc. BEFORE DIGGING HOLE FOR FOOTING. Also, check for overhead utilities.
3. Dig a footing 3'-0" square by 4'-3" deep, centered on the final location of the upright. See Detail "A". Note – Footing size may have to be increased depending on soil conditions.
4. Using at least two adults, tip the bottom (open) end of the upright into the footing hole, and raise it to the vertical position. Place a brick or block in the bottom of the hole for the upright to rest on.
5. **IMPORTANT** – Note that upright has a hole near the top end. This hole must be located on the side of the upright that will be behind the mounting plate of the extension arm (or the back-up plate). Rotate the upright as required to ensure the proper location.
6. Center the upright in the hole, and brace as required to support it while the concrete sets up. Note – The top of the upright must be located 8'-6" above the playing surface. See Detail "A".
7. Create a cage of reinforcing rods (by installer, not provided by Porter) approximately 24" square by 36" tall, in the concrete footing. See Detail "A".

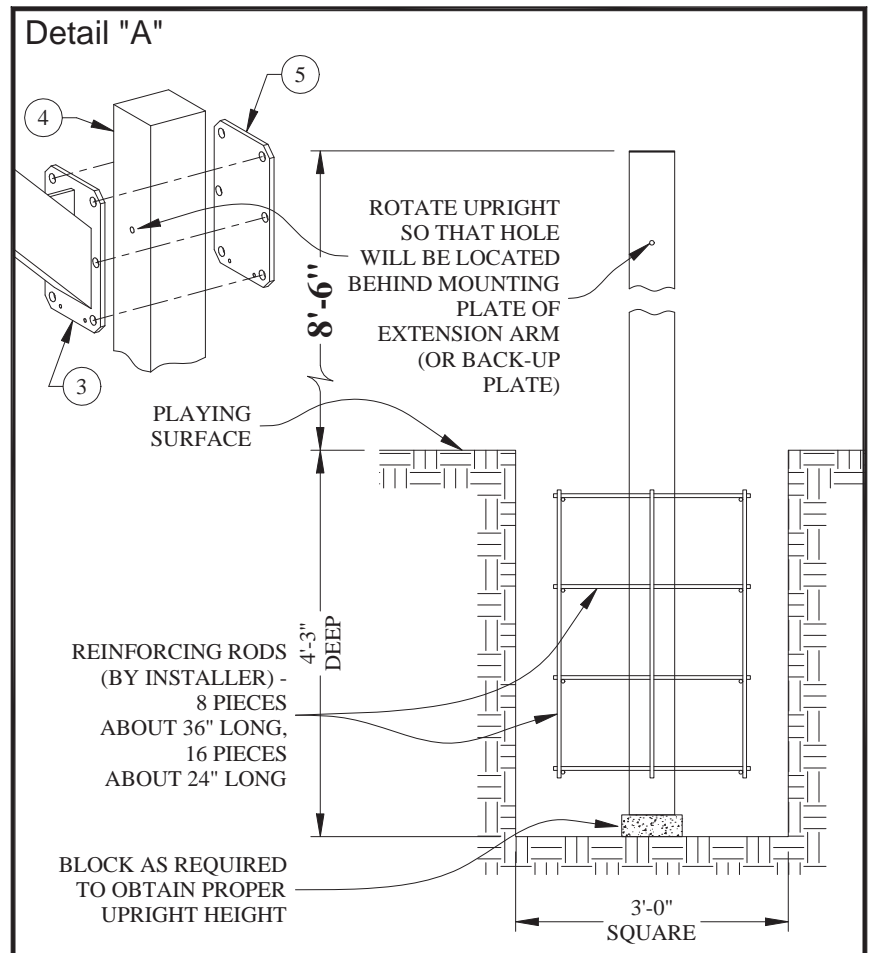

8. Pour concrete into footing hole (approximately 39 cubic feet, 1.4 cubic yards), tamping as it is poured, to eliminate air pockets. Slope top of footing upward toward upright so that top of footing at upright is approximately 1/2" above playing surface. See Detail "B". This will ensure proper drainage, reducing the possibility of corrosion of the steel upright. Do not cover the footing with dirt, sod or anything else that could hold moisture.
9. While concrete is still wet, use a level on two sides of the upright to ensure it is plumb.
10. Allow concrete to cure at least 24 hours before proceeding.

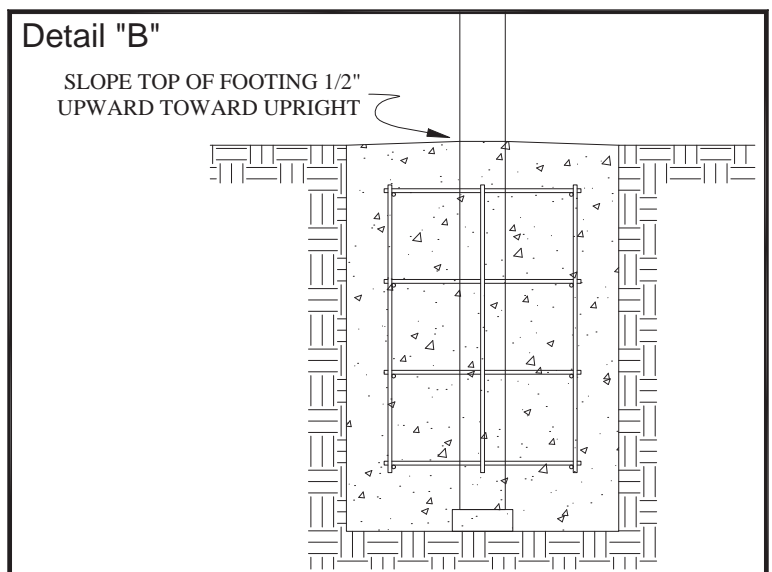

## ASSEMBLE EXTENSION ARM(S) TO UPRIGHT

- 11.** Assemble adapter plate to extension arm weldment using four  $\frac{3}{8}$ " x  $1\frac{1}{4}$ " lg. carriage bolts, flatwashers, lockwashers, and hex nuts as shown in Detail "C". Note orientation of the adapter plate before installing.

Detail "C"

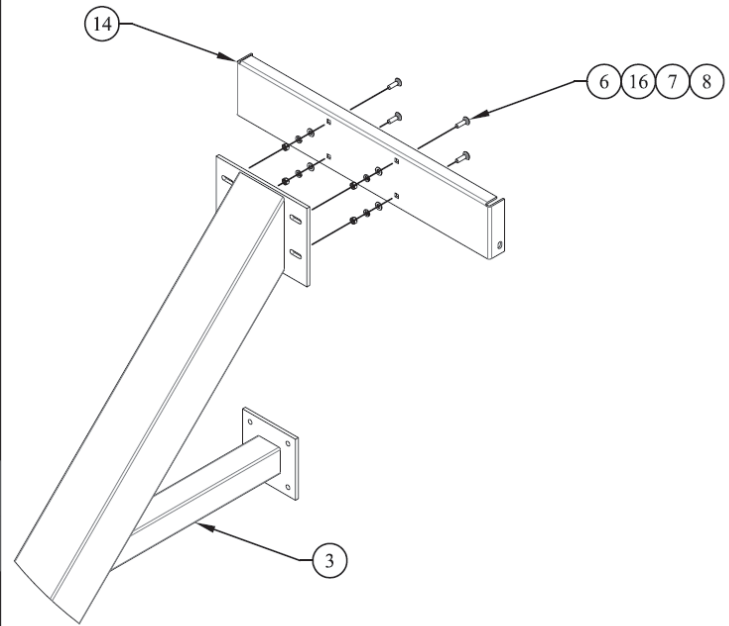

- 12.** This step requires three adults. Assemble extension arm(s) to upright, using six  $\frac{5}{8}$ " x 8" lg. hex head cap screws, lockwashers and hex nuts. Locate the bottom mounting holes on the extension arm at 6' 11- $\frac{1}{4}$ " above playing surface. This will locate extension arm at proper height, ensuring a 10'-0" goal height after assembly is completed.

See Detail "D" for illustration of No. 00195-580 single extension arm. Locate back-up plate (5) on side of upright opposite extension arm.

Detail "D"

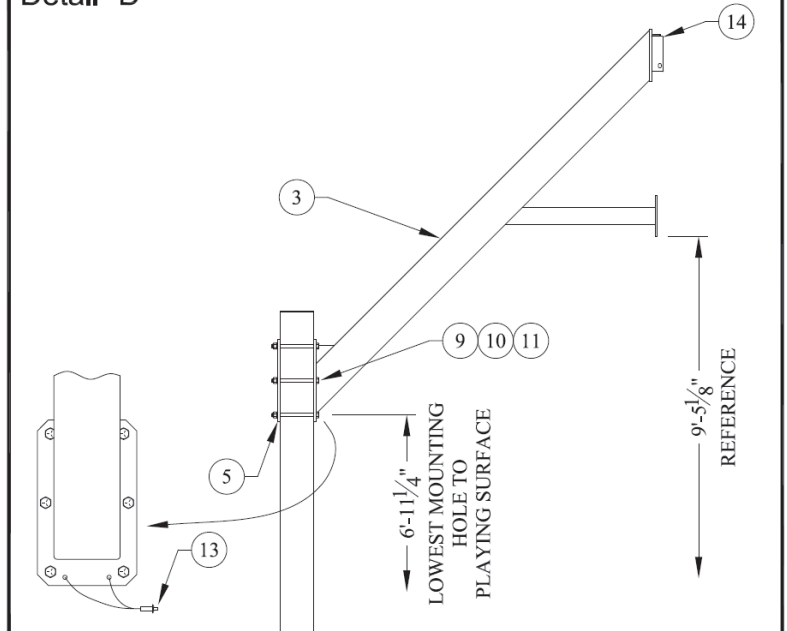

See Detail "E" for illustration of No. 00195-582 double extension arm. Six hex head cap screws secure both extension arms to upright simultaneously.

13. Extension arm(s) must be secured to upright with drive rivets (13). After extension arm is mounted to upright at proper height above playing surface with 5/8" hardware, locate two 3/8" diameter holes at bottom end of extension arm mounting plate. Drill a 3/8" diameter hole through both of these holes, into the upright. Install a drive rivet into each of these drilled holes. This will prevent the extension arm from sliding down along the upright.

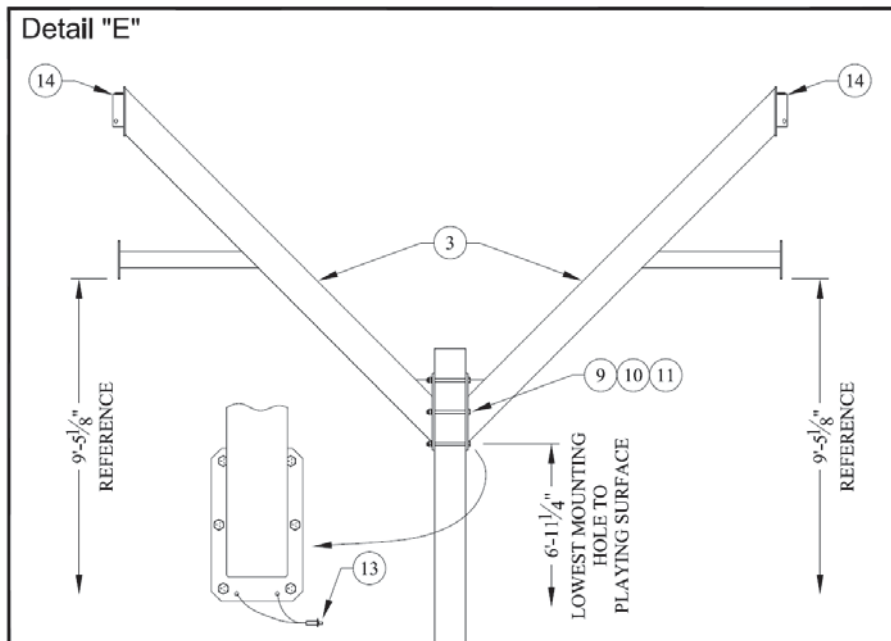

## ASSEMBLE BACKBOARD AND GOAL

14. Backboard is secured to extension arm adapter first, using two 3/8" x 2-1/4" lg. hex head cap screws, flatwashers, lockwashers and hex nuts. Hand-tighten these bolts. See Detail "F".

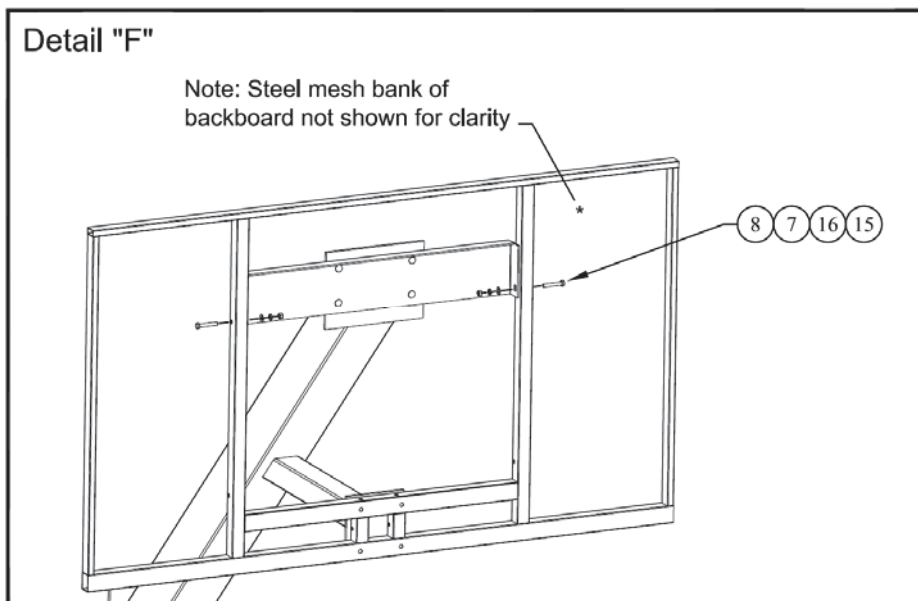

**15.** Goal is secured using the mounting hardware supplied with the goal. This hardware is installed through the goal, the backboard, and the lower plate on the extension arm. Fully tighten this hardware, and the hardware from Step No. 14. See Detail "G".

**16.** Assembly of backstop is now complete. Install optional upright and/or backboard padding as required.

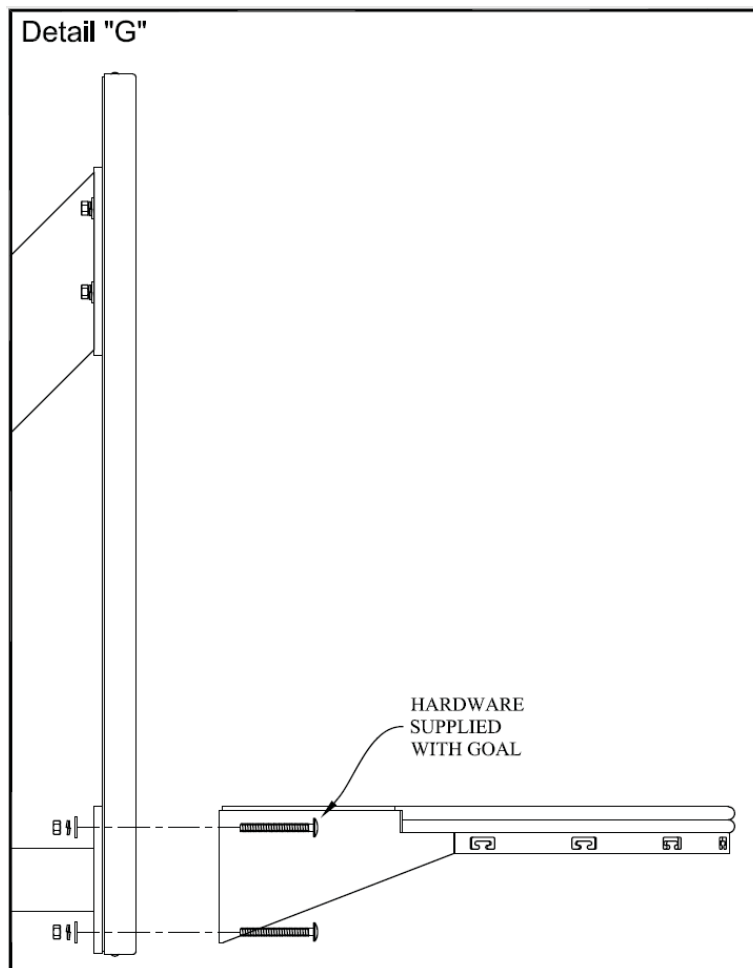

**⚠ WARNING:** This product can expose you to Titanium Dioxide, which is known to the State of California to cause cancer. For more information go to [www.p65warnings.ca.gov](http://www.p65warnings.ca.gov).

**porter**

**Porter Athletic Equipment Company**  
601 Mercury Drive, Champaign, IL U.S.A., 61822  
Toll Free: (888) 277-7778 • Fax: (217) 239-2255  
[www.porterathletic.com](http://www.porterathletic.com)

**SAVE THESE INSTRUCTIONS FOR FUTURE USE**