

TOOLS: Hammer, Tape Measure, Phillips Screwdriver,
7/16" Wrench, 1/2" Wrench, 9/16" Wrench X2

1. Check all parts against parts list to ensure that all parts and hardware are available to complete the installation.

ITEM NO.	PART NUMBER	DESCRIPTION	QTY.
1	FRME00152001	Ladder Side Frame - Left Hand	1
2	FRME00153001	Ladder Side Frame - Right Hand	1
3	PCAP00009000	End Cap	2
4	FEET000340E0	Threaded Insert - 5/16"	2
5	FEET00038000	Rubber Bumper	2
6	HDWE012430E0	5/16"-18 x 1" hex bolt, plated	2
7	HDWE050030E0	1/4" Flat Washer	2
8	CSTR00021000	3" Caster	2
9	HDWE060550E0	1/4" x 1-3/4" Lg. Round Hd Screw	4
10	FRME00790	Ladder Frame Clamp	1
11	UBOT00028	U-Bolt 5/16"-18 for 1-3/8" OD	4
12	FRME00791	Upright Clamp	2
13	HDWE030340E0	Lock Nut- 1/4-20	4
14	HDWE030150E0	Locking Type Cap Nut- 5/16-18	8
15	HDWE050020E0	5/16 - Flatwasher	8
16	HDWE011960E0	3/8-16 X 3/4 Lg. Hex HD Cap Screw	4
17	HDWE050040E0	3/8" Flat Washer	8
18	TUBR00550001	Ladder Rung	3
19	HDWE020410E0	Carriage Bolt- 3/8-16 X1-3/4	6
20	HDWE030050E0	Acorn Nut 3/8-16 Locking	10
21	WOOD0010610B	Wood Platform	1
22	HDWE061190E0	#14 x 5/8" Lg. Sheet Metal Screw	6
23	HAND00091	Judges Stand Handle	1

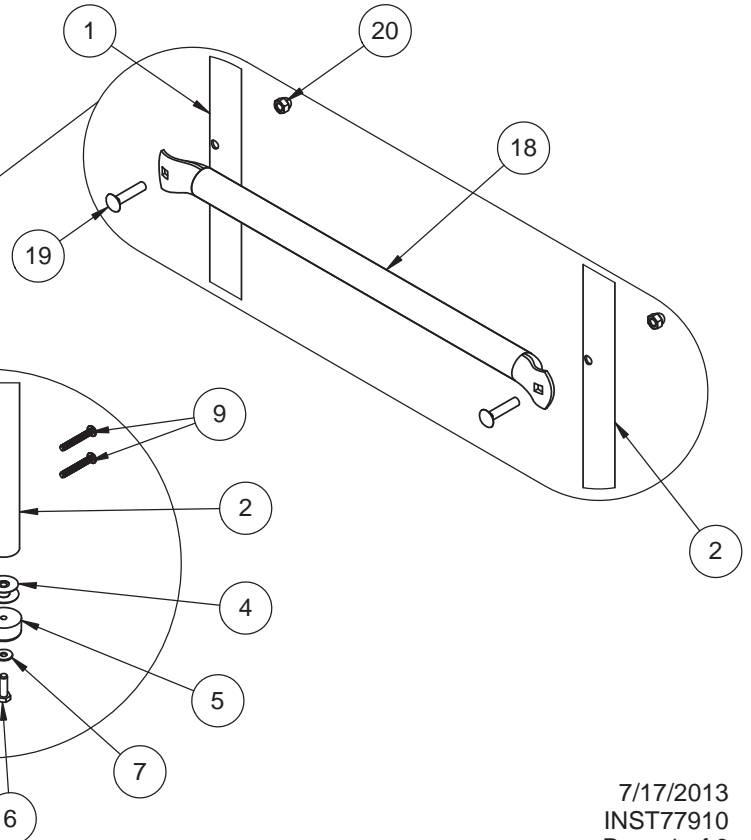
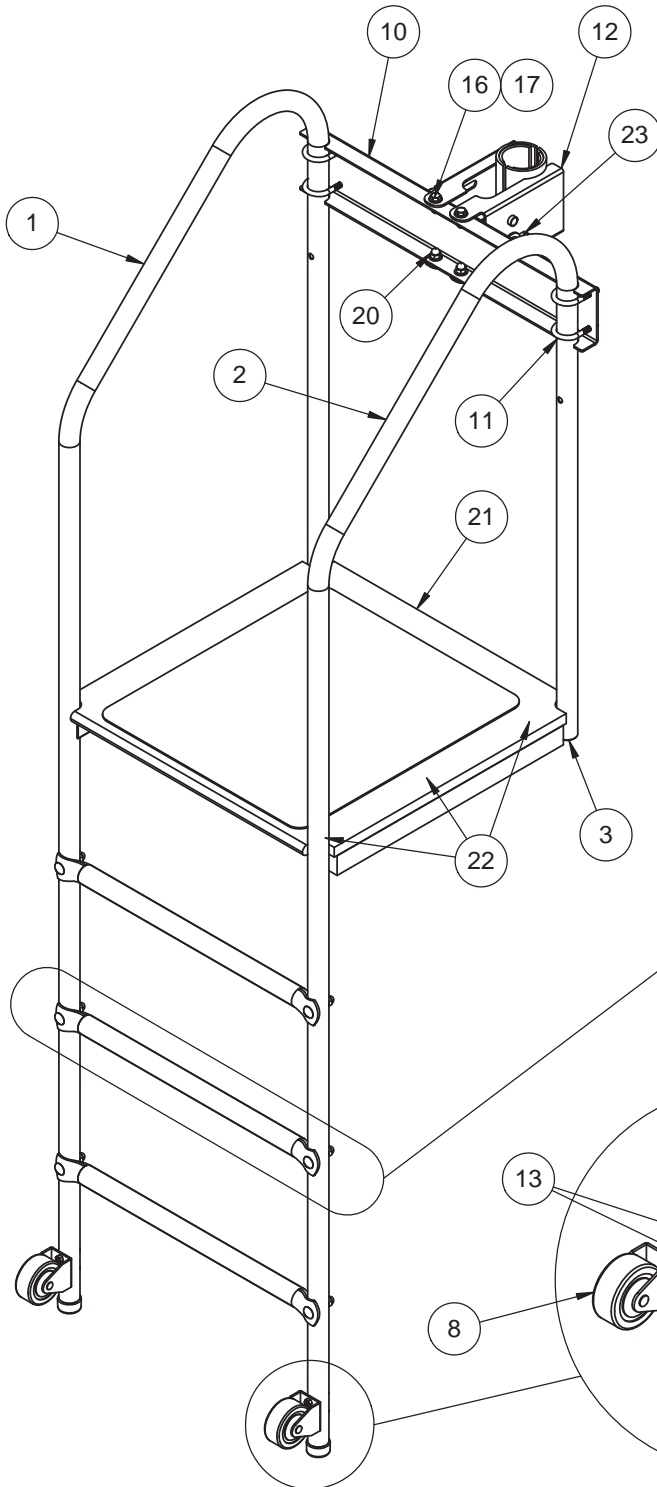

2. Assemble plug end cap (3) into ends of each ladder side frame (1 & 2)

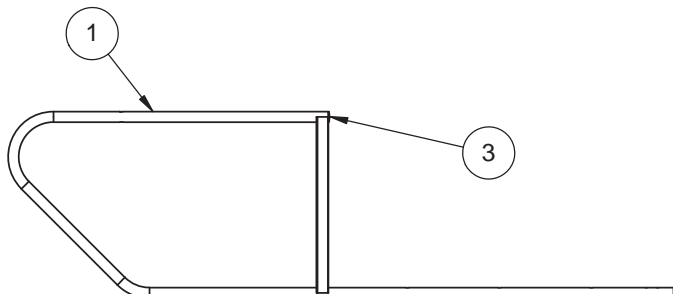

3. Hammer 5/16" threaded inserts (4) into lower end of each ladder side frame (1 & 2). Secure rubber feet (5) to threaded inserts (4) with 5/16" x 1" lg. hex head cap screw (6) and 1/4" flat washer (7).

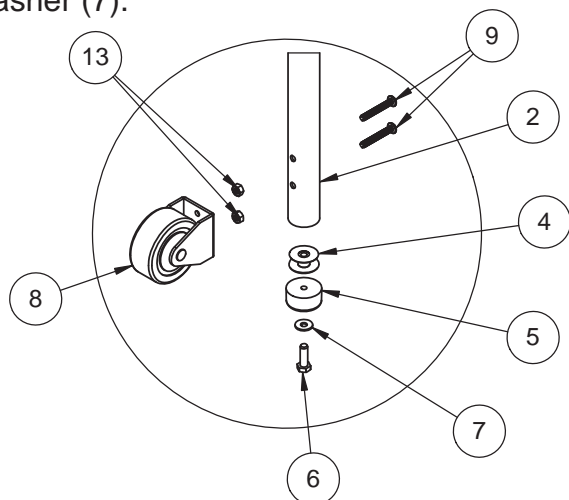

4. Attach 3" caster (8) to each ladder side frame (1 and 2) with two 1/4" x 1-3/4" lg. round head machine screws (9) and 1/4" locknuts (13).

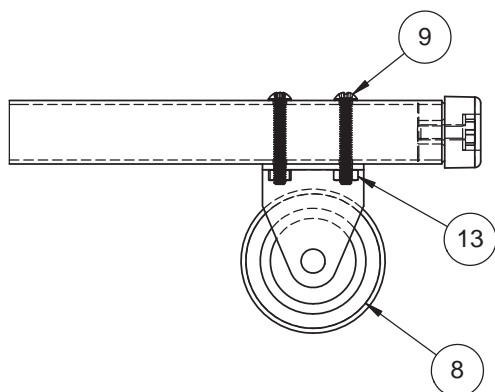

5. Secure ladder side frames (1 & 2) with the ladder frame clamp (10), U-bolts (11), 5/16" flat washers (15) and 5/16" cap nuts (14). Ladder frame clamp (10) should be installed directly below the curve in the side frames (1 & 2), see below for dimensions.

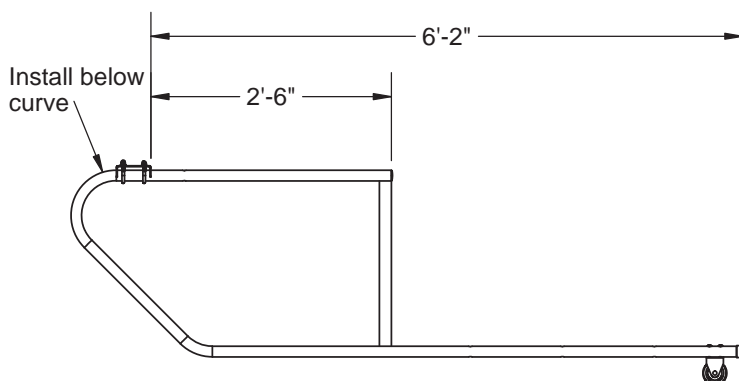
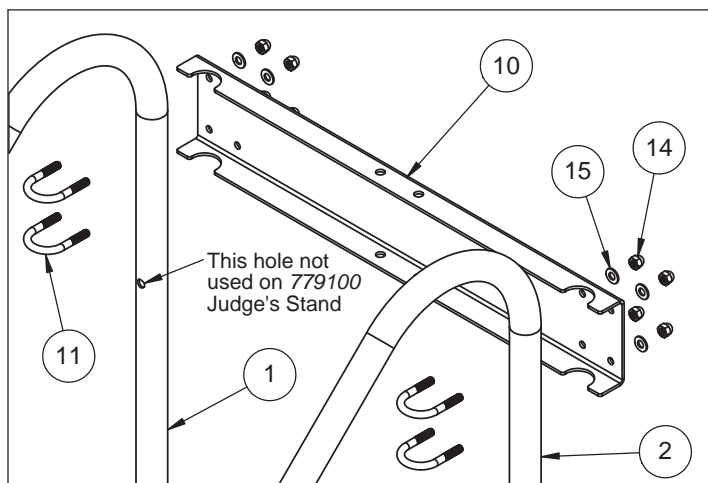

6. Secure ladder rungs (18) to the outside of the ladder side frames (1 & 2) with 3/8" x 1-3/4" lg. carriage bolts (19) and 3/8" locking cap nuts (20). Do not tighten hardware at this time.

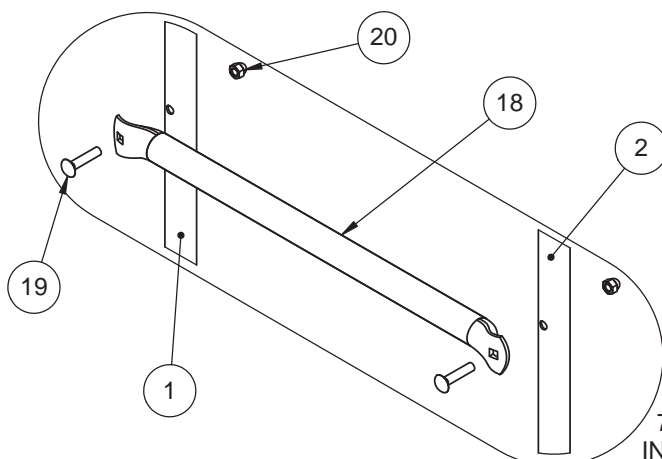

7. Lay wood platform (21) in position with rounded edge facing outward, toward the ladder side of the unit. Secure wood platform (21) to the support angles on the ladder side frames (1 & 2) with six #14 x 5/8" lg. sheet metal screws (22).

Note – screws are routed thru the pre-drilled holes in the ladder side frames and into the wood platform. Tighten **all** hardware at this time.

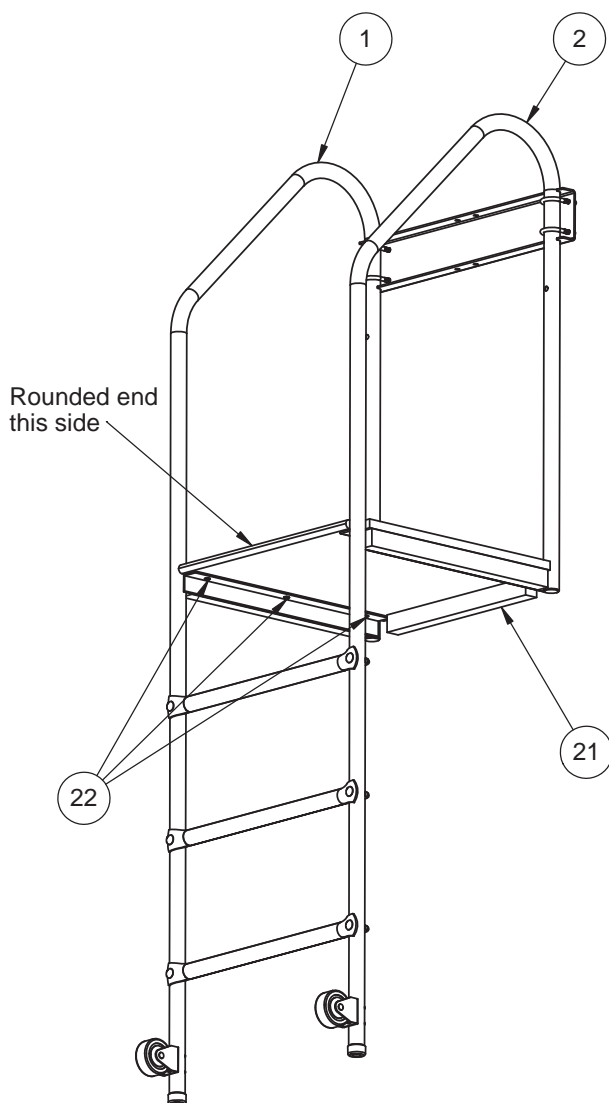

8. Attach upright clamps (12) to ladder frame clamp (10) with 3/8" x 3/4" lg. hex head cap screw (16), 3/8" flat washers (17), and 3/8" cap nut (20).

Note – Do not overtighten. Clamps should swing open and closed freely

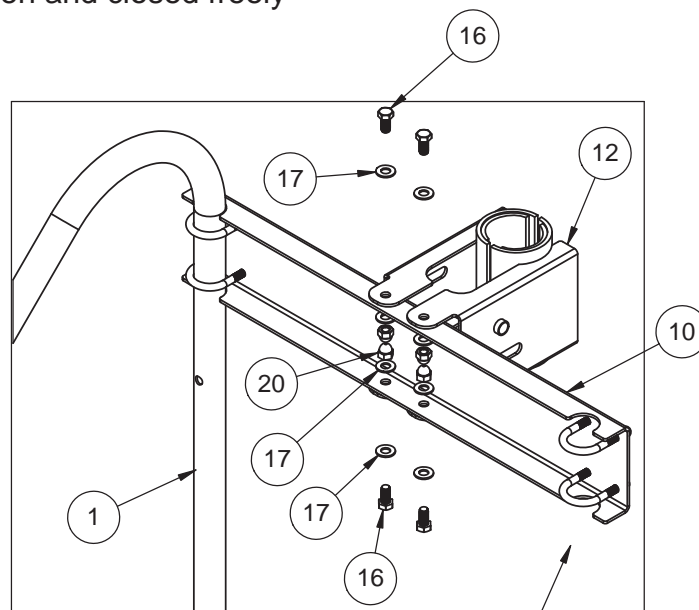

Upright side frame (2) not shown for clarity

9. Remove the lock nut from the handle (23) and insert handle through the slot of the upright clamp (12). Thread handle through the weld nut of the other upright clamp (12). Tighten the lock nut on the end of handle to keep handle from backing out.

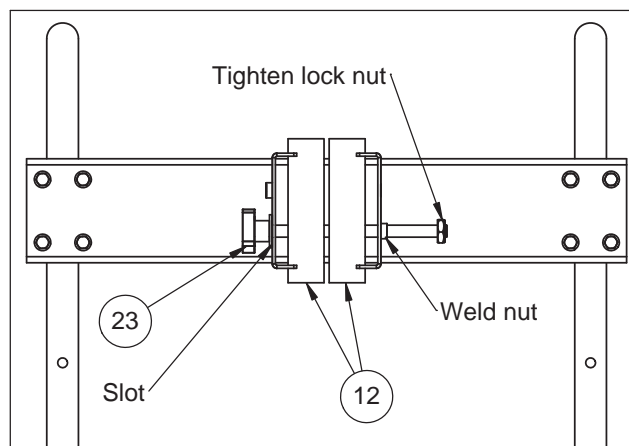

SET OF PROTECTIVE PADS FOR JUDGE'S STANDS NO. 7731xx

1. Check all items against Parts List to ensure all have been included.

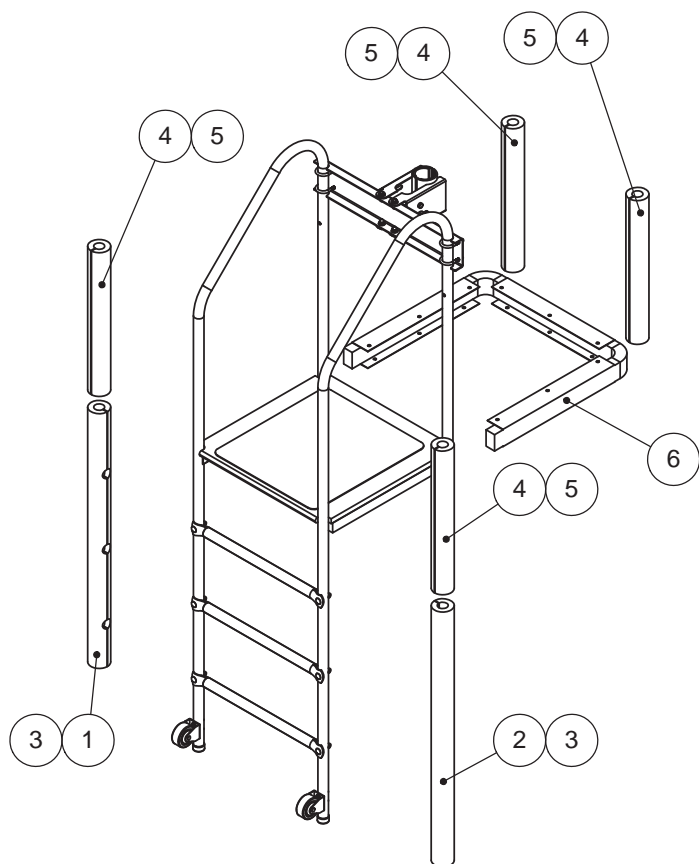

Item #	DESCRIPTION	QTY
1	LADDER PAD COVER - LEFT HAND	1
2	LADDER PAD COVER - RIGHT HAND	1
3	LADDER PAD FOAM	2
4	RAILING PAD COVER	4
5	RAILING PAD FOAM	4
6	PLATFORM PAD	1
7	SHEET METAL SCREW #12 X3/4	18

2. Install platform pad (6) onto wood platform of judge's stand, using eighteen #12 x 3/4" lg. screws (7) thru grommets on upper and lower flaps of pad. Pilot holes in wood platform are not required.

Begin with center section of platform pad, making sure it is centered left-to-right, and snug against platform. After center section is secured with six screws, attach end sections one at-a-time, by bending them 90 degrees around the railing. Snug each end section against the platform, and secure each end section with six screws. See detail "A".

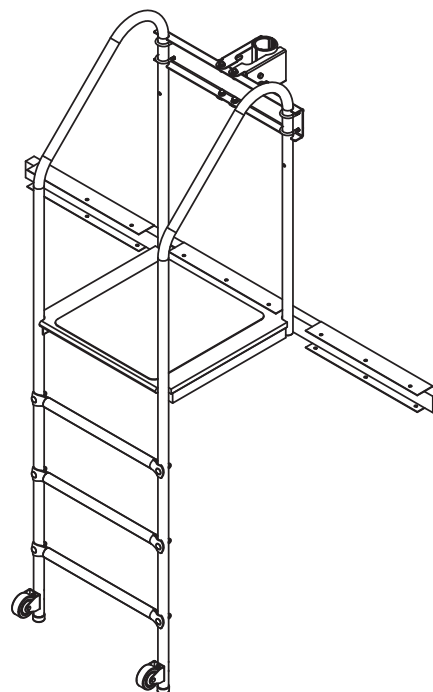

Detail "A"

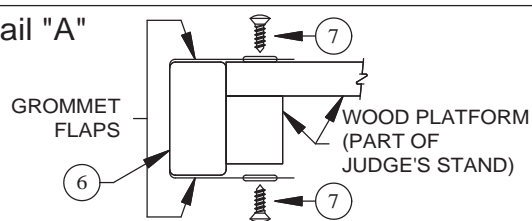

SET OF PROTECTIVE PADS FOR JUDGE'S STANDS NO. 7731xx

3. Install railing pad foam (5) and railing pad cover (4) onto all four railings.

Cover secures by means of overlapping Velcro attachment flaps. See detail "B".

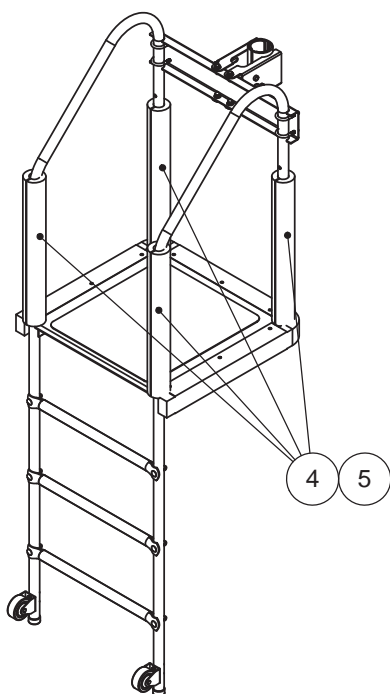

4. Install ladder pad foam (3) and ladder pad covers (1 & 2).

Cover secures by means of overlapping Velcro attachment flaps. See detail "B".

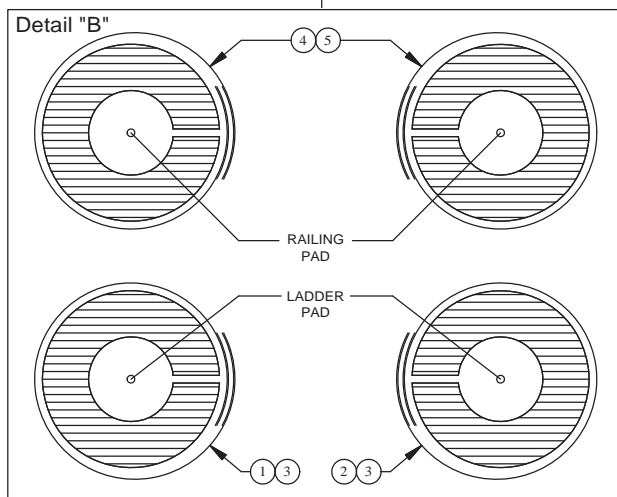
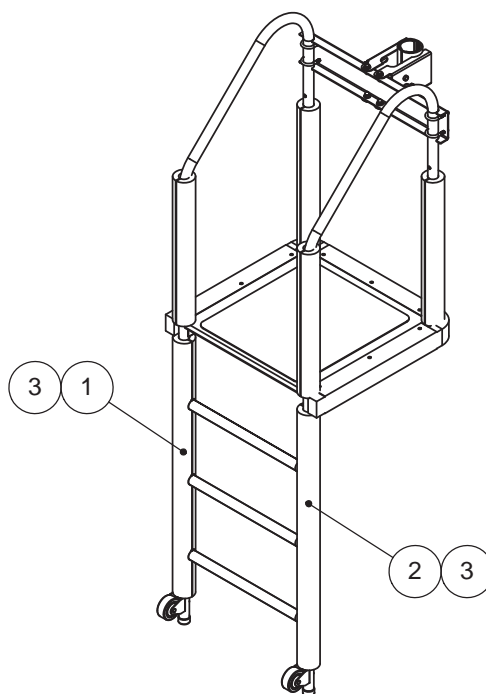



www.porterathletic.com
888-277-7778

7731xx PAD SET
INST77910

WARNING

- THIS JUDGE'S STAND MUST BE USED WITH NO. 773100 PROTECTIVE PADDING SET, TO REDUCE THE POSSIBILITY OF PLAYER INJURY, AND TO COMPLY WITH ALL STANDARDS FOR COMPETITION.
- INSPECT THIS UNIT BEFORE EACH USE FOR ANY LOOSE OR MISSING BOLTS OR PARTS. CLAMPS SHOULD ALSO BE INSPECTED FOR SHIFTING.
- DO NOT USE THIS EQUIPMENT IF ANY HARDWARE IS LOOSE OR MISSING, OR STRUCTURAL FATIGUE OR POSSIBLE EQUIPMENT FAILURE IS EVIDENT. ORDER REPLACEMENT PARTS IMMEDIATELY. DO NOT ALLOW ANYONE TO USE THIS EQUIPMENT BEFORE MAKING REPAIRS, TO AVOID POSSIBLE INJURIES OR PROPERTY DAMAGE.
- ONLY QUALIFIED PERSONNEL SHOULD DETACH, MOVE, OR ATTACH THE STAND.
- BEFORE USE, PLATFORM MUST BE LEVEL AND CLAMPS MUST BE TIGHTENED DOWN COMPLETELY.

 **WARNING:** This product can expose you to Wood Dust, which is known to the State of California to cause cancer. For more information go to www.p65warnings.ca.gov.

c