

Note: Installation should be done with the board face down on a clean, sturdy surface. Do not remove backing from adhesive strips until fit is verified and it is time to install the individual segments.

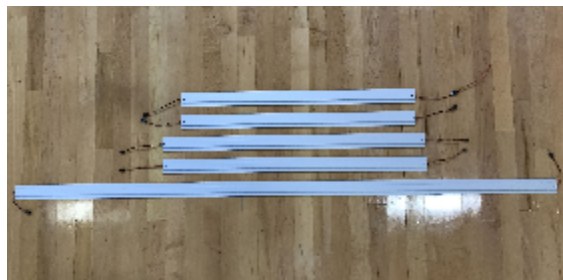

1. Remove the LED segments from packaging and identify the segment lengths. Nominal length of segments included are:

- 29" (2 pieces)
- 32" (2 pieces)
- 66" (1 piece)

2. Verify operation of all LED segments by temporarily plugging segments together and connecting to shot clock or synchronizer. Ensure that each individual LED illuminates.

3. Test fit the LED segments on the back of the glass. They should be positioned just inside the perimeter striping.

4. Clean the back face of glass thoroughly. Allow glass to dry completely.

5. Remove protective backing from the adhesive strips. Carefully apply top two LED segments to back of glass. After application, use firm pressure along entire length of extrusion to ensure proper adhesion to glass.

6. Repeat step 5 to apply the sides and then the bottom LED segments to the bank. Refer to Detail "A" for corner assembly. Refer to Detail "B" for connection example.

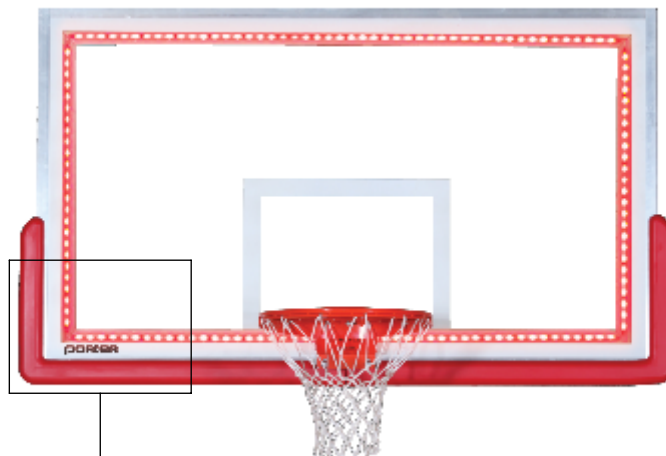

Detail A: Side strips should fit inside top and bottom strips.



Detail B: Connect male and female connectors at each corner.

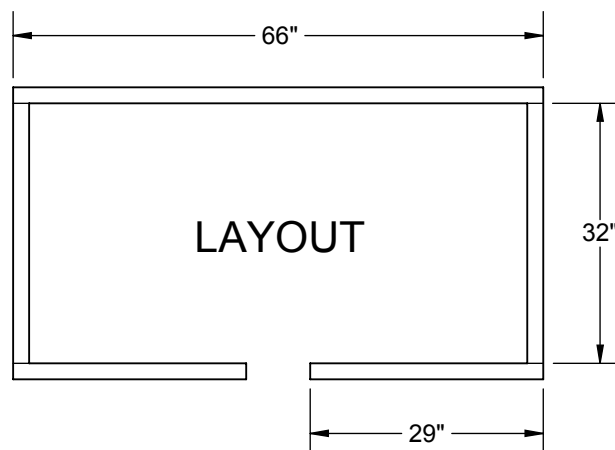

WARNING: Cancer and Reproductive Harm –
For more information go to www.p65warnings.ca.gov