

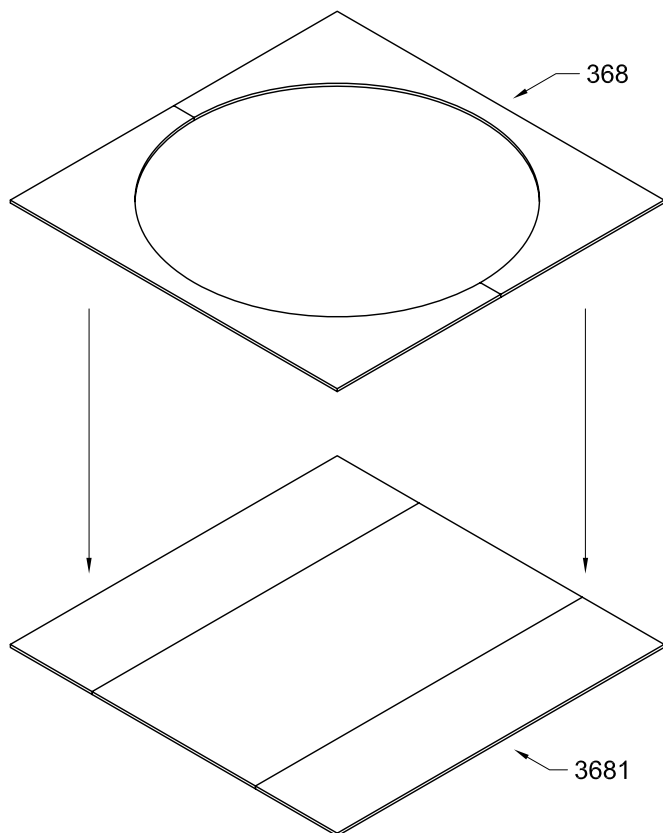

www.gillathletics.com
800-637-3090

3681 THROWING SURFACE for 368 ASSEMBLY INSTRUCTIONS



Parts:

- (1) $\frac{3}{4}$ " Birch Plywood, 48" x 96"
- (2) $\frac{3}{4}$ " Birch Plywood, 24" x 96"
- (84) $1\frac{1}{4}$ " Exterior Screws
- (48) #6 x $\frac{1}{2}$ " Rnd Head Wood Screws
- (6) Mending Plate, 3" x 5"

Tools required:

- (1) Drill/Driver
- (1) Speed Square
- (1) Tape measure

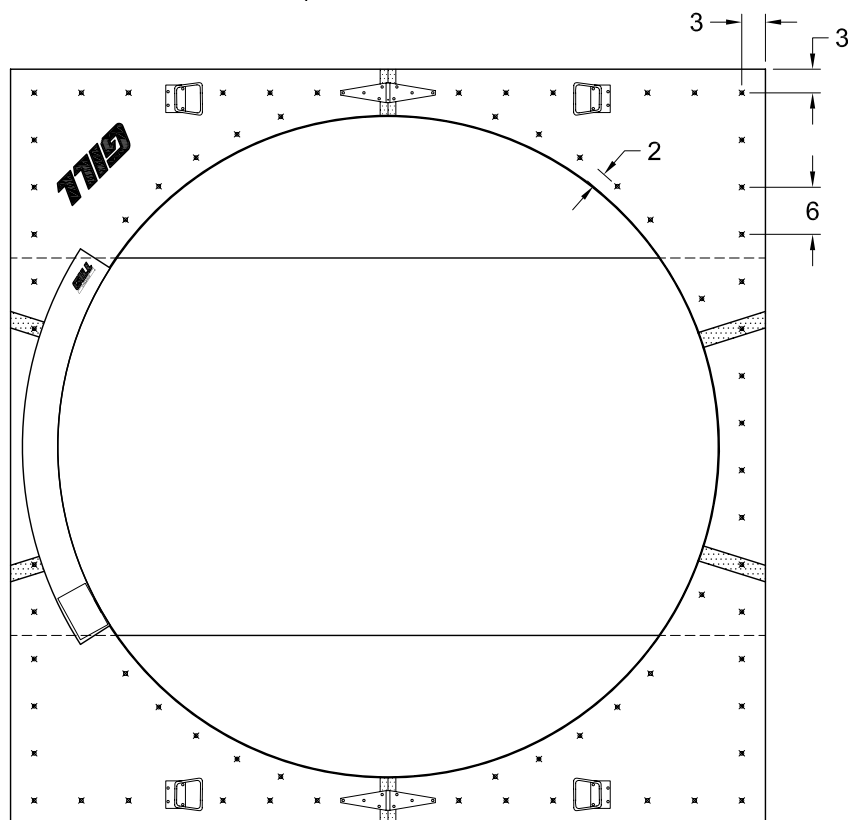
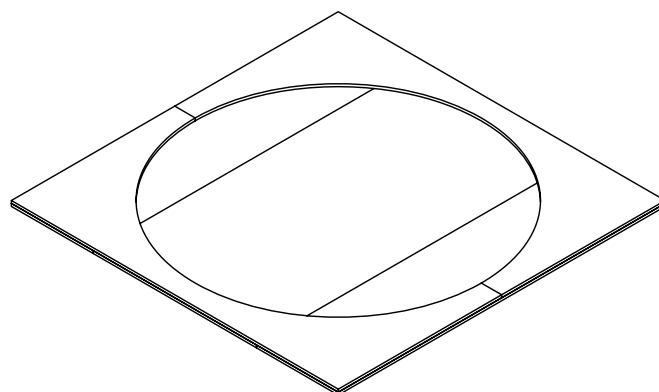

Lay the two 24" x 96" pieces of $\frac{3}{4}$ " birch plywood on opposite sides of the 48" x 96" piece of $\frac{3}{4}$ " birch plywood, as shown.

Place the 368 Throwing Circle on the 3681 Throwing Surface such that the fold in the 368 is perpendicular to the seams in the 3681, as shown.

Ensure the outside edges of the 368 and 3681 are flush.

Using a speed square and tape measure, drill $\varnothing\frac{3}{32}$ " pilot holes 3" in from the outside edge every 6", as shown to the left. Drill pilot holes 2" in from the inside edge of the 368 every 6".

Secure the 368 to the 3681 using the provided $1\frac{1}{4}$ " exterior screws.



www.gillathletics.com
800-637-3090

3681 THROWING SURFACE for 368 ASSEMBLY INSTRUCTIONS

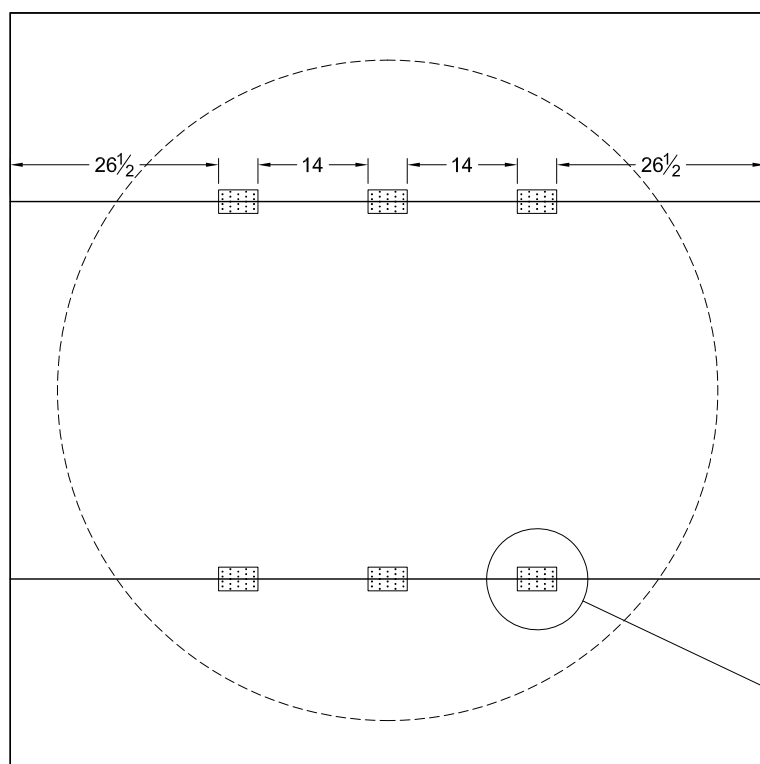
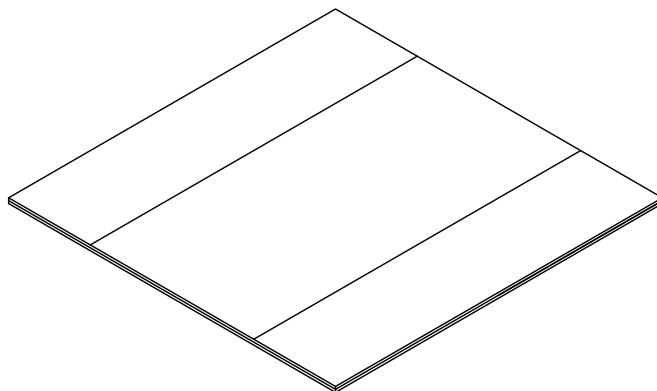
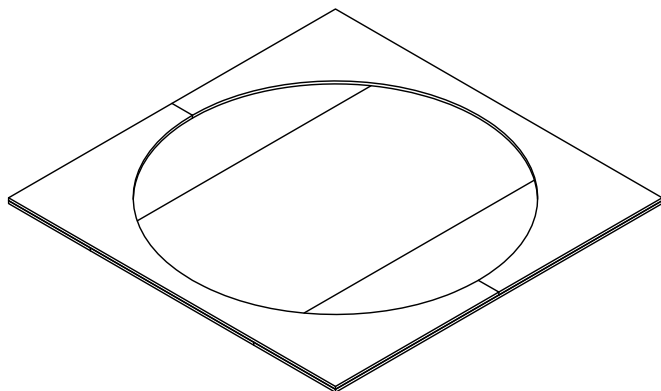

If the throwing circle is being placed on track surface, the 3 sections of the throwing surface can be further secured using the 6 mending plates and the 48 wood screws.

Carefully flip the combined 368 and 3681 over.

Bridge the seams of the throwing surface sections as shown to the left .

Secure the mending plates in place using eight #6 x 1/2" wood screws per plate. Four to each side of the seem as shown below.

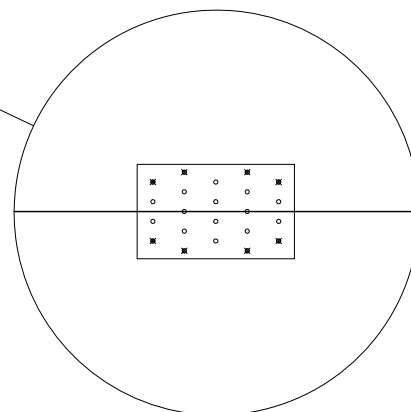

THIS WARNING IS GIVEN IN COMPLIANCE
WITH CALIFORNIA'S PROPOSITION 65:

WARNING

This product contains chemicals known to the
State of California to cause cancer, birth defects
or other reproductive harm.

Copyright ©2006 by Gill Athletics. All rights reserved.

GILL ATH
03/27/06
3681_inst2