

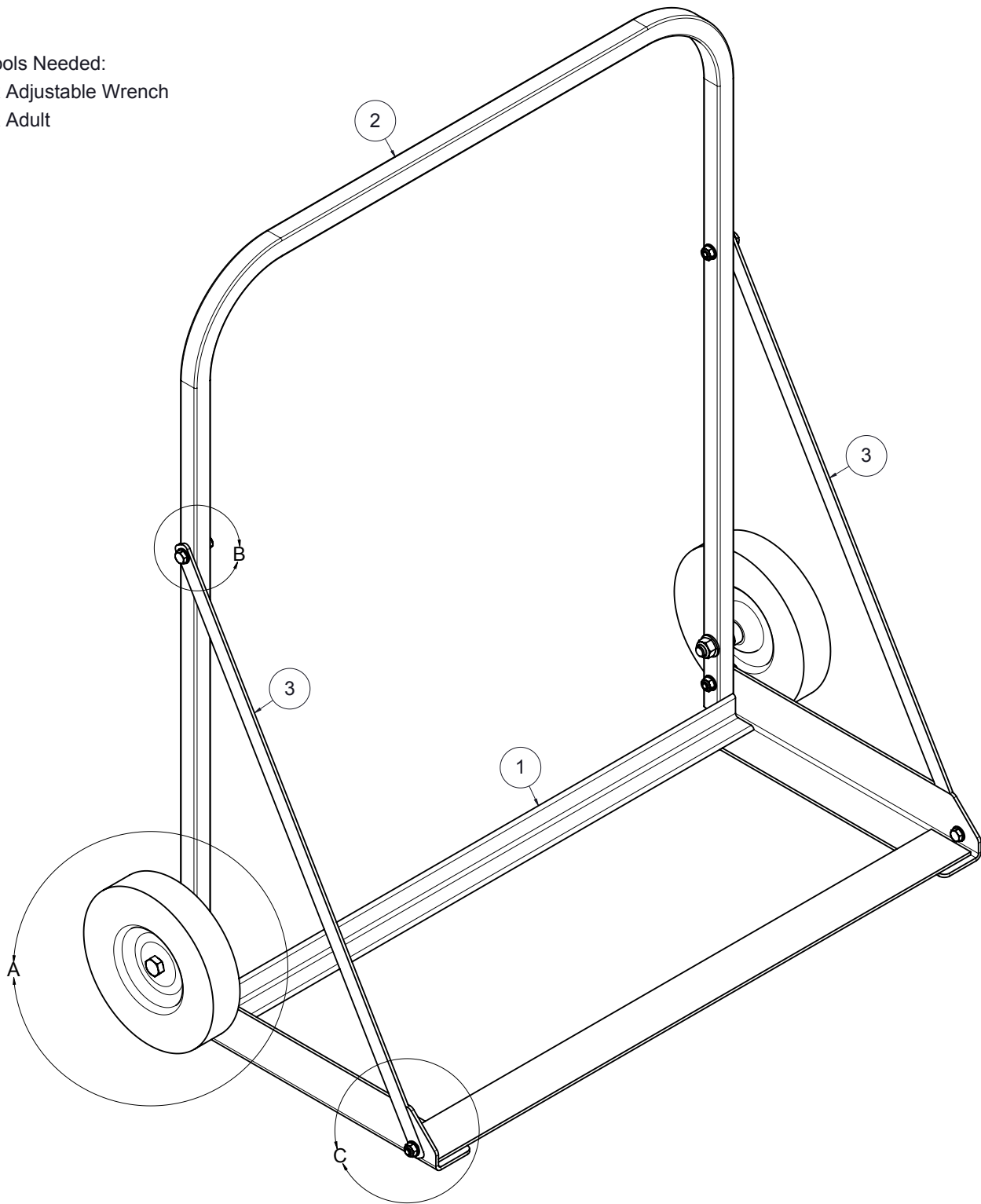

www.gillathletics.com  
800-637-3090

## 4210 - HURDLE CART ASSEMBLY INSTRUCTIONS

Tools Needed:  
2x Adjustable Wrench  
2x Adult



## 4210 - HURDLE CART ASSEMBLY INSTRUCTIONS

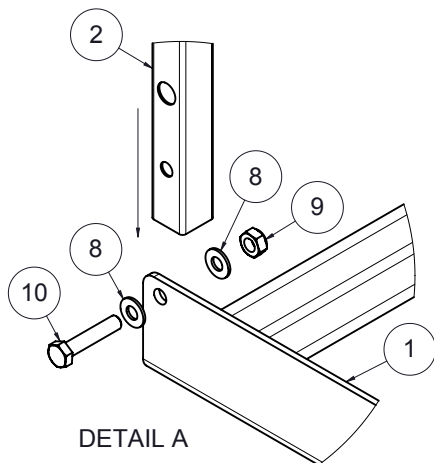

1. Fasten the handle to the base.

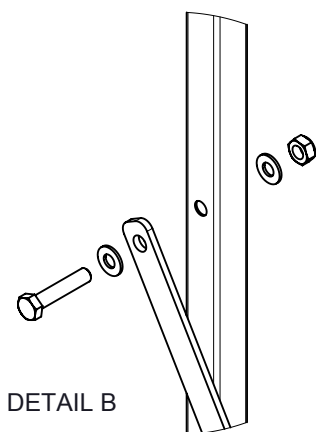

2. Fasten the brace to the handle.

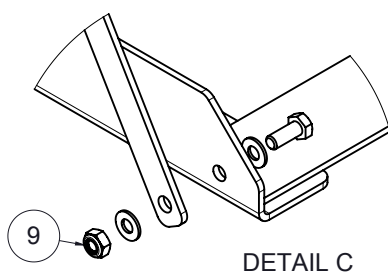

3. Fasten the brace to the base.

	DESCRIPTION	QTY
1	Hurdle Porter Base	1
2	Hurdle Porter Handle	1
3	Hurdle Porter Brace	2
4	Wheel with Solid Rubber Tread	2
5	M16 Flat Washer	2
6	M16 Nylock Hex Nut	2
7	M16 x 110mm Hex Bolt	2
8	M10 Flat Washer	12
9	M10 Nylock Hex Nut	6
10	M10 x 50mm Hex Bolt	4
11	M10 x 25mm Hex Bolt	2
12	Wheel Bushing	2
13	Wheel Spacer	2

### Replacement Parts

Part #	Description
REPL42101	Wheel Kit includes One wheel and HDWE to attach it
REPL42102	HDWE Kit includes all HDWE to assemble the frame

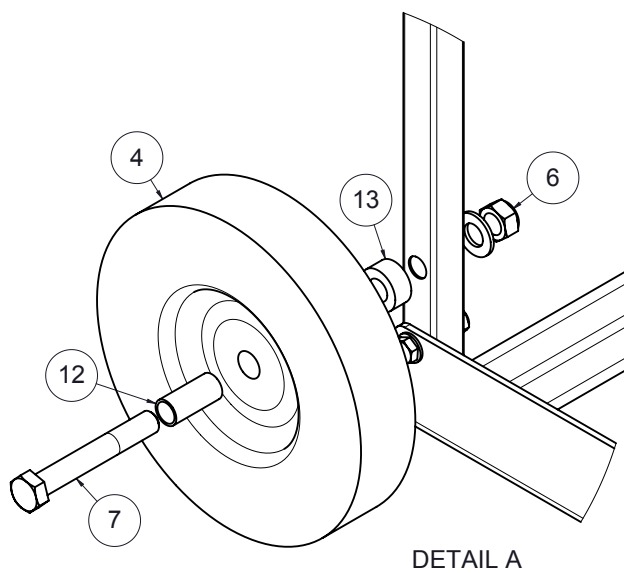

4. Fasten the wheels to the handle.