



www.gillathletics.com
800-637-3090

4010 - HURDLE CART ASSEMBLY INSTRUCTIONS

	DESCRIPTION	QTY
1	10 Hurdle Cart Base	1
2	10 Hurdle Cart Handle	1
3	Plate Mount Swivel Caster	2
4	Plate Mount Rigid Caster	2
5	M6 Flat Washer	16
6	M6 Locknut	16
7	M6 x 20mm Hex Bolt	16
8	M10 Flat Washer	8
9	M10 Nylock Hex Nut	4
10	M10 x 25mm Hex Bolt	4

Tools Needed:

2x Adjustable Wrench

2x Adults

NOTE: Attach Casters Before Handle

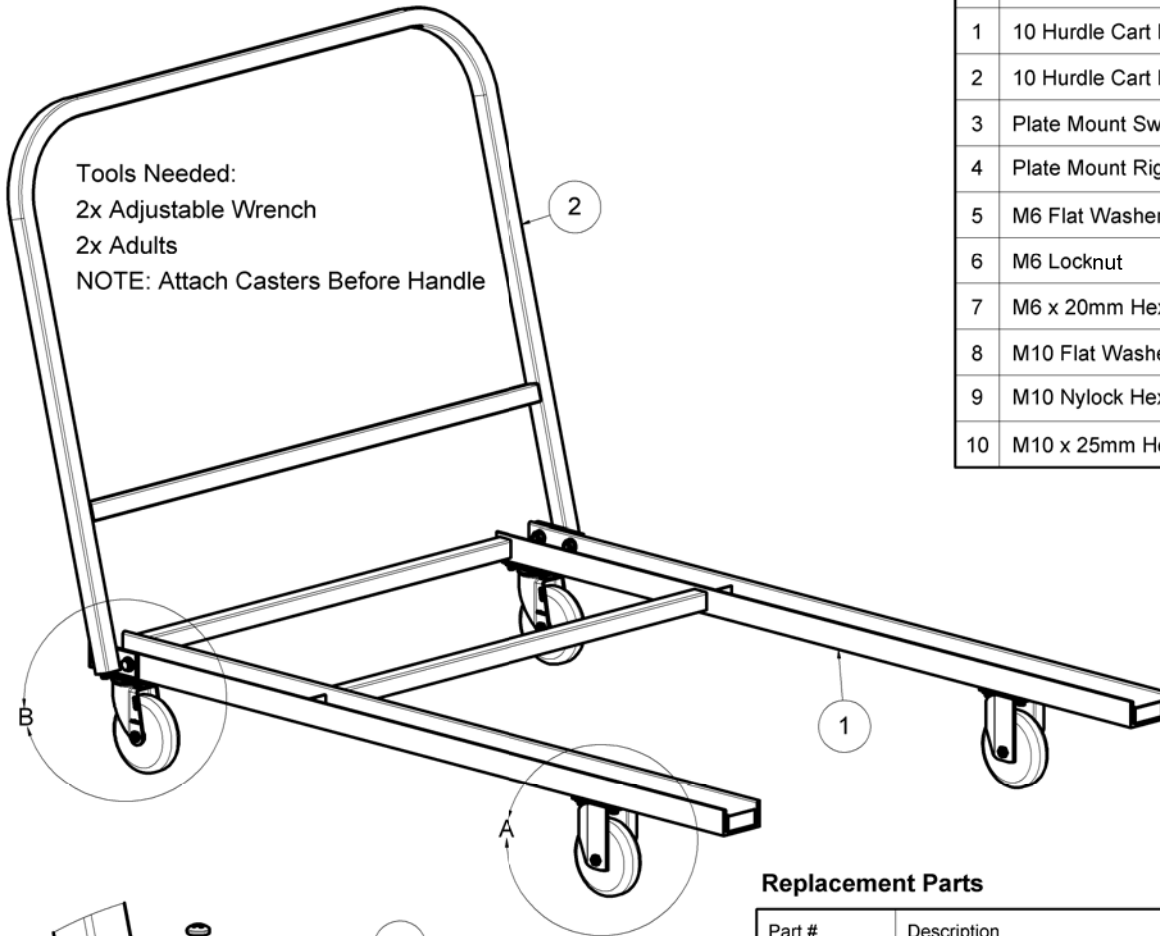

Replacement Parts

Part #	Description
REPL40101	Swivel Wheel Kit includes one wheel and the HDWE to attach it
REPL40102	Rigid Wheel Kit includes one wheel and the HDWE to attach it
REPL40103	HDWE Kit includes all the HDWE to assemble the frame

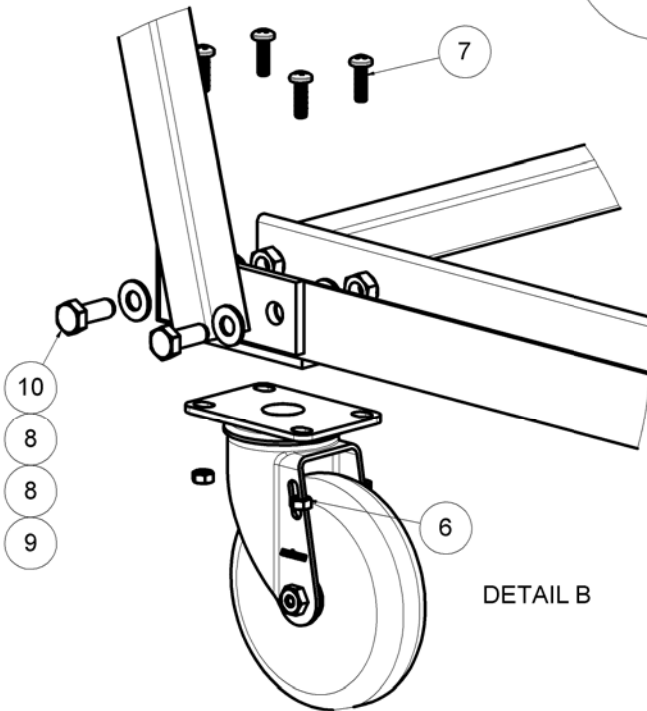

DETAIL B

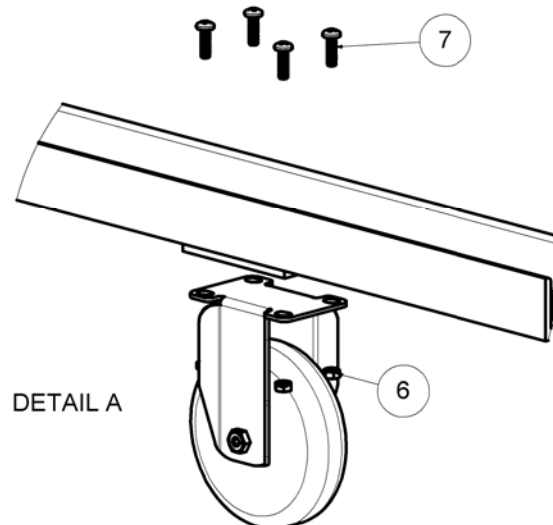

DETAIL A